

When recorded, return to:  
 TAHOE-DOUGLAS DISTRICT  
 P. O. BOX 1600  
 ZEPHYR COVE, NEVADA 89448

Recorded at Request of  
 On JAN 23 1975 At 4:5 Min. Past 12 PM  
 Official Records of Douglas County, Nevada. Fee           

*Washoe Douglas Dist*

Patricia J. Stanley, Recorder.

By [Signature]  
 Deputy

GRANT OF EASEMENT

THIS GRANT OF EASEMENT, made this 15 day of December, 1973, between the undersigned "Grantor" and the TAHOE-DOUGLAS DISTRICT, as "Grantee":

WITNESSETH, that the Grantor, for valuable consideration, receipt of which is hereby acknowledged, has granted and conveyed, and by these presents does grant and confirm into the Grantee, its successors and assigns, the easements and rights-of-way for the purpose of the installation and maintenance of sewer utility lines and necessary appurtenances in the County of Douglas, State of Nevada, and described in the attached Exhibit "A"; including the right to enter upon the property described in Exhibit "A" at any time for maintenance, repair and construction of sewer utility lines.

IN WITNESS WHEREOF, the said Grantor has hereunto set his hand and seal the day and year first above written.

GRANTOR:

GRANTOR:

[Signature: Verna Penney]  
 \_\_\_\_\_

\_\_\_\_\_  
 \_\_\_\_\_

STATE OF Nevada )  
 ) ss.  
 COUNTY OF Carson )

On this 15 day of December, 1973, before me, a Notary Public, in and for the County of WASHOE, personally appeared

Verna Penney  
 known to me to be the person(s) whose name(s) is/are subscribed to the within instrument, and she he duly acknowledged to me that she he executed the same.

IN WITNESS WHEREOF, I have hereunto set my hand and affixed my official seal the day and year in this certificate first above written.

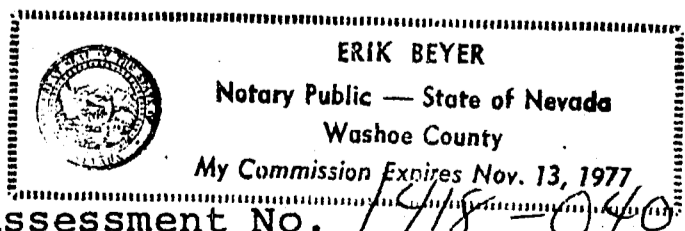

[Signature: Erik Beyer]  
 NOTARY PUBLIC

Assessment No. 1418-040-011

77602  
 BOOK 175 PAGE 629



# ENGINEERS LTD., INC.

CIVIL ENGINEERING - SURVEYING

P. O. BOX 616  
ZEPHYR COVE, NEVADA 89448  
PHONE (702) 588-4567

October 25, 1973

DESCRIPTION FOR  
TAHOE DOUGLAS DISTRICT

Sewer easement to be acquired from:

V. PENNEY

A parcel of land being a portion of Section 10, T 14 N, R 18 E, M.D.M., and of Lot 9 as shown on that certain Map entitled Glenbrook Links Tract, Official Records of Douglas County, Nevada.

An easement for constructing, maintaining and operating a sewer system on the easterly 7.5 feet of said Lot 9 of said Glenbrook Links Tract.

Also a 10 foot wide temporary working easement lying westerly and immediately adjacent to the above described utility easement.

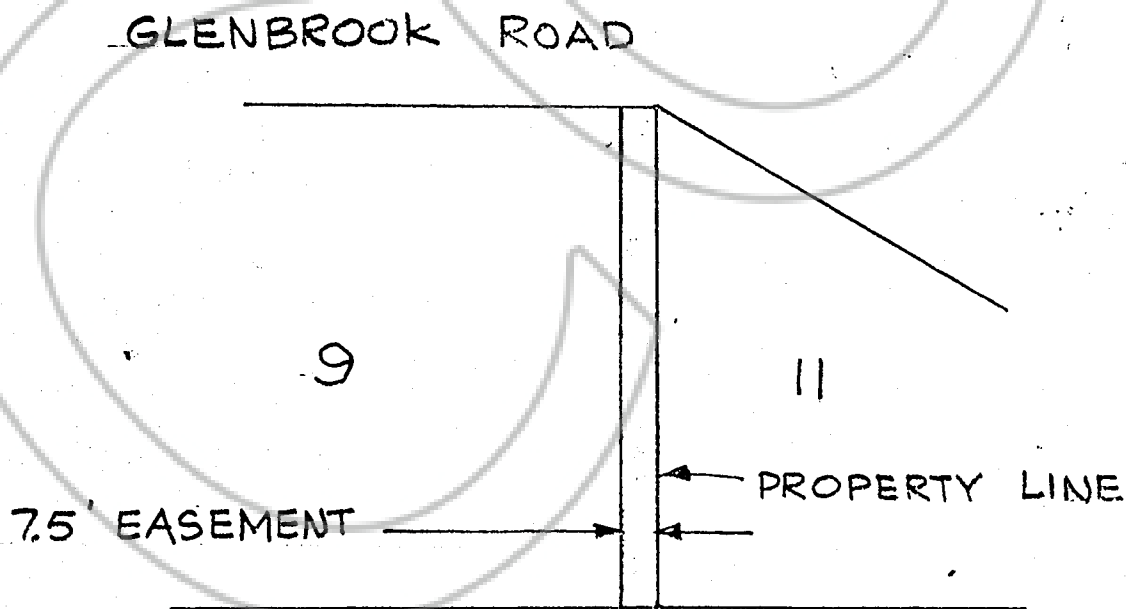

1418-040-011

*Exhibit 11A*

77602  
BOOK 175 PAGE 630  
J4