

TAHOE-DOUGLAS DISTRICT
P.O. Box 1600
Zephyr Cove, Nevada 89448

Recorded at Request of Tahoe Do. Dist
On JAN 23 1975 At 15 Min. Past 4 M
Official Records of Douglas County, Nevada. Fee

Patricia J. Stanley, Recorder
GRANT OF EASEMENT

By [Signature]
[Signature]

THIS GRANT OF EASEMENT, made this 6th day of MAY
19 74, between the undersigned "Grantor" and the TAHOE DOUGLAS
DISTRICT, as "GRANTEE":

WITNESSETH, that the Grantor, for valuable consideration, receipt
of which is hereby acknowledged, has granted and conveyed, and by
these presents does grant and confirm into the Grantee, its successors
and assigns, the easements and rights-of-way for the purpose of the
installation and maintenance of sewer utility lines and necessary
appurtenances in the County of Douglas, State of Nevada, and described
in the attached Exhibit "A"; including the right to enter upon the
property described in Exhibit "A" at any time for maintenance, repair
and construction of sewer utility lines.

IN WITNESS WHEREOF, the said Grantor has hereunto set his hand
and seal the day and year first above written.

GRANTOR:

GRANTOR:

[Signature]
Jessie Desmith

STATE OF Nevada)
) ss.
COUNTY OF Lyon)

On this 6th day of MAY, 19 74, before me, a Notary
Public, in and for the County of Lyon, personally appeared

Jessie Desmith

known to me to be the person(s) whose name(s) is/are subscribed to the
within instrument, and she duly acknowledged to me that she executed
the same.

IN WITNESS WHEREOF, I have hereunto set my hand and affixed my
official seal the day and year in this certificate first above written.

[Signature]
NOTARY PUBLIC

Assessment No. 1318-04E-011

DOROTHY JEAN ACCIARI
Notary Public — State of Nevada
Lyon County
My Commission Expires Dec. 6, 1975

77824

BOOK 175 PAGE 1198



ENGINEERS LTD., INC.

CIVIL ENGINEERING — SURVEYING

P.O. BOX 616
ZEPHYR COVE, NEVADA 89448
PHONE (702) — 588-4567

Jennie C. Nesmith
Smith Nevada
89430

February 22, 1972

*form ltr +
agree. sent
11/5/73*

SEWER EASEMENT DESCRIPTION

A parcel of land being a portion of Section 9, T13N, R18E, M.D.M., and of Lot 11, Block E as shown on that certain map entitled ZephyrCove Properties No. 2, Official Records of Douglas County, Nevada and being further described as follows:

An easement for constructing, maintaining and operating a sewer system on the southwesterly 15 feet of said Lot 11 of said Zephyr Cove Properties No. 2.

Also a 10 foot wide temporary working easement lying northeasterly and immediately adjacent to the above described easement.

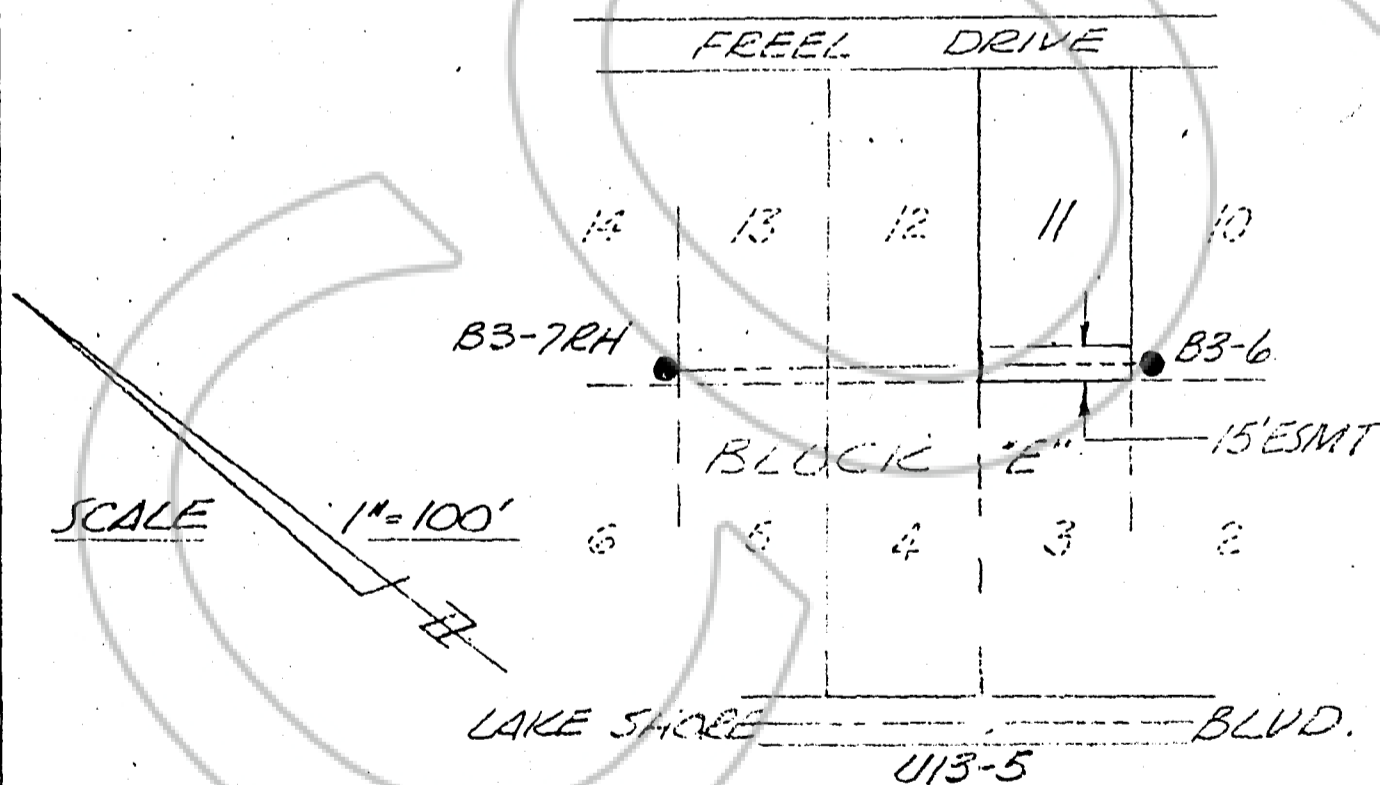

1318-04E-011

Sheet "A"

77824
BOOK 175 PAGE 1199

83