

Deed of Trust

Application No. 11402-B

THIS DEED OF TRUST Made this 19th day of April, 1978, between S.R. PIMLEY, an unmarried woman and BARRY PIMLEY and DENNIS PIMLEY herein called TRUSTOR, whose address is her sons, as Joint Tenants

SILVER STATE TITLE COMPANY, a corporation, organized and existing under and by virtue of the laws of the State of Nevada, TRUSTEE, for DALE R. BERGLUND, a single man, herein called BENEFICIARY,

WITNESSETH: That Trustor irrevocably GRANTS, TRANSFERS AND ASSIGNS TO TRUSTEE IN TRUST, WITH POWER OF SALE, that property in the _____, County of Douglas, State of Nevada, described as:

SEE DESCRIPTION SHEET ATTACHED HERETO AND MADE A PART HEREOF.

TOGETHER WITH all and singular the tenements, hereditaments, and appurtenances thereunto belonging or in anywise appertaining, and the reversion and reversions, remainder and remainders, rents, issues, and profits thereof.

TO HAVE AND TO HOLD the same unto Trustee and its successors, for the purpose of securing a certain promissory note of even date herewith in the principal sum of FIFTEEN THOUSAND NINE HUNDRED SEVENTY-FIVE AND NO/100 DOLLARS (\$ 15,975.00) with interest thereon, and with expenses and attorney's fees according to its terms, executed and delivered by Grantor to Beneficiary.

The following covenants, Numbers 1, 2, maximum insurable value, 3, 4 (10%), 5, 6, 7 (10%), 8 and 9 of NRS 107.030 are hereby adopted and made a part hereof.

All the provisions of this instrument shall inure to, apply to, and bind the heirs, executors, successors, and assigns of all the parties hereto. Whenever used, the singular number shall include the plural, the plural the singular, and the use of any gender shall include all other genders.

IN WITNESS WHEREOF, Grantor has executed these presents the day and year first above written.

S.R. Pimley
S.R. PIMLEY
Barry Pimley
BARRY PIMLEY
Dennis Pimley
DENNIS PIMLEY

STATE OF NEVADA
COUNTY OF DOUGLAS ss.

On this 11th day of May, 1978, before me, the undersigned
a Notary Public in and for said County, personally appeared S. R. Pimley, Barry Pimley, and Dennis Pimley

known to me to be the person S whose name S are subscribed to the foregoing instrument and acknowledged that t hey executed the same.

Notary Public - State of Nevada
MARILYN L. BIGHAM
DOUGLAS COUNTY
My Commission Expires Nov. 6, 1979

Witness my hand and official seal
Marilyn L. Bigham
NOTARY PUBLIC in and for said County and State
My commission expires November 6, 1979

FOR RECORDER'S USE

DOCUMENT NO. _____
FILED AT REQUEST OF _____
ON _____, 19____, AT _____
O'CLOCK _____ M. IN BOOK _____ OF _____
AT PAGE _____
RECORDS OF _____ COUNTY, NEVADA.
FEE: \$ _____

COUNTY RECORDER
BY: _____
DEPUTY

20631
BOOK **578** PAGE **909**

ALL THAT CERTAIN LOT, PIECE OR PARCEL OF LAND SITUATE IN THE COUNTY OF DOUGLAS,
STATE OF NEVADA, DESCRIBED AS FOLLOWS:

That portion of the Southwest 1/4 of the Northwest 1/4 of Section 34, Township
14 North, Range 20 East, M.D.B. & M., described as follows:

COMMENCING at the West 1/4 corner of said Section 34; thence North 03°36'33" East
a distance of 663.36 feet to a point in the Easterly line of a roadway; thence North
00°09'10" East along the Easterly line of said roadway a distance of 262.85 feet to
a point in said Easterly line, the Southwest corner of the herein described parcel
of land, the TRUE POINT OF BEGINNING; thence continuing North 00°09'10" East along
the Easterly line of said roadway a distance of 396.29 feet to a point in the
Easterly line, at the Northwest corner hereof; thence North 89°48'13" East a distance
of 619.25 feet to a point at the Northeast corner hereof; thence South 00°02'47"
West, a distance of 396.29 feet to a point at the Southeast corner hereof; thence
South 89°48'13" West a distance of 619.99 feet to the TRUE POINT OF BEGINNING.
Assessor's Parcel No. 21-170-01.

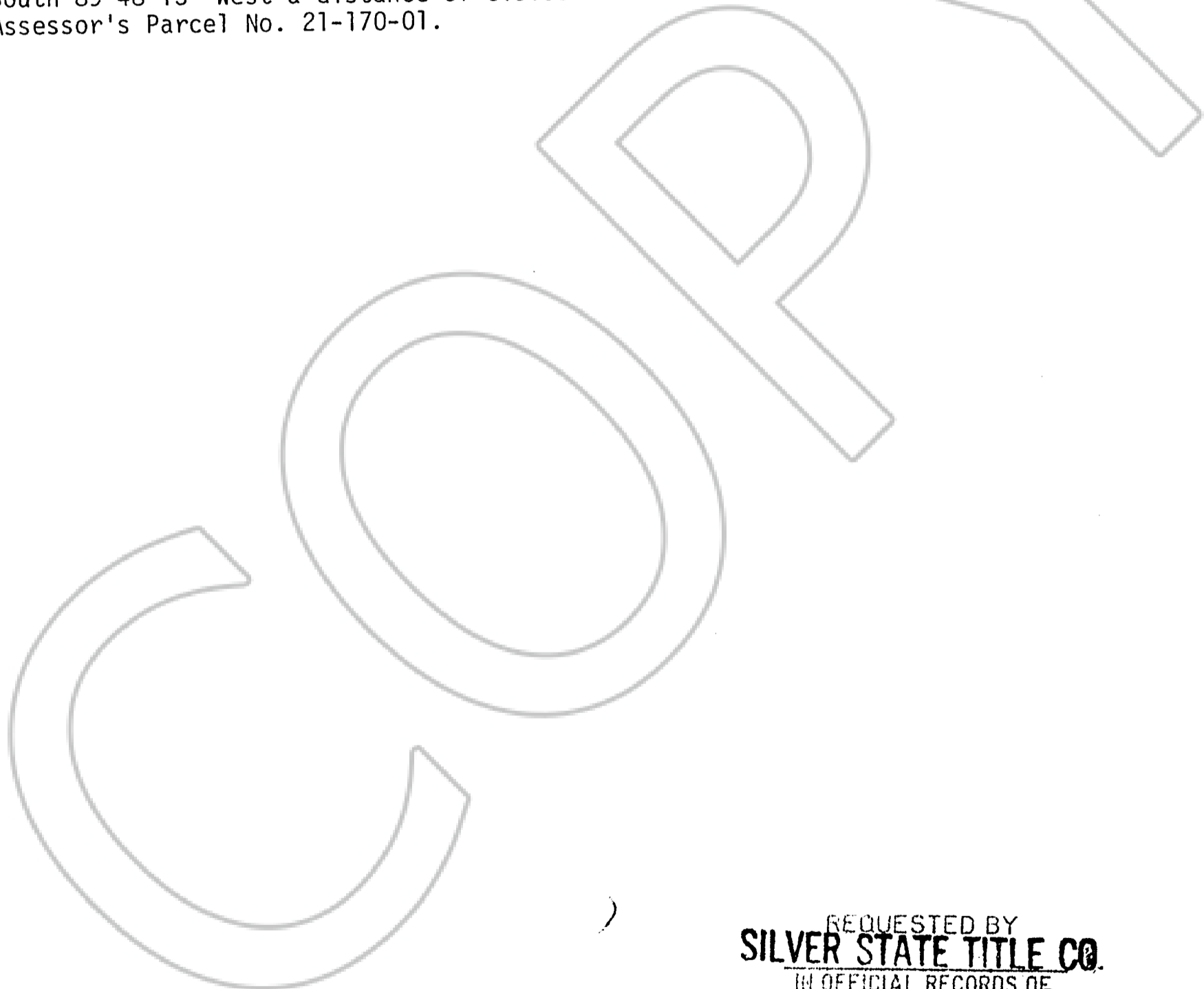

REQUESTED BY
SILVER STATE TITLE CO.

IN OFFICIAL RECORDS OF
DOUGLAS CO. NEVADA

#4.00 fee

1978 MAY 12 PM 3:46

PATRICIA J. WILLIAMS
RECORDER

Donna Juchter 20631
Ulep
BOOK 578 PAGE 910