

COUNTY ENGINEER'S CERTIFICATE:
 I, Robert A. Gardner, Engineer in and for the County of Douglas, State of Nevada, hereby certify that I have examined this map and that all conditions of State Law, local ordinances, and other reviewing agencies have been complied with and I am satisfied the same is technically correct.
 Robert A. Gardner Sept. 20, 1978
 Douglas County Engineer Date

SURVEYOR'S CERTIFICATE:
 I, Robert G. Downer, a Registered Land Surveyor in the State of Nevada, certify that:
 1. This is a true and accurate representation of lands surveyed under my supervision and the assistance of Mike Ludel.
 2. The lands lie within SE 1/4 SE 1/4 NE 1/4 Sec. 35, T. 11 N., R. 21 E.
 3. This plot complies with the applicable state statutes & local ordinances.
 4. The monuments are of the character shown & occupy the positions indicated.
 Robert G. Downer
 Robert G. Downer, R.L.S. 2350

UTILITY COMPANIES' CERTIFICATE:
 The easements shown on this plat have been checked and approved by Sierra Pacific Power Co. and Continental Telephone Co. of Nevada. This approval does not guarantee accessibility of service.
 R.E. Shannon 6/24/78 H. Feltner 6-29-78
 Sierra Pacific Power Co. Date Continental Telephone Co. of Nev. Date

SCALE: 1" = 100'

OWNERS' CERTIFICATE: This is to certify that the undersigned MICHAEL LUDEL & CARL MICHAEL CASE are the owners of the parcels shown on this plat and that they hereby dedicate and set apart all easements for utility installations and access as shown hereon to be used forever.
 Michael Ludel Carl Michael Case
 MICHAEL LUDEL CARL MICHAEL CASE

STATE OF NEVADA 55
 COUNTY OF DOUGLAS
 On August 10, 1978, personally appeared before me, a notary public, Michael Ludel and Carl Michael Case who acknowledged that they executed the within instrument.

Jerry W. Gregory
 Notary Public - State of Nevada
 Douglas County
 My Commission Expires Nov. 19, 1980

PLANNING COMMISSION CERTIFICATE
 I, Barbara J. Cook, Secretary to the Douglas County Planning Commission, do hereby certify that this parcel map was approved and accepted this 29th day of June 1978, by the Douglas County Planning Commission.
 Barbara J. Cook
 Barbara J. Cook

RECORDER'S CERTIFICATE:
 Filed this 25th day of SEPTEMBER, 1978, at 8:36 A.M. in Book 978 of Parcel Maps at Page 172, at the request of Mike Ludel. Fee \$ 5.00 pd.
 Patricia Williams, County Recorder

Basis of Bearing is the South Line of the S.E. 1/4 of Sec. 35 as shown on the U.S.G.L.O. Resurvey of the 2nd. Standard Parallel in 1940

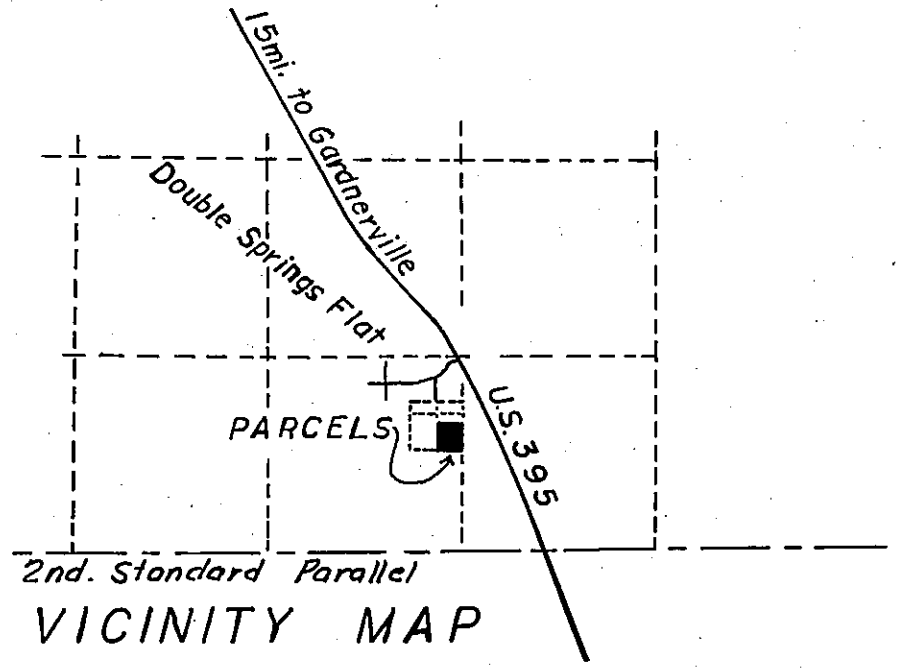

PARCEL MAP OF LUDEL PROPERTY
 LOCATED IN THE SE 1/4 OF THE SE 1/4 OF THE NE 1/4 OF SECTION 35, T. 11 N., R. 21 E., M.D.B. & M.
 DOWNER ENGINEERING GARDNERVILLE, NEVADA