

**NOTES**

- 1) THE PARCELS WILL BE SUBJECT TO RECIPROCAL RIGHTS TO USE AND OPERATE, MAINTAIN, REPLACE, AND REPAIR ALL IRRIGATION AND OTHER DITCHES AND CANALS TRAVERSING THE PARCELS IN ACCORDANCE WITH HISTORICAL CUSTOMS AND USAGE.
- 2) ALL PARCELS EXCEPT PORTIONS OF PARCELS 1 & 6 ARE SUBJECT TO FLOODING ACCORDING TO THE 100 YEAR FLOOD MAP PREPARED BY H.U.D.

**SURVEYOR'S CERTIFICATE**

This map was prepared in part from existing information in the field notes & plat maps of the gov. survey on file in the B.L.M. office in Reno, NV and the undersigned assumes no responsibility for the existence of monuments or correctness of other information shown or copied from any such prior documents. All acreages, distances, and bearings shown are subject to field varification.

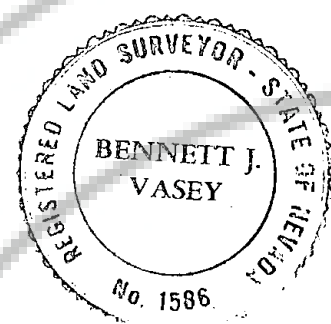

*B. J. Vasey*  
B. J. Vasey  
R.L.S. 1586

**OWNER'S CERTIFICATE**

This is to certify that the undersigned, Stokes, Shaw, Heaton, & Doescher, L.T.D., is the owner of the land shown on this map which is to be filed pursuant to N.R.S. 278.323 and that they hereby grant permanent easements as shown on this map.

Stokes, Shaw, Heaton, & Doescher, L.T.D.

*William J. Shaw*

CARSON CITY S.S.  
STATE OF NEVADA

On this 30<sup>th</sup> day of October, 1978, William J. Shaw  
Stokes, Shaw, Heaton, & Doescher, L.T.D., acting on behalf of said corporation did personally appear before me, a notary public, and executed the above instrument.

*John Ellis*  
Notary Public

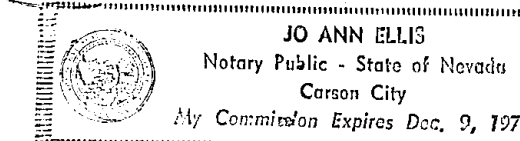

**MORTGAGEE'S CERTIFICATE**

This is to certify that the undersigned, Armand D. Bosc and Betty B. Bosc, Andre Bosc and Marie Bosc, are the holders of a security interest in the land shown on this map, which is to be filed pursuant to N.R.S. 278.323 and has approved the preparation and recordation of this map and the granting of the permanent easements herein set forth.

*Armand D. Bosc Andre Bosc*  
*Betty B. Bosc Marie Bosc*  
Armand D. Bosc & Betty B. Bosc, Andre Bosc & Marie Bosc,

STATE OF CALIFORNIA  
COUNTY OF SAN FRANCISCO

On this 17<sup>th</sup> day of November, 1978, Armand D. Bosc and Betty B. Bosc, & Andre Bosc and Marie Bosc, did personally appear before me, a notary public, and executed the above instrument.

*Mary A. Norman*  
Notary Public

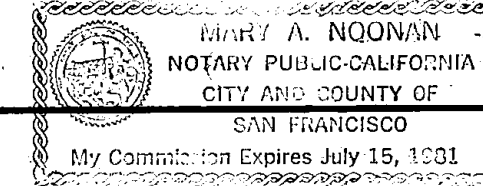

**COUNTY CLERK'S CERTIFICATE**

This Land Division Map was approved by the Douglas County Commissioners on the 21<sup>st</sup> day of December, 1978.

*Yvonne Bernard*  
County Clerk

**RECORDER'S CERTIFICATE**

Filed for record this 12<sup>th</sup> day of JANUARY, 1979, at 3:47 o'clock A.M. in book 179, page 595, of the Official Records of Douglas County, Nevada, at the request of Stokes, Shaw, Heaton & Doescher, Ltd. Document No. 28932.

*Donna Quachtz (Deputy)*  
Marie Rabel  
Douglas County Recorder

LAND DIVISION MAP FOR  
STOKES, SHAW, HEATON, AND DOESCHER L. T. D.  
  
Located in portions of  
NW1/4 Section 31 & W1/2 Section 30 T.14N., R.20E.  
M.D.B. & M.  
Douglas County, Nevada

**VASEY ENGINEERING CO., INC**  
VALLEY PROFESSIONAL CENTER  
P.O. BOX 1164 MINDEN, NEVADA 89423  
(702) 782-2382 (702) 782-5642