

# Grant Deed

P.T.T. \$ 55  
*Jane Alley*

THIS INDENTURE WITNESSETH: THAT GURA NEVADA, a Nevada corporation

THE FIRST PART ies , IN CONSIDERATION OF \$10.00, THE RECEIPT OF WHICH IS HEREBY ACKNOWLEDGED, DO HEREBY,  
GRANT, BARGAIN, AND SELL TO FERDIE SIEVERS, an unmarried man

THE SECOND PART y , AND TO THEIR HEIRS AND ASSIGNS, ALL THAT REAL PROPERTY SITUATE IN  
Douglas County, State of Nevada PARTICULARLY DESCRIBED AS FOLLOWS:

SEE DESCRIPTION SHEET ATTACHED HERETO AND MADE A PART OF:

THIS DOCUMENT IS RECORDED AS AN ACCOMMODATION  
and without liability for the consideration therefor, or as to  
the validity or sufficiency of said instrument, or for the  
effect of such recording on the title of the property involved.

TOGETHER WITH ALL AND SINGULAR THE TENEMENTS, HEREDITAMENTS AND APPURTENANCES THEREUNTO BELONGING  
OR IN ANYWISE APPERTAINING, AND THE REVERSION AND REVERSIONS, REMAINDER AND REMAINDERS, RENTS, ISSUES, AND  
PROFETS THEREOF.

TO HAVE AND TO HOLD THE SAID PROPERTY, TOGETHER WITH THE APPURTENANCES, UNTO THE SAID PART Y OF  
THE SECOND PART, AND TO his HEIRS AND ASSIGNS, FOREVER.

WITNESS MY HAND THIS 11th DAY OF December, 19 80  
GURA NEVADA, a Nevada corporation

STATE OF Nevada  
COUNTY OF Douglas

ss.

BY: *[Signature]*  
VICE PRESIDENT  
James C. Nairne, Vice President  
of Gura Nevada Inc., a Nevada corp

On this 11th day of December, 19 80, before me, the undersigned  
a Notary Public in and for said County, personally appeared James C. Nairne, Vice President of Gura  
Nevada, and

known to me to be the person whose name is subscribed to the foregoing instrument and acknowledged  
that he executed the same, freely and voluntarily and for the uses and purposes therein mentioned.

Witness my hand and official seal

*Jane Alley*  
NOTARY PUBLIC in and for said County and State

My commission expires \_\_\_\_\_, 19 \_\_\_\_\_

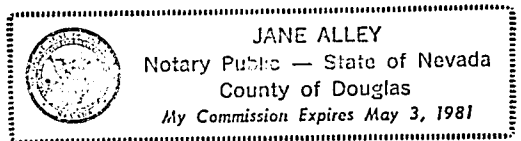

After recording please mail to:  
Ferdie Sievers  
P. O. Box 3408  
Lockeford, Cal

FOR RECORDER'S USE

DESCRIPTION SHEET

ALL THAT CERTAIN LOT, PIECE OR PARCEL OF LAND SITUATE IN THE COUNTY OF DOUGLAS, STATE OF NEVADA, DESCRIBED AS FOLLOWS:

PARCEL 2

A parcel of land situated in the Northwest 1/4 of Section 18, Township 13 North, Range 19 East, M.D.B. & M., Douglas County, Nevada, and more particularly described as follows:

Commencing at the Northwest corner of said Section 18; thence South 00°23'38" West 493.57 feet to the TRUE POINT OF BEGINNING; thence continuing South 00°23'38" West 384.43 feet; thence North 89°12'10" East 646.18 feet to the East edge of Castle Rock Road; thence along said East edge: North 23°55'55" East 226.96 feet; thence along a curve concave to the West with central angle of 37°47'20" and radius of 230.00 feet an arc length of 151.69 feet; thence North 13°51'25" West 29.23 feet; thence leaving said East edge South 89°19'25" West 741.66 feet to the POINT OF BEGINNING.

Together with and subject to an easement for access and utilities 60 feet in width lying Westerly and parallel with the above courses noted as being the East edge of Castle Rock Road and extension thereof to Andria Drive.

Assessor's Parcel No 11-051-02.

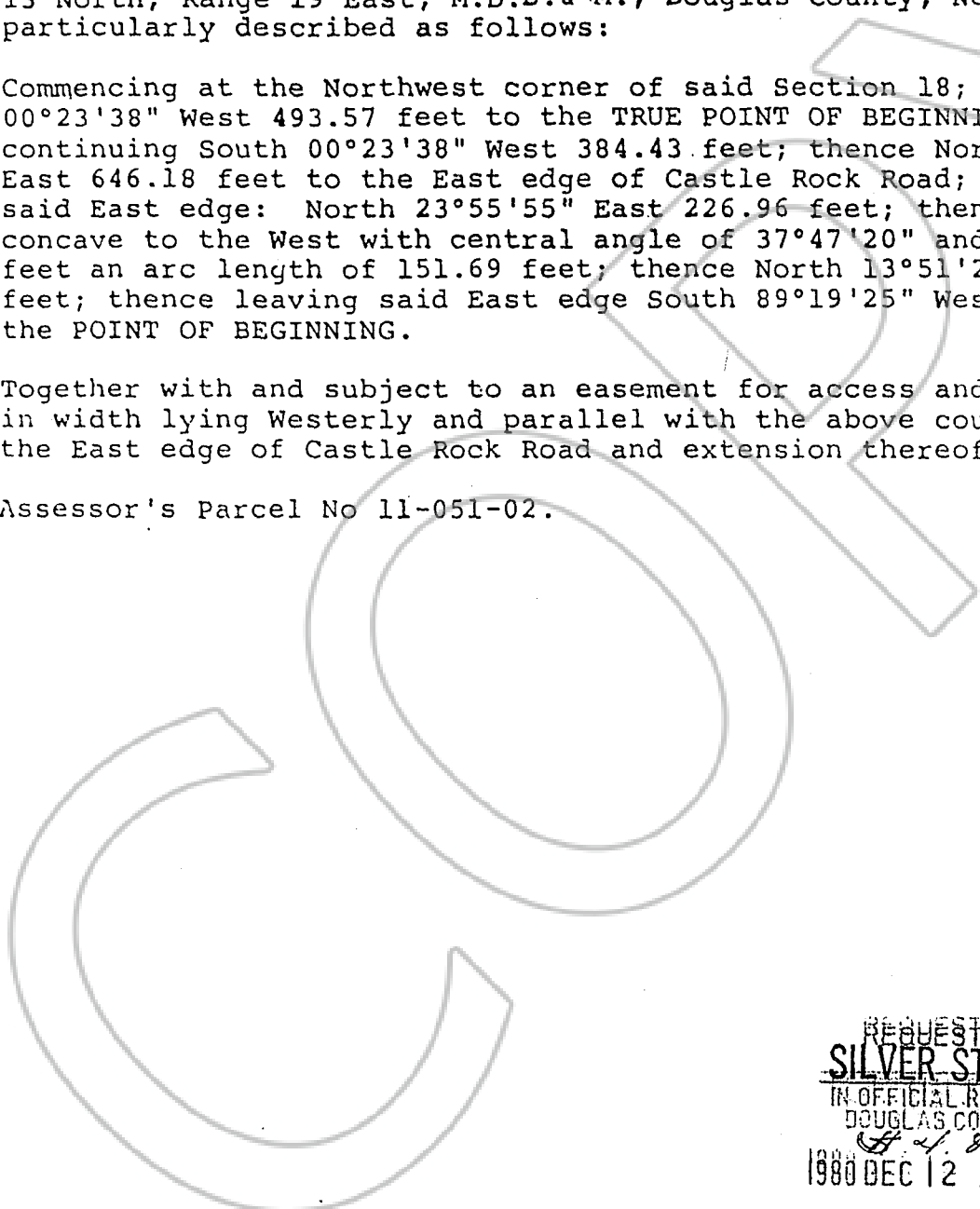

REQUESTED BY  
**SILVER STATE TITLE CO.**

IN OFFICIAL RECORDS OF  
DOUGLAS CO. NEVADA

*S. J. D. J. D.*  
1980 DEC 12 AM 10:59

**MARIE A. RADEL**  
RECORDER

*Lisa Platts*  
*dep.*

**51610**

BOOK 1280 PAGE 924