

**UNIFORM COMMERCIAL CODE-FINANCING STATEMENT-FORM UCC-1**  
**IMPORTANT-Read instructions on back before filling out form**

92119



This **FINANCING STATEMENT** is presented for filing pursuant to the Nevada Uniform Commercial Code

1. DEBTOR (LAST NAME FIRST) MICHELSEN CONSTRUCTION COMPANY, a general partnership		1A. SOCIAL SECURITY OR FEDERAL TAX NO. [REDACTED] 16437	
1B. MAILING ADDRESS P.O. Box 646		1C. CITY, STATE Zephyr Cove, Nevada	
1E. RESIDENCE ADDRESS (IF AN INDIVIDUAL AND DIFFERENT THAN 1B)		1F. CITY, STATE	
1D. ZIP CODE 89448		1G. ZIP CODE	
2. ADDITIONAL DEBTOR (IF ANY) (LAST NAME FIRST)		2A. SOCIAL SECURITY OR FEDERAL TAX NO.	
2B. MAILING ADDRESS		2C. CITY, STATE	
2E. RESIDENCE ADDRESS (IF AN INDIVIDUAL AND DIFFERENT THAN 2B)		2F. CITY, STATE	
2D. ZIP CODE		2G. ZIP CODE	
3. DEBTOR(S) TRADE NAME OR STYLE (IF ANY)		3A. FEDERAL TAX NO.	
4. ADDRESS OF DEBTOR(S) CHIEF PLACE OF BUSINESS (IF ANY)		4A. CITY, STATE	
4B. ZIP CODE		5A. SOCIAL SECURITY NO. FEDERAL TAX NO. OR BANK TRANSIT AND A.B.A. NO. 84-0753882	
5. SECURED PARTY NAME Gasamat Oil Corp. of Colorado MAILING ADDRESS 999 Eighteenth Street, Suite 355 CITY Denver STATE Colorado ZIP CODE 80202		6A. SOCIAL SECURITY NO. FEDERAL TAX NO. OR BANK TRANSIT AND A.B.A. NO.	
6. ASSIGNEE OF SECURED PARTY (IF ANY) NAME MAILING ADDRESS CITY STATE ZIP CODE			

7. This FINANCING STATEMENT covers the following types or items of property (if crops or timber, include description of real property on which growing or to be grown and name of record owner of such real estate, if fixtures, include description of real property to which affixed or to be affixed and name of record owner of such real estate, if oil, gas or minerals, include description of real property from which to be extracted.

All of Debtor's interest in and to all buildings, improvements, fixtures, facilities, apparatus, equipment and personal property now or hereafter acquired, located on and/or used in connection with the real property described in Exhibit A attached hereto and incorporated herein by this reference.

MICHELSEN CONSTRUCTION COMPANY

7A. By: John E. Michelsen General Partner  
SIGNATURE OF RECORD OWNER

7C. \$ \_\_\_\_\_  
MAXIMUM AMOUNT OF INDEBTEDNESS TO BE SECURED AT ANY ONE TIME (OPTIONAL)

7B. MICHELSEN CONSTRUCTION COMPANY  
(TYPE) RECORD OWNER OF REAL PROPERTY

8. Check <input checked="" type="checkbox"/> if Applicable	A <input checked="" type="checkbox"/> Proceeds of collateral are also covered	B <input type="checkbox"/> Products of collateral are also covered	C <input type="checkbox"/> Proceeds of above described original collateral in which a security interest was perfected	D <input type="checkbox"/> Collateral was brought into this State subject to security interest in another jurisdiction
--	---	--	---	--

9. Check  if Applicable  DEBTOR IS A "TRANSMITTING UTILITY" IN ACCORDANCE WITH NRS 704.205 AND NRS 104.9403

10. (Date) July 19 86

MICHELSEN CONSTRUCTION COMPANY

By: John E. Michelsen General Partner  
SIGNATURE(S) OF DEBTOR(S) (TITLE)

GASAMAT OIL CORP. OF COLORADO

By: [Signature] President  
SIGNATURE(S) OF SECURED PARTY (IES) (TITLE)

12. This Space for Use of Filing Officer  
 (Date, Time, File Number and Filing Officer)

06382

11. Return Copy to

NAME  
 ADDRESS  
 CITY, STATE  
 AND ZIP

BOOK 139257 PAGE 1892

THIS SPACE FOR USE OF FILING OFFICER

EXHIBIT A

LEGAL DESCRIPTION

All that certain lot, piece or parcel of land situate in the County of Douglas, State of Nevada, described as follows:

That portion of the Northwest Quarter of Section 26, Township 13 North, Range 18 East, M.D.B. & M., described as follows:

BEGINNING AT A POINT IN THE Southerly right of way line of Kingsbury Grade, from which the Section corner common to Sections 22, 23, 26 and 27 of said Township and Range bears North  $76^{\circ}47'50''$  West a distance of 388.80 feet; thence from the point of beginning South  $17^{\circ}40'$  East a distance of 90.00 feet; thence North  $81^{\circ}11'57''$  East a distance of 138.00 feet; thence North  $10^{\circ}12'28''$  West a distance of 100.44 feet, to a point in the Southerly right of way line of said Kingsbury Grade; thence along said right of way line, along a curve to the left, the center of which bears South  $8^{\circ}42'51''$  East, having a radius of 960.0 feet through a central angle of  $8^{\circ}57'09''$  an arc distance of 150.00 feet, to the point of beginning.

Assessment Parcel No. 07-130-09

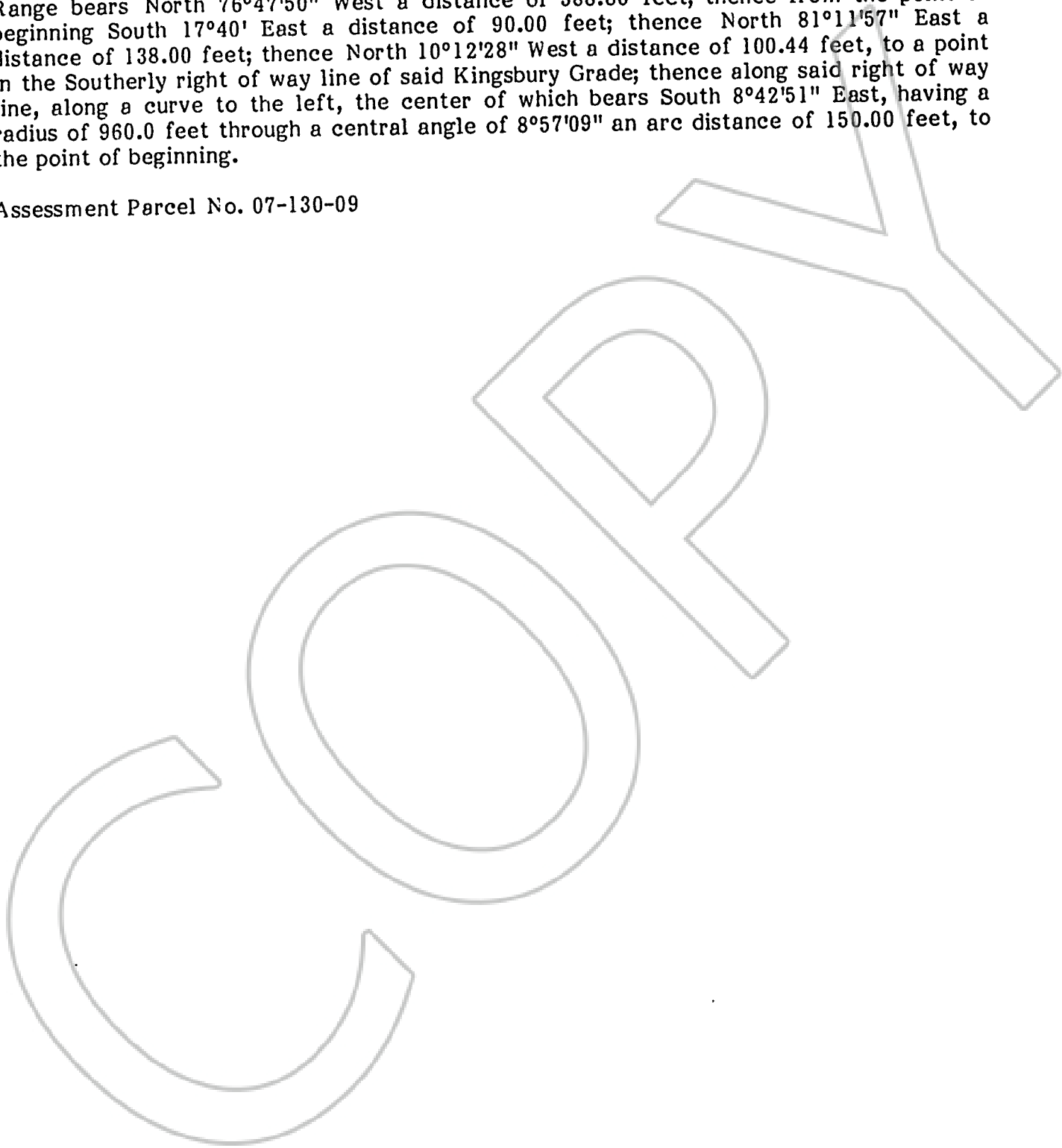

REQUESTED BY  
**DOUGLAS COUNTY TITLE**  
IN OFFICIAL RECORDS OF  
DOUGLAS COUNTY, NEVADA

'26 AUG 18 P1:58

SUZANNE BEAUBREAU  
RECORDER

\$6- PAID *Ju* DEPUTY

139257  
BOOK 886 PAGE 1893