

Assignment of Deed of Trust

TO 5038 NV (1-75)

THIS FORM FURNISHED BY TITLE INSURANCE AND TRUST COMPANY

For Value Received, the undersigned hereby grants, assigns and transfers to _____
EMPIRE OF AMERICA REALTY CREDIT CORP.

all beneficial interest under that certain Deed of Trust dated February 5, 1987
executed by ROGER WILLIAM PIERCE, an unmarried man

to HOME ESCROW, a Nevada corporation, Trustor
and recorded as Instrument No. 150343 on February 23, 1987 in book _____, Trustee,
page _____ of Official Records in the County Recorder's office of Douglas County,
Nevada, describing land therein as:

See Exhibit "A"

Together with the note or notes therein described or referred to, the money due and to become due thereon with
interest, and all rights accrued or to accrue under said Deed of Trust.
Dated March 10, 1987

HOME FEDERAL SAVINGS BANK OF NEVADA

By: J. Duncan
J. Duncan
Vice President

STATE OF NEVADA, }
COUNTY OF Washoe } SS.
On March 10, 1987 personally
appeared before me, a Notary Public,

(Type or print names under signatures)

J. Duncan

who acknowledged that he executed the above instrument.
Signature: Renée McMahon
(Notary Public)

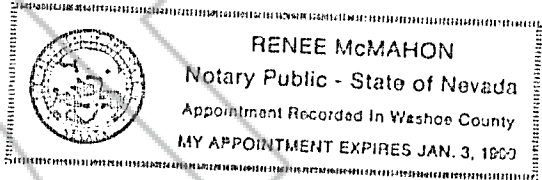

(This area for official notarial seal)

Title Order No.

Escrow or Loan No.

SPACE BELOW THIS LINE FOR RECORDER'S USE

RECORDING REQUESTED BY

HOME FEDERAL SAVINGS

AND WHEN RECORDED MAIL TO

Home HOME FEDERAL SAVINGS BANK
Street Address P.O. BOX 462
City & State RENO, NV 89504

151727

BOOK 387 PAGE 1942

Lot 1, in Block A, in the HAWKINS ADDITION TO THE TOWN OF GARDNERVILLE, Douglas County, Nevada, as per the Official Map on record in the file of the County of Douglas, together with all the water and water rights, ditch and ditch rights belonging thereto.

EXCEPTING THEREFROM, the Northeast portion of Lot 1, Block A of the Hawkins Addition to the Town of Gardnerville, Nevada, and more particularly described as follows:

Taking the line between the concrete monument located at the intersection to the center lines of Douglas Avenue and High School Street and the concrete monument located at the intersection of the Center line of U.S. Highway 395 and High School Street to be: North 45°14' East, 438.8 feet, then the description of the above name lot is as follows: Beginning at a point that bears North 33°55' East, 127.47 feet from the concrete monument at the intersection of the centerlines of Douglas Avenue and High School Street and running thence North 45°14' East 70 feet, thence North 44°46' West, 64.70 feet; thence South 45°14' West 77.50 feet; thence South 44°46' East, 64.70 feet; thence North 45°14' East 7.50 feet to the Point of Beginning.

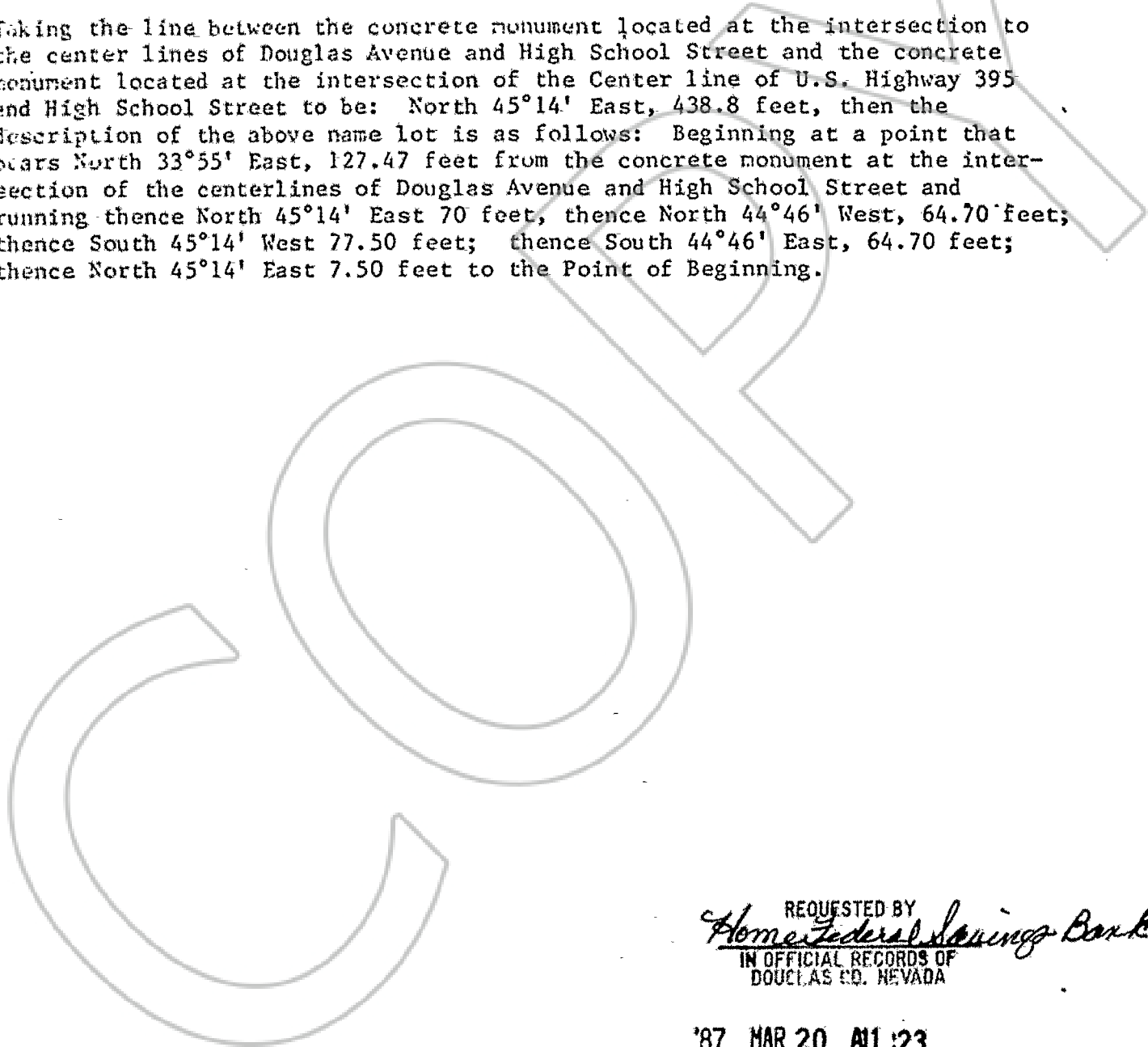

REQUESTED BY
Home Federal Savings Bank
IN OFFICIAL RECORDS OF
DOUGLAS CO. NEVADA

'87 MAR 20 AM 1:23

SUZANNE BEAUGREAU
RECORDER

PAID *JL* DEPUTY 151727