

43618 MTD

This Deed of Trust, made this 12th day of MAY, 1988, between PAUL O'KEEFFE AND DIANA O'KEEFFE, AS TRUSTEES OF THE O'KEEFFE FAMILY TRUST U/D/T DATED NOVEMBER 25, 1986, herein called TRUSTOR, whose address is 4212 Cresta Ave., Santa Barbara, CA 93110 (number and street) (city) (zone) (state)

TICOR TITLE INSURANCE COMPANY OF CALIFORNIA, formerly Title Insurance and Trust Company, a California corporation, herein called TRUSTEE, and ROBERT H. NORRIS AND BARBARA B. NORRIS, AS TRUSTEES OF THE NORRIS FAMILY TRUST, U/D/T DATED MARCH 25, 1983, herein called BENEFICIARY,

Witnesseth: That Trustor IRREVOCABLY GRANTS, TRANSFERS AND ASSIGNS TO TRUSTEE IN TRUST, WITH POWER OF SALE, that property in Douglas County, Nevada, described as:

See Exhibit "A" attached hereto and made a part hereof.

TOGETHER WITH the rents, issues and profits thereof, reserving the right to collect and use the same except during continuance of some default hereunder and during continuance of such default authorizing Beneficiary to collect and enforce the same by any lawful means in the name of any party hereto.

For the Purpose of Securing: 1. Performance of each agreement of Trustor incorporated by reference or contained herein. 2. Payment of the indebtedness evidenced by one promissory note of even date herewith, and any extension or renewal thereof, in the principal sum of \$ 250,000.00 executed by Trustor in favor of Beneficiary or order. 3. Payment of such additional sums as may hereafter be advanced for the account of Trustor or Assigns by Beneficiary with interest thereon.

To Protect the Security of This Deed of Trust, Trustor Agrees: By the execution and delivery of this Deed of Trust and the note secured hereby, that provisions (1) to (16) inclusive of the master form deed of trust recorded April 6, 1977 in the Book and at the page, or document No. of Official Records and Real Estate Records in the Office of the county recorder of the county where said property is located, noted below opposite the name of such County, viz:

COUNTY	DOCUMENT No.	BOOK	PAGE	COUNTY	DOCUMENT No.	BOOK	PAGE	COUNTY	DOCUMENT No.	BOOK	PAGE
Clark	684193	725		Humboldt	177079	98	60	Nye	57688	200	646
Churchill	150674	110	294	Lander	86175	146	208	Carson City	69631	205	475
Douglas	8240	477	267	Lincoln	59458	20	144	Pershing	98382	82	528
Elko	013986	244	679	Washoe	457660	1068	135	Storey	40371	6	561
Esmeralda	63862	32	58	Lyon	32040			White Pine	189090	402	4
Eureka	62824	58	436	Mineral	31324	53	209				

(which provisions, identical in all counties, are printed on the reverse hereof) hereby are adopted and incorporated herein and made a part hereof as fully as though set forth herein at length; that he will observe and perform said provisions; and that the references to property, obligations, and parties in said provisions shall be construed to refer to the property, obligations, and parties set forth in this Deed of Trust.

The undersigned Trustor requests that a copy of any Notice of Default and of any Notice of Sale hereunder be mailed to him at his address hereinbefore set forth.

STATE OF ~~NEVADA~~ California }
COUNTY OF Santa Barbara } SS.
On May 16, 1988 personally appeared before me, a Notary Public, in and for said County and State, PAUL O'KEEFFE AND DIANA O'KEEFFE, personally known to me to be the persons whose names are subscribed to the within instrument and who acknowledged that they executed the above instrument as Trustees. WITNESS my hand and official seal.

Paul O'Keefe
PAUL O'KEEFFE, AS TRUSTEE**
Diana O'Keefe
DIANA O'KEEFFE, AS TRUSTEE**
** OF THE O'KEEFFE FAMILY TRUST
U/D/T DATED NOVEMBER 25, 1986
If executed by a Corporation the Corporation Form of Acknowledgment must be used.

Signature *Mary P Horst*

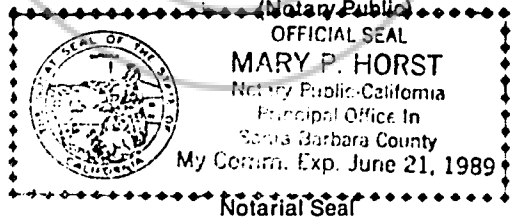

Title Order No. 43618 MTD

Escrow or Loan No. 193672-MPH

SPACE BELOW THIS LINE FOR RECORDER'S USE

THIS FORM COMPLIMENTS OF
TICOR TITLE INSURANCE COMPANY OF CALIFORNIA
TITLE INSURANCE AND TRUST
WHEN RECORDED MAIL TO

NAME ROBERT H. NORRIS, ET AL., AS TRUSTEES
STREET ADDRESS P. O. BOX 5091
INCLINE VILLAGE, NEVADA 89450
CITY & STATE

178304
BOOK 588 PAGE 2501

EXHIBIT "A"

All that certain lot, piece or parcel of land situate in the County of Douglas, State of Nevada, described as follows:

PARCEL 1:

Lot 49, in Block A, as shown on the second AMENDED MAP OF GLENBROOK SUBDIVISION UNIT 2, filed for record in the Office of the County Recorder of Douglas County, Nevada, on January 30, 1980, in Book 180, Page 1512, as Document No. 41035, Official Records of Douglas County, Nevada.

PARCEL 2:

The exclusive right to use for garage purposes that parcel designed as "Garage Easement" that is appurtenant to Lot 49 Block A as shown on the map referenced in Parcel One above.

A.P.N. 01-161-38

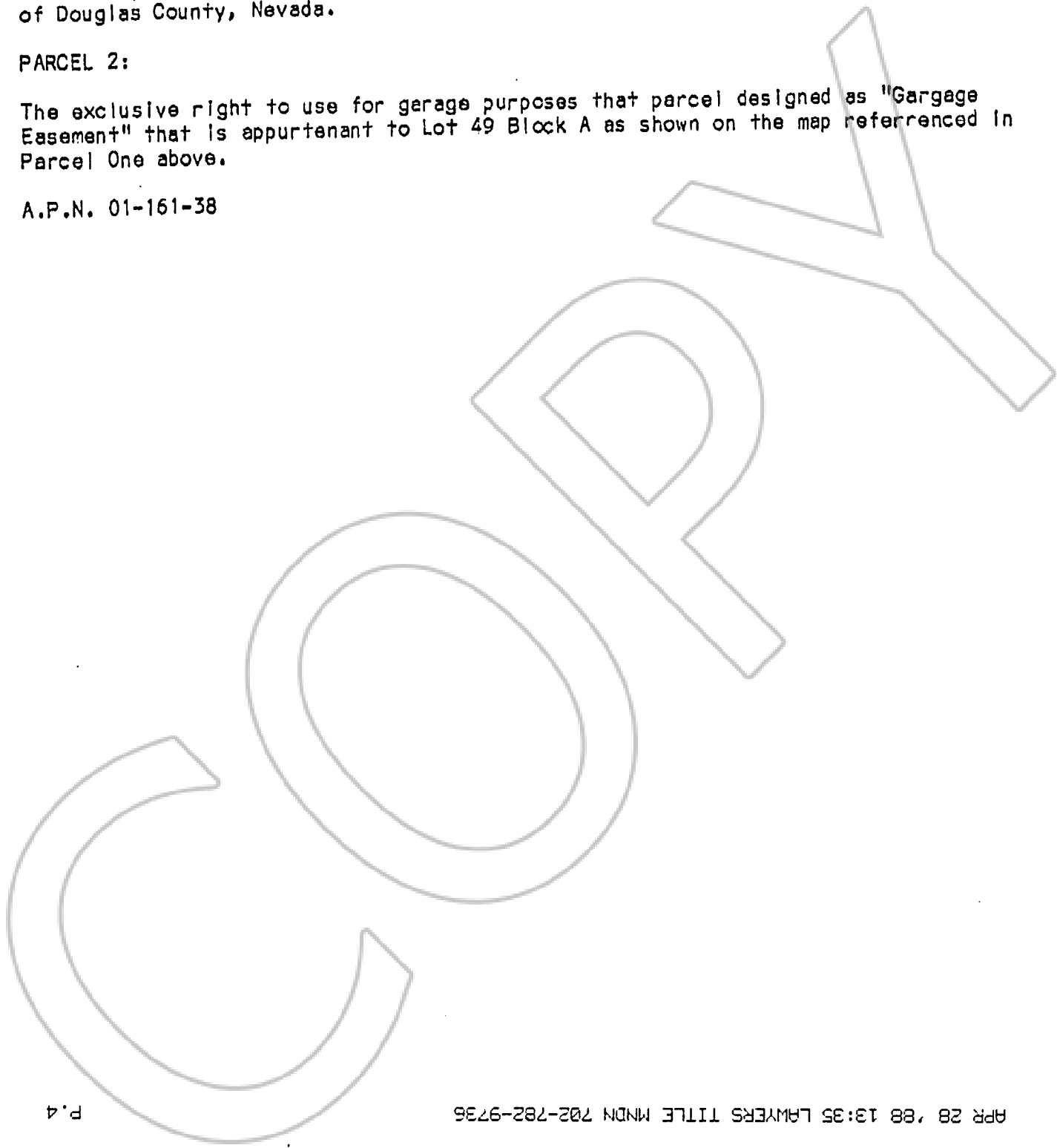

P.4

APR 28 '88 13:35 LAWYERS TITLE MNDN 702-782-9736

REQUESTED BY
WESTERN TITLE COMPANY, INC.

IN OFFICIAL RECORDS OF
DOUGLAS CO., NEVADA

'88 MAY 18 AIO:32

SUZANNE BEAUDREAU
RECORDER

\$ 6.00 PAID [Signature] DEPUTY

178304

BOOK 588 PAGE 2502