

◇ FOUND 5/8" REBAR WITH CAP AS PER PARCEL MAP DOCUMENT NO. 65498.

● SET 5/8" REBAR WITH CAP MARKED RLS 3090.

BASIS OF BEARINGS IS THE LINE BETWEEN FOUND POINTS WHICH BEARS S2°37'00"W AS PER PARCEL MAP DOCUMENT NO. 65498.

TO W. 1/4 SEC. 3
N71°49'36"W - 1,664.06'
TIE COMPUTED FROM RECORD
MAP 65498

TO U.S. 395 - INDUSTRIAL
N87°23'00"W
74.00'

CURVE DATA
Δ = 68°41'00"
R = 70.00'
T = 47.83'
L = 83.91'

S2°37'00"W
120.00'

S2°37'00"W
177.78'

SCHILLER
PARCEL

A = 1.000 ACRES
= 43,574 SQ. FT.

WAY - TO U.S. 395
N18°42'00"W
185.30'

221.74'
N71°18'00"E

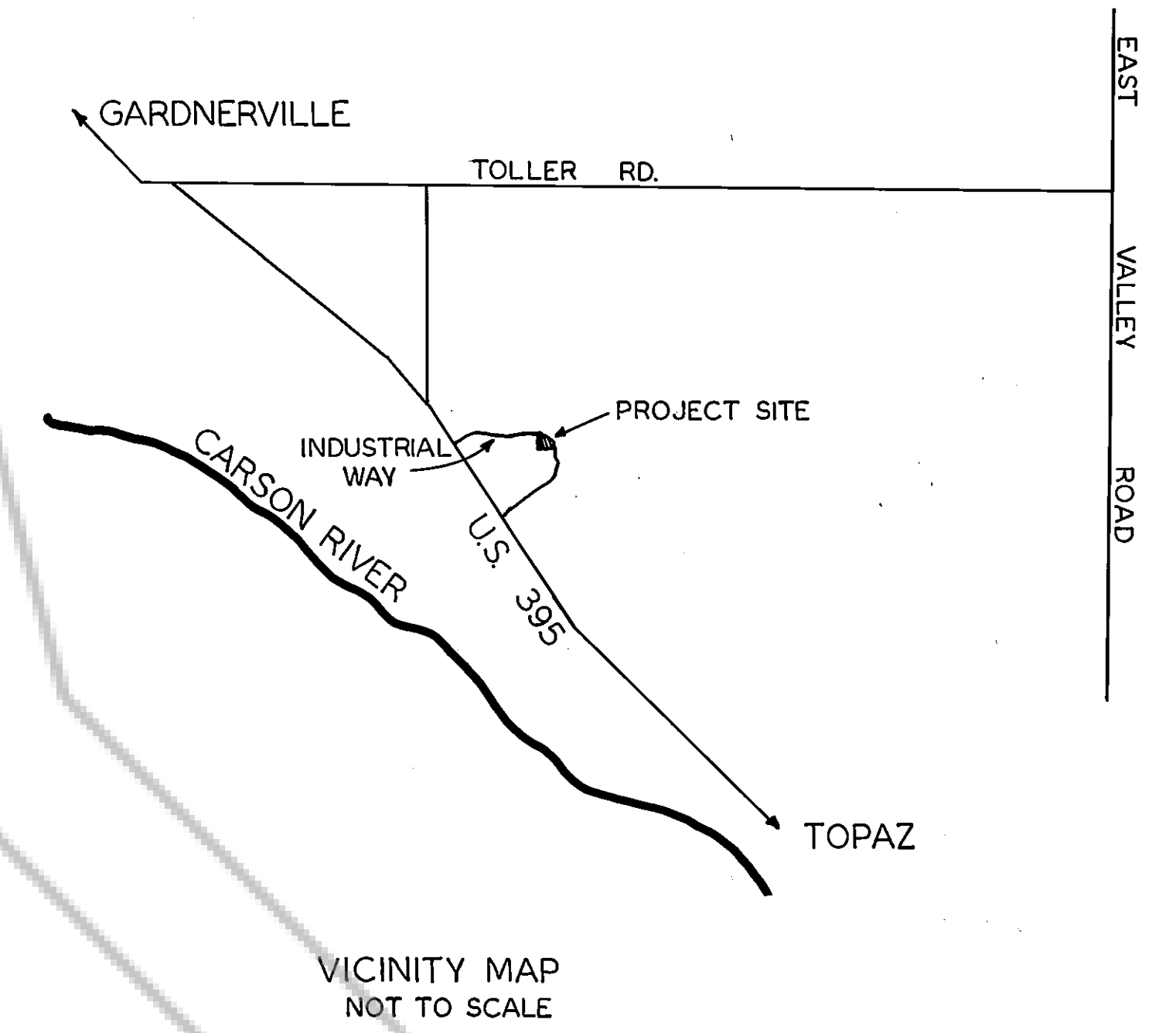
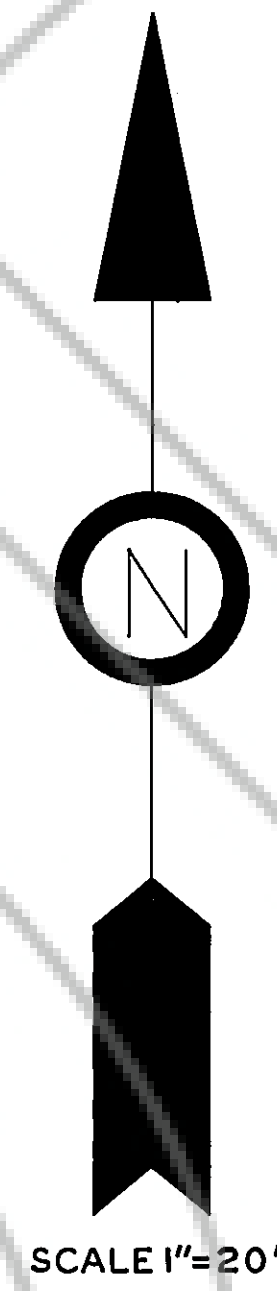

SURVEYOR'S CERTIFICATE

I, WYATT J. OWENS, A REGISTERED LAND SURVEYOR IN THE STATE OF NEVADA CERTIFY THAT:

1. THIS IS A TRUE AND ACCURATE REPRESENTATION OF THE LANDS SURVEYED UNDER MY SUPERVISION AT THE INSTANCE OF MICHEAL SCHILLER.
2. THE LAND SHOWN LIES WITHIN SECTION(S) 3 OF T. 12 N., R. 20 E., M.D.B.&M., AND THE SURVEY WAS COMPLETED ON NOVEMBER 18, 1989.
3. THIS MAP COMPLIES WITH THE APPLICABLE STATE STATUTES AND LOCAL ORDINANCES.
4. THE MONUMENTS ARE OF THE CHARACTER SHOWN AND OCCUPY THE POSITIONS INDICATED.

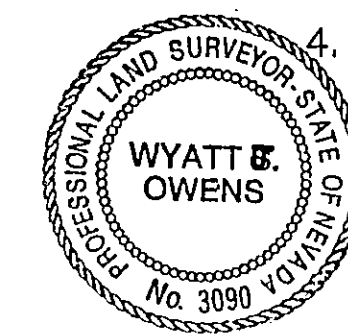

Wyatt J. Owens
WYATT J. OWENS, RLS 3090

RECORDER'S CERTIFICATE

FILED FOR RECORD THIS 18th DAY OF December, 1989 AT 38 MINUTES PAST 1 O'CLOCK P.M. IN BOOK 1229, PAGE 1911, DOCUMENT # 216692, IN THE OFFICIAL RECORDS OF Douglas COUNTY, NEVADA AT THE REQUEST OF WYATT J. OWENS.

Suzanne Beaudreau COUNTY RECORDER BY Camilla Kromberg DEPUTY

RECORD OF SURVEY
FOR
MICHEAL SCHILLER
WITHIN SECTION 3, T.12 N., R. 20 E., M.D.B.&M.
DOUGLAS COUNTY, NEVADA