

GRANT, BARGAIN, SALE DEED

THIS INDENTURE WITNESSETH: That LUCY C. JOYCE, an unmarried woman

in consideration of \$10.00, the receipt of which is hereby acknowledged, do hereby Grant, Bargain, Sell and Convey to PAT ROEDIGER AND JUDY ROEDIGER, husband and wife as joint tenants as to an undivided 1/2 interest and JANICE M. GOODWIN, an unmarried woman as to an undivided 1/2 interest

and to the heirs and assigns of such Grantee forever, all that real property situated in the County of DOUGLAS, State of Nevada, bounded and described as follows:

(Continued)

SEE EXHIBIT "A" ATTACHED HERETO AND INCORPORATED HEREIN BY REFERENCE

Together with all and singular the tenements, hereditaments and appurtenances thereunto belonging or in anywise appertaining, and any reversions, remainders, rents, issues or profits thereon.

Dated November 7, 1990

STATE OF NEVADA

County of DOUGLAS

On November 9, 1990 personally appeared before me, a Notary Public,

LUCY C. JOYCE who acknowledged that she executed the above instrument.

Notary Public

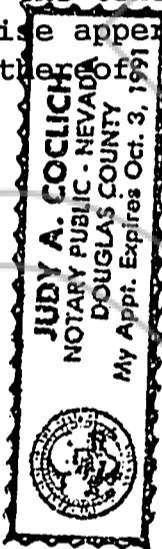

Signature of Lucy C. Joyce over a line, with the text LUCY C. JOYCE below it.

ESCROW NO. M49206JC

MANOUKIAN, SCARPELLO & ALLING, LTD. ATTORNEYS AT LAW 303 EAST PROCTOR ST. CARSON CITY, NEVADA 89701-4290 (702) 882-4577 P.O. BOX 3390 STATELINE, NEVADA 89449-3390 (702) 588-6676

The grantor(s) declare(s): Documentary transfer tax is \$33.00 (XX) computed on full value of property conveyed, or () computed on full value less value of liens and encumbrances remaining at the time of sale.

FOR RECORDER'S USE

MAIL TAX STATEMENTS :
SAME AS GRANTEE BELOW :
WHEN RECORDED MAIL TO: :
JOHN R. BURGMAN :
790A Wagon :
Gardnerville, NV 89410 :

240247

LEGAL DESCRIPTION (continued)

All that certain lot, piece or parcel of land situate in the County of Douglas, State of Nevada, described as follows:

A portion of the North 1/2 of the North 1/2 of the Northeast 1/4 of Section 24, Township 12 North, Range 20 East, M.D.B.&M., more particularly described as follows:

Parcel B1 as shown on the Parcel Map for Lucy Joyce #1, filed for record October 22, 1990, in Book 1090, Page 3218, as Document No. 237138, Official Records, Douglas County, Nevada, being a re-subdivision of Parcel B of the Parcel Map for Peter S. Bowie as Document No. 13230.

A portion of A.P.N. 29-462-09

RESERVING THEREFROM all water, water rights, ditch and ditch rights appurtenant to the herein described real property.

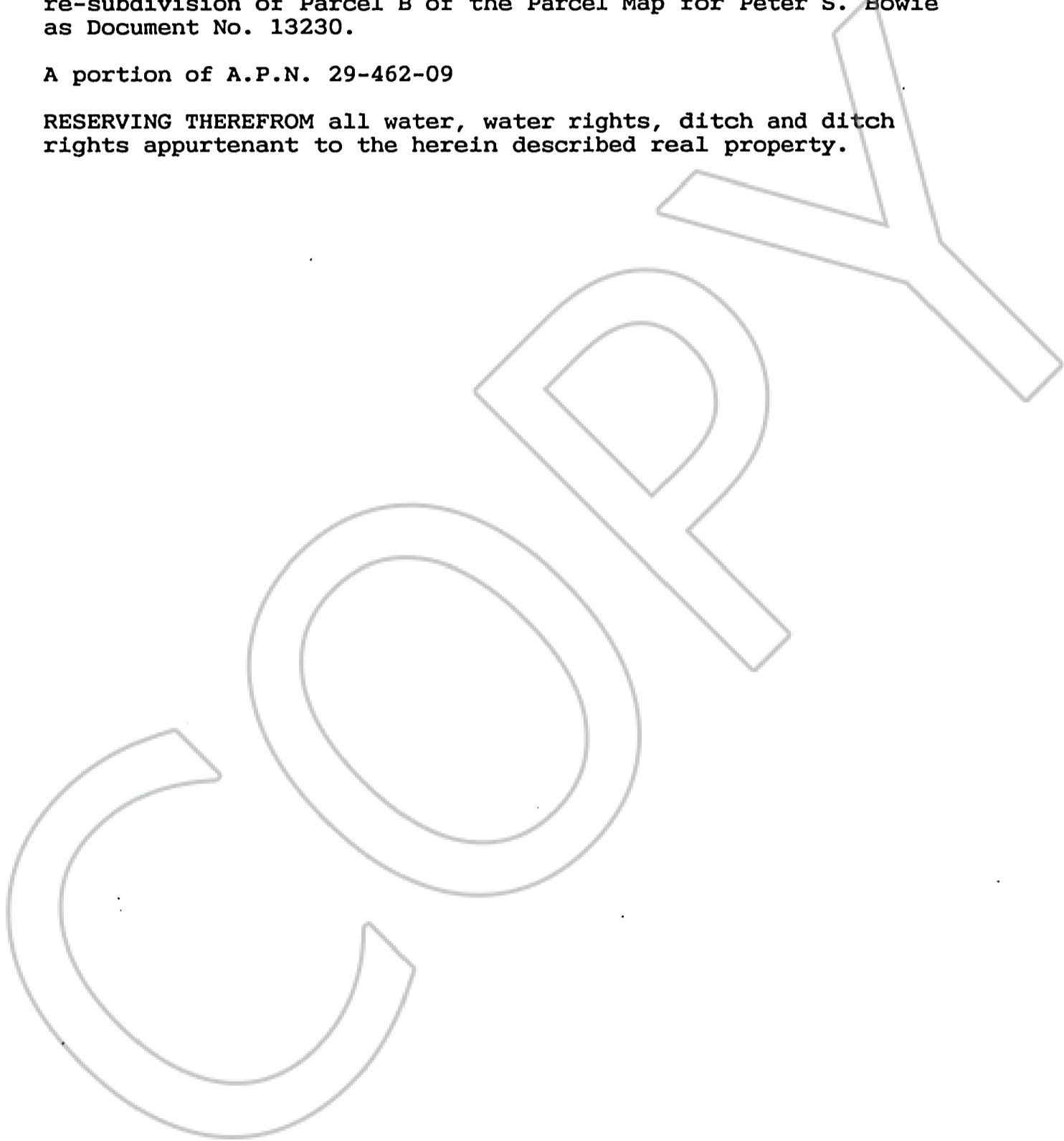

REQUESTED BY
WESTERN TITLE COMPANY, INC.
IN OFFICIAL RECORDS OF
DOUGLAS CO., NEVADA

'90 DEC -3 P4:11

SUZANNE BEAUDREAU 240247
RECORDER
\$6⁰⁰ PAID *K12* DEPUTY
BOOK 1290 PAGE 140