

Recorded at the request of:  
Douglas County Public Works  
P.O. Box 218  
Minden, Nevada 89423

December 10, 1990

Max C. Montgomery  
Douglas County Engineer  
P.O. Box 218  
Minden, NV 89423

RE: Certificate of Amendment  
Parcel Map #2 for Jerry E. Tilley  
Book 490, Page 1902, Document No. 223931

Dear Mr. Montgomery:

Pursuant to the provisions of NRS 278.473, we request the following be made to the sectional tie from the Southwest corner of Parcel 4D:

The section line is the centerline of Pinto Circle

This correction does not change the location of any survey monument, property line, or boundary line. When this certificate is recorded, we request a proper notation be placed on the original map according to the provisions of paragraph 3 of NRS 278.473.

Date: 29 NOV 1990

Surveyor: \_\_\_\_\_

B. J. Vasey

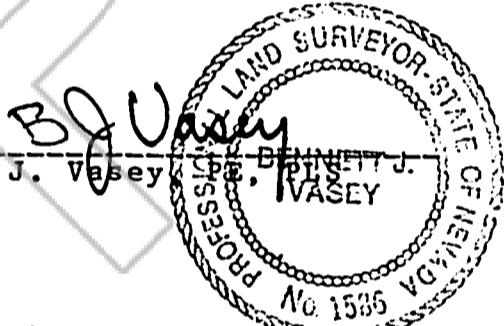

COUNTY ENGINEER'S CERTIFICATE

I hereby certify that I have examined the certificate of amendment and the changes to the original document specified therein are provided for in the applicable Sections of NRS 278.010 to 278.630, inclusive, NRS 625.340 to 625.380, inclusive, and the local ordinances adopted pursuant thereto, and I am satisfied that this certificate of amendment so amends the document as to make it technically correct.

Date: 1/30/91

County Engineer: \_\_\_\_\_

Max C. Montgomery

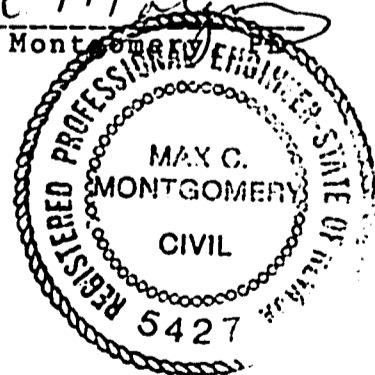

REQUESTED BY  
**DOUGLAS COUNTY**  
IN OFFICIAL RECORDS OF  
DOUGLAS CO., NEVADA

91 JAN 31 AM 1:13

SUZANNE BEAUDREAU  
RECORDER **243941**

PAID: \_\_\_\_\_ DEPUTY

BOOK **191** PAGE **3825**