

WHEN RECORDED MAIL TO:
Hansen
P.O. Box 705
San Fernando, Ca 91340

Order No.
Escrow No. M52930CH
R.P.T.T. 910.00
XX Based on full value
Based on full value
less liens

INDIVIDUAL GRANT DEED

THIS INDENTURE WITNESSETH:

That for a valuable consideration, receipt of which is hereby acknowledged, R.S.L., LTD., a Limited Partnership

(GRANTOR),
does hereby grant, bargain, sell, and convey to
JAMES B. HANSEN and ANNA L. HANSEN, HUSBAND AND WIFE AS JOINT TENANTS
LEE

(GRANTEE),
all that real property in the County of DOUGLAS, State of Nevada,
being Assessor's Parcel Number, specifically described as:

SEE EXHIBIT "A" ATTACHED HERETO AND MADE A PART HEREOF FOR LEGAL DESCRIPTION

Together with all and singular the tenements, hereditaments and appurtenances thereunto belonging or in anywise appertaining, and any reversions, remainders, rents, issues or profits thereof.

Dated November 23, 1992

STATE OF NEVADA

County of DOUGLAS)

On NOVEMBER 23, 1992)
before me, a notary public,)
personally appeared)

MICHAEL R. COLEMAN, GENERAL PARTNER
OF RSL, LTD, A LIMITED PARTNERSHIP
personally known or proved to
me to be the person(s) whose
name(s) subscribed to the
above instrument who ack-
nowledged that executed
the instrument.

RSL, LTD., A LIMITED PARTNERSHIP

BY: MICHAEL R. COLEMAN,

Michael R. Coleman

MAIL TAX STATEMENT TO:
SAME AS ABOVE

.....
FOR RECORDER'S USE

Charles L. Hanover
Notary Public

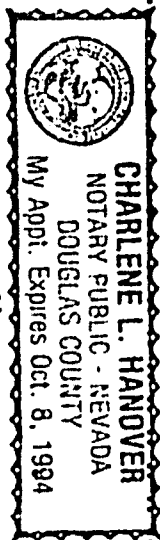

SCARPELLO & ALLING
CARSON CITY OFFICE
VALLEY BANK CENTER
600 WILLIAM STREET, SUITE 301
CARSON CITY, NEVADA 89701-4502
TELEPHONE (702) 882-4577

LAKE TAHOE OFFICE
KINGSBURY SQUARE
P.O. BOX 3390
STATELINE, NEVADA 89449-3390
TELEPHONE (702) 588-6676

LEGAL DESCRIPTION

DESCRIPTION

All that certain lot, piece or parcel of land situate in the County of Douglas, State of Nevada, described as follows:

PARCEL 1:

All of Lots 5, 6, 7, , as shown on Record of Survey for RSL Limited recorded November 10, 1982, in Book 1182, of Official Records, at Page 491, Douglas County, Nevada as Document No. 73079, being adjusted Lots 5, 6 and 7, as shown on the Map of C.E.S. Subdivision, recorded July 2, 1980, in Book 780, Page 100, as Document No. 45876 and Certificate of Amendment Recorded August 13, 1982, in book 882, Page 575, as Document No. 70146

A.P.N. 27-512-28
27-512-35
27-512-36

PARCEL 2:

Lots 8, 9 and 10, as set forth on Record of survey/lot line adjustment for RSL Limited, filed in the office of the County Recorder of Douglas County, State of Nevada, on March 15, 1982, in book 382, Page 860, Document No. 65802 of Official Records, being adjusted Lots 8, 9 and 10, Block 1, as shown on the map of C.E.S. Subdivision recorded July 2, 1980, in Book 780, Page 100, as Document No. 45876, and Certificate of Amendment Recorded August 13, 1982, in book 882, Page 575, as Document No. 70146.

A.P.N. 27-512-32
27-512-33
27-512-34

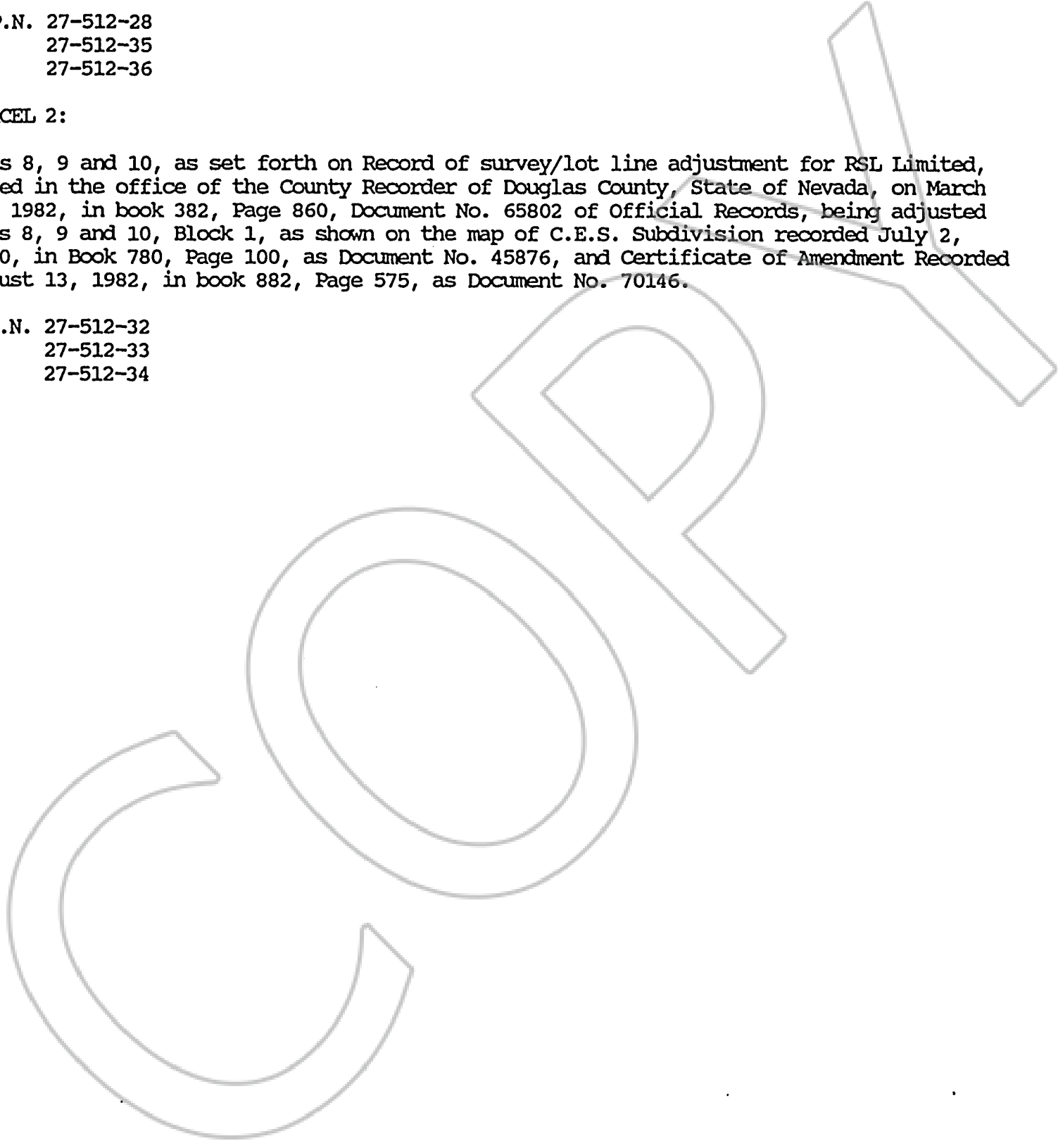

REQUESTED BY
WESTERN TITLE COMPANY, INC.
IN OFFICIAL RECORDS OF
DOUGLAS COUNTY, NEVADA

92 NOV 24 P3:45

CLERK OF COUNTY RECORDS
293947
\$6.00 PAID *PK* DEPUTY
BOOK 1192 PAGE 4436