

JOINT TENANCY DEED

THIS INDENTURE WITNESSETH: That

DOMENICK MELOCCHI AND JOAN LOUISE MELOCCHI, as Trustees of the DOMENICK MELOCCHI AND JOAN LOUISE MELOCCHI FAMILY TRUST DATED November 19, 1991

in consideration of the sum of TEN DOLLARS (\$10.00) lawful money of the United States, and other good and valuable consideration, the receipt of which is hereby acknowledged, do hereby Grant, Bargain, Sell and Convey to

DOMENICK MELOCCHI and JOAN LOUISE MELOCCHI, husband and wife, as joint tenants with right of survivorship, and not as tenants in common,

and to the heirs and assigns of such Grantee forever, all that real property situated in the County of DOUGLAS, State of Nevada, bounded and described as follows: AS PER LEGAL DESCRIPTION ATTACHED HERETO AND MADE A PART HEREOF MARKED "EXHIBIT A" Together with all and singular the tenements, hereditaments and appurtenances thereunto belonging or in anywise appertaining, and any reversions, remainders, rents, issues or profits thereof.

Witness our hands this 7th day of June, 1994.

Domenick Melocchi
DOMENICK MELOCCHI, TRUSTEE

Joan Louise Melocchi
JOAN LOUISE MELOCCHI, TRUSTEE

STATE OF NEVADA)
):SS
COUNTY OF DOUGLAS)

On June 7, 1994, personally appeared before me, a Notary Public, Domenick Melocchi, Trustee and Joan Louise Melocchi, Trustee

personally known or proved to me to be the persons whose names are subscribed to the above instrument who acknowledged that they executed the same for the purposes therein stated.

L. Hendrick
Notary Public



WHEN RECORDED MAIL TO:
DOMENICK MELOCCHI

The Grantor(s) declare(s): #8
Document Transfer Tax is \$0.00
(X) computed on full value less value of liens and encumbrances remaining at time of sale.

MAIL TAX STATEMENTS TO:
as shown above

"EXHIBIT A"

LEGAL DESCRIPTION

All that certain lot, piece or parcel of land situate in the County of Douglas, State of Nevada, described as follows:

Lot 2, Block A, as set forth on the Official Plat of MACKLAND SUBDIVISION, filed in the Office of the County Recorder on December 4, 1980, Book 1280, Page 475, Document No. 51372, and by Certificate of Amendment recorded November 7, 1984, Book 1184, Page 510, Document No. 109722, both of Official Records of Douglas County, Nevada.

Assessment Parcel No. 25-551-02.

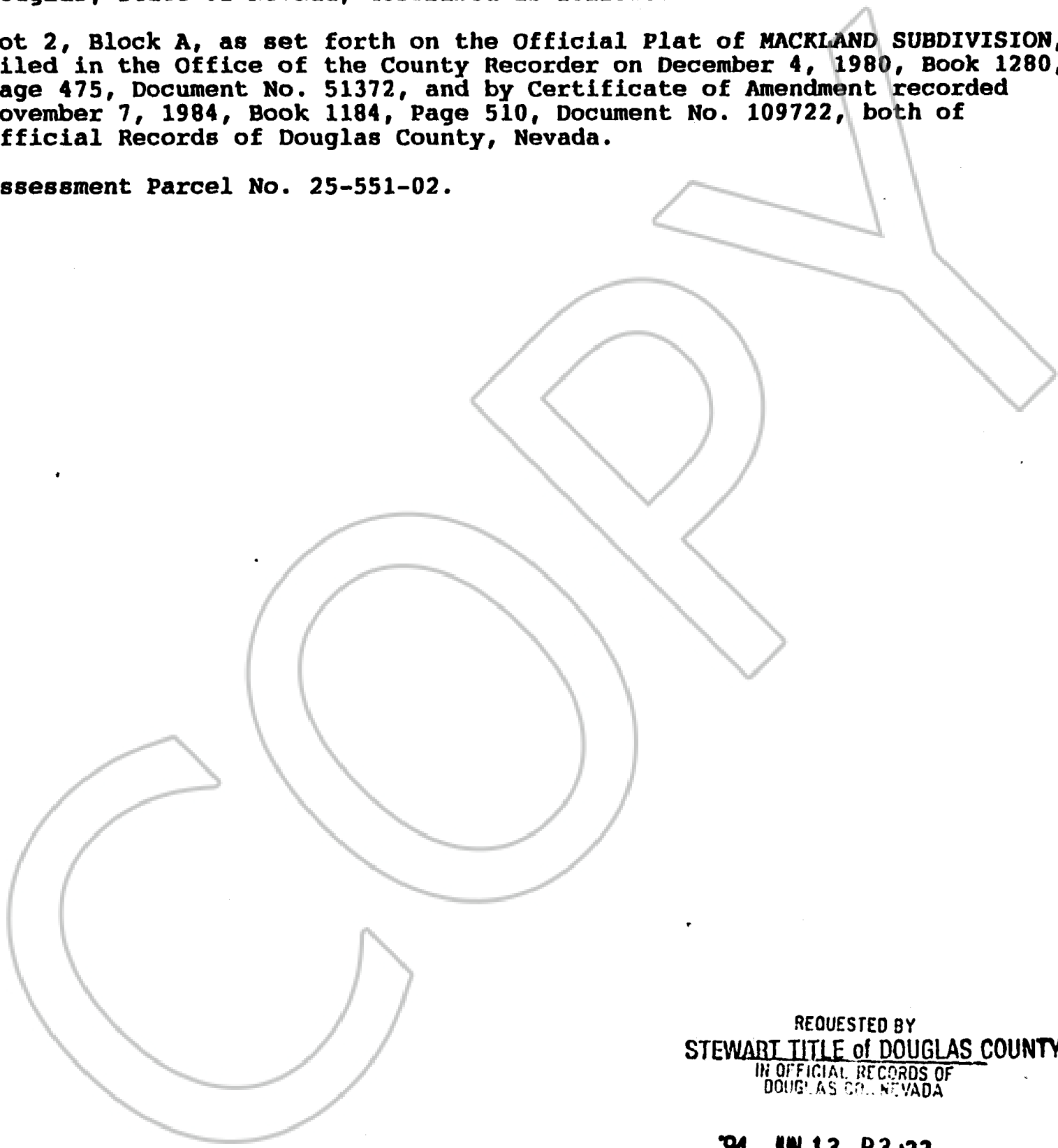

REQUESTED BY
STEWART TITLE of DOUGLAS COUNTY
IN OFFICIAL RECORDS OF
DOUGLAS CO., NEVADA

'94 JUN 13 P3:33

339584
BK0694PG2252

SUZANNE BEAUDREAU
RECORDER
\$ 8.00 PAID KZ DEPUTY