

RECORDING REQUESTED BY

AND WHEN RECORDED MAIL TO

Attn: Loan Services
 Santa Barbara Bank & Trust
 P.O. Box 1173
 Santa Barbara, CA 93102-1173

SPACE ABOVE THIS LINE FOR RECORDER'S USE

PARTIAL RECONVEYANCE

Recon #94-101-15

SANTA BARBARA BANK & TRUST, a California corporation, trustee under deed of trust executed by Western Nevada Properties, Inc., a Nevada Corporation as to Exhibit "A" and Leo Hanly, a Married man as his sole and separate property as to Exhibit "B", Trustor, dated June 6, 1994 and recorded as Instrument No. 339786, on June 16, 1994 in Book 0694, Pages 2798-2809 having been requested in writing, by the holder of the obligation secured by said deed of trust, to reconvey the estate granted to trustee under said deed of trust, in and to herein described property, and said Deed of Trust and note or notes secured thereby having been presented for endorsement, hereby reconveys, without warranty, to the person or persons legally entitled thereof, all estate now held by it thereunder in and to that property situated in Douglas County, Nevada, described as follows:

See legal description attached hereto and made part hereof marked Exhibit "C"

October 4, 1994

SANTA BARBARA BANK & TRUST
 a California corporation

By: Charlene Ray
 Charlene Ray, Assistant Vice President

By: B. Almeida
 B. Almeida, RE Loan Servicing Manager

Title/Escrow Company: Santa Barbara Bank & Trust, Loan Services

Order No.: Lot #273, A.P.N. 25-692-16

Loan No.: SBB&T 2085-13816

348741

BK 1094 PG 2901

Cam

CALIFORNIA ALL-PURPOSE ACKNOWLEDGMENT

State of California
County of Santa Barbara

On 10-6-94 before me, Helen K. Naval, Notary Public,
DATE NAME, TITLE OF OFFICER-E.G., "JANE DOE, NOTARY PUBLIC"

personally appeared Charlene Ray and B. Almeida
NAME(S) OF SIGNER(S)

personally known to me -OR- proved to me on the basis of satisfactory evidence to be the person(s) whose name(s) is/are subscribed to the within instrument and acknowledged to me that he/she/they executed the same in his/her/their authorized capacity(ies), and that by his/her/their signatures on the instrument the persons(s), or the entity upon behalf of which the person(s) acted, executed the instrument.

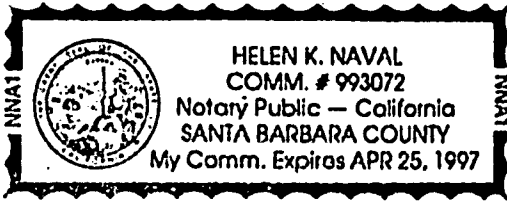

WITNESS my hand and official seal.

Helen K. Naval
SIGNATURE OF NOTARY

OPTIONAL

Though the data below is not required by law, it may prove valuable to persons relying on the document and could prevent fraudulent reattachment of this form.

CAPACITY CLAIMED BY SIGNER

- INDIVIDUAL
 CORPORATE OFFICER
Assistant Vice President and
RE Loan Servicing Manager
TITLE(S)

- PARTNERS LIMITED
 GENERAL

- ATTORNEY-IN-FACT
 TRUSTEE(S)
 GUARDIAN/CONSERVATOR
 OTHER: _____

SIGNER IS REPRESENTING:
NAME OF PERSON(S) OR ENTITY(IES)

Santa Barbara Bank & Trust,
a California corporation, Trustee

DESCRIPTION OF ATTACHED DOCUMENT

PARTIAL RECONVEYANCE
TITLE OR TYPE OF DOCUMENT

NUMBER OF PAGES

October 4, 1994
DATE OF DOCUMENT

Western Nevada
REFERENCE

348741

BK 1094 PG 2902

EXHIBIT "C"

All that certain lot, piece or parcel of land situate in the County of Douglas, State of Nevada, described as follows:

Unit 273 as set forth on the Official Plat of WINHAVEN UNIT NO. 4, PHASE A, a Planned Unit Development filed for record in the Office of the County Recorder, of Douglas County, State of Nevada, on August 19, 1993 as Document No. 315526.

Assessors Parcel No. 25-692-16

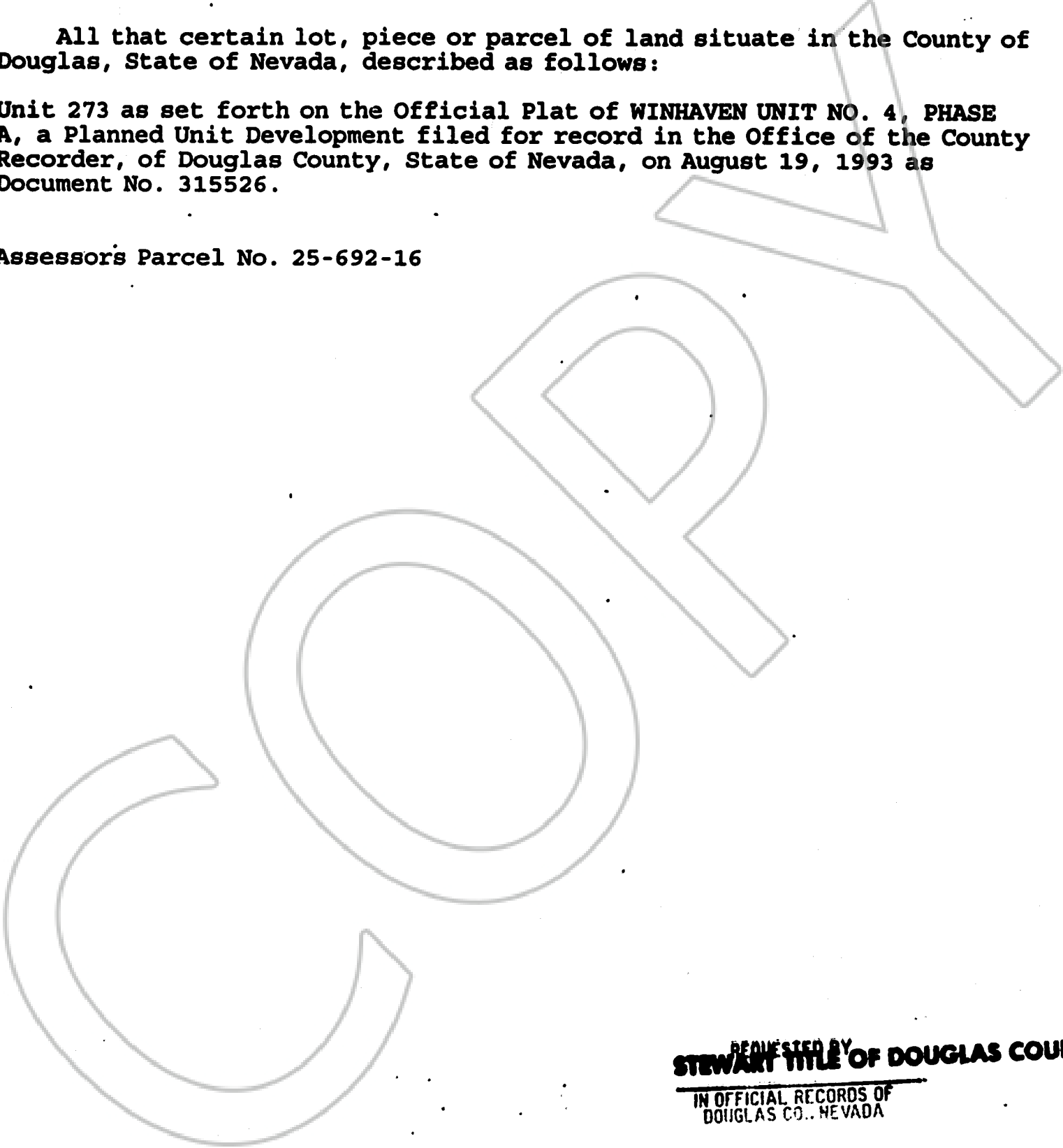

REQUESTED BY
STEWART TITLE OF DOUGLAS COUNTY
IN OFFICIAL RECORDS OF
DOUGLAS CO., NEVADA

94 OCT 18 AM 0:21

348741
BK 1094 PG 290.3

SUZANNE BLAUDREAU
RECORDER
\$ 9.00 PAID *OK* DEPUTY