

94010647

RECORDING REQUESTED BY

AND WHEN RECORDED MAIL TO
Attn: Loan Services
Santa Barbara Bank & Trust
P.O. Box 1173
Santa Barbara, CA 93102-1173

SPACE ABOVE THIS LINE FOR RECORDER'S USE

PARTIAL RECONVEYANCE

Recon #94-101-19

SANTA BARBARA BANK & TRUST, a California corporation, trustee under deed of trust executed by Western Nevada Properties, Inc., a Nevada Corporation as to Exhibit "A" and Leo Hanly, a Married man as his sole and separate property as to Exhibit "B", Trustor, dated June 6, 1994 and recorded as Instrument No. 339786, on June 16, 1994 in Book 0694, Pages 2798-2809 having been requested in writing, by the holder of the obligation secured by said deed of trust, to reconvey the estate granted to trustee under said deed of trust, in and to herein described property, and said Deed of Trust and note or notes secured thereby having been presented for endorsement, hereby reconveys, without warranty, to the person or persons legally entitled thereof, all estate now held by it thereunder in and to that property situated in Douglas County, Nevada, described as follows:

See legal description attached hereto and made part hereof marked Exhibit "C"

October 4, 1994

SANTA BARBARA BANK & TRUST
a California corporation

By: Charlene Ray
Charlene Ray, Assistant Vice President

By: B. Almeida
B. Almeida, RE Loan Servicing Manager

Title/Escrow Company: Santa Barbara Bank & Trust, Loan Services
Order No.: Lot #173, A.P.N. 25-702-19
Loan No.: SBB&T 2085-13816

LJM

348750
BK 1094PG2927

CALIFORNIA ALL-PURPOSE ACKNOWLEDGMENT

State of California
County of Santa Barbara

On 10-6-94 before me, Helen K. Naval, Notary Public,
DATE NAME, TITLE OF OFFICER-E.G., "JANE DOE, NOTARY PUBLIC"

personally appeared Charlene Ray and B. Almeida
NAME(S) OF SIGNER(S)

personally known to me -OR- proved to me on the basis of satisfactory evidence to be the person(s) whose name(s) is/are subscribed to the within instrument and acknowledged to me that he/she/they executed the same in his/her/their authorized capacity(ies), and that by his/her/their signatures on the instrument the persons(s), or the entity upon behalf of which the person(s) acted, executed the instrument.

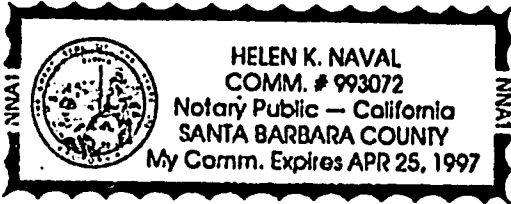

WITNESS my hand and official seal.

Helen K. Naval

SIGNATURE OF NOTARY

OPTIONAL

Though the data below is not required by law, it may prove valuable to persons relying on the document and could prevent fraudulent reattachment of this form.

CAPACITY CLAIMED BY SIGNER

DESCRIPTION OF ATTACHED DOCUMENT

INDIVIDUAL
 CORPORATE OFFICER
Assistant Vice President and
RE Loan Servicing Manager
TITLE(S)

PARTIAL RECONVEYANCE
TITLE OR TYPE OF DOCUMENT

PARTNERS LIMITED
 GENERAL

NUMBER OF PAGES

ATTORNEY-IN-FACT
 TRUSTEE(S)
 GUARDIAN/CONSERVATOR
 OTHER: _____

October 4, 1994
DATE OF DOCUMENT

SIGNER IS REPRESENTING:
NAME OF PERSON(S) OR ENTITY(IES)

Western Nevada
REFERENCE

Santa Barbara Bank & Trust,
a California corporation, Trustee

ATTACHED TO PARTIAL RECONVEYANCE
WESTERN NEVADA PROPERTIES, INC.

EXHIBIT "C"

All that certain lot, piece or parcel of land situate in the County of Douglas, State of Nevada, described as follows:

Unit 173 as shown on the Official Plat of WINHAVEN UNIT NO. 5, filed for record in the Office of the County Recorder, of Douglas County, Nevada, on February 10, 1994 in Book 294 of Official Records at page 1845, as Document No. 329790.

Assessors Parcel No. 25-702-19

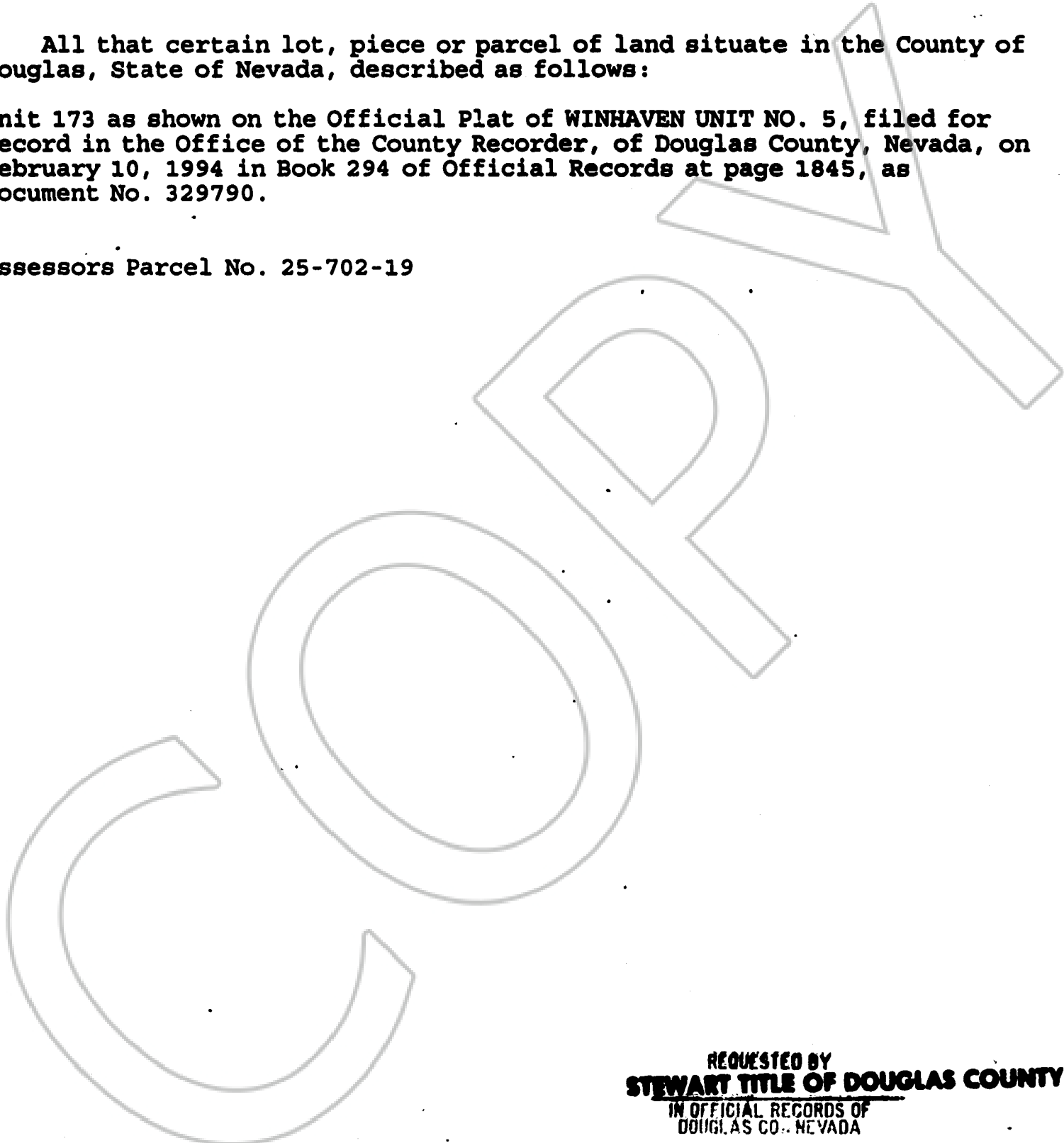

REQUESTED BY
STEWART TITLE OF DOUGLAS COUNTY
IN OFFICIAL RECORDS OF
DOUGLAS CO., NEVADA

'94 OCT 18 AM 0:36

348750
BK 1094 PG 2929

SUZANNE BEAUDREAU
RECORDER
\$9.00 PAID *[Signature]* DEPUTY