

16

**DECLARATION OF COVENANTS, CONDITIONS
AND RESTRICTIONS**

BEING A DEED RESTRICTION FOR LOT CONSOLIDATION

This declaration is made this 23 day of May, 1995, by Mulreany Associates, a Nevada general partnership, (hereinafter referred to as "declarant").

RECITALS:

1. Declarant is the owner of that certain real property located in Douglas County, State of Nevada, described as follows:

See "Exhibit A" attached

A.P.N. 25-170-21, 25-170-22, 25-170-24 and 25-170-25

2. Declarant has constructed facilities that encroach upon the common interior lot line of the parcels.

3. That pursuant to Douglas County Ordinances and the Uniform Building Code the parcels are to be treated as if legally merged.

DECLARATION:

Declarant hereby declares that the certain real property described above is, and shall be deemed by Douglas County to be merged and shall constitute but one contiguous, inseparable parcel.

This declaration shall be deemed a covenant running with the land or as an equitable servitude, as the case may be, and shall constitute benefits and burdens to the parcels described above and shall be binding on the declarant and declarant's assigns and all persons hereafter acquiring or owning any interest in the above described parcels.

This declaration may not be revoked or modified without the prior express written and recorded consent of Douglas County, Nevada. Douglas County is deemed and agreed to be a third party beneficiary of this declaration and as such can enforce the provisions of the declaration.

In witness whereof declarant has executed this declaration on the date and year written above.

MULREANY ASSOCIATES, a Nevada general partnership

BY: PATRICK A. MULREANY, General Partner



BY: JEAN E. MULREANY, General Partner

STATE OF NEVADA)
 : SS
COUNTY OF DOUGLAS)

On May 23, 1995, before me, the undersigned, a Notary Public in and for said County and State, personally appeared PATRICK A. MULREANY and JEAN E. MULREANY, known to me to be the persons whose names are subscribed to the within instrument and acknowledged that they executed the same.

Debra S. Porter
Notary Public

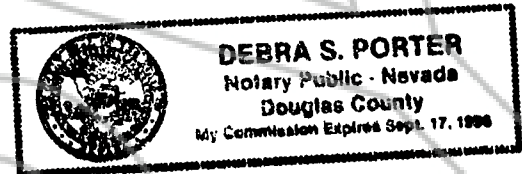
When Recorded Mail To:



James M. O'Reilly, Attorney at Law
317 South Sixth Street, Las Vegas, Nevada 89101-5806 (702) 477-7517
1463 Highway 395 North, Suite 102, Gardnerville, Nevada 89410-8968 (702) 782-3647

363455

Page 3

BK0695PG0523

LEGAL DESCRIPTION

The land referred to herein is situated in the State of Nevada County of Douglas, described as follows:

PARCEL 1:

A parcel of land situate in the Town of Minden, Nevada, and being a portion of the Southwest 1/4 of Section 29, Township 13 North, Range 20 East, M.D.B. & M., Douglas County, Nevada, being more particularly described as follows:

BEGINNING at a point lying on the Northerly right-of-way of U.S. Highway 395 being the Southwest corner of a 3.40 acre parcel as shown on the Record of Survey map filed in Book 980, Page 057, Document No. 48058, within the Official Records of Douglas County, Nevada; thence North 26°35'00" East, 120 feet to the POINT OF BEGINNING; thence North 26°35'00" East, 187.77 feet; thence South 63°25'00" East, 585.96 feet; thence South 79°00'00" West, 307.86 feet; thence North 63°25'00" West, 342.00 feet to the TRUE POINT OF BEGINNING.

Together with a parcel of land as deeded to PATRICK A. MULREANY AND JEAN E. MULREANY, in Deed recorded August 17, 1984 as Document No. 105270, more particularly described as follows:

A parcel of land located within a portion of the Southwest 1/4 of Section 29, Township 13 North, Range 20 East, M.D.B. & M., Douglas County, Nevada being further described as Area "B" as shown on the map filed within the Official Records of Douglas County, Nevada as Document No. 86414 and being more particularly descibed as follows:

Commencing at a point lying at the intersection of the Northerly right-of-way line of U.S. Highway 395 and the Westerly right-of-way line of 8th Street; thence North 26°35'00" East, 154.05 feet along the Westerly right-of-way line of 8th Street; thence North 79°00'00" East, 58.44 feet to the POINT OF BEGINNING, thence North 79°00'00" East, 96.79feet; thence South 26°35'00" West, 59.04 feet to a point on the Northerly right-of-way line of the 8th Street; thence North 63°25'00" West, 76.70 feet to the TRUE POINT OF BEGINNING.

Excepting therefrom a parcel of land located within a portion of the Southwest 1/4 of Section 29, Township 13 North, Range 20 East, M.D.B. & M., Douglas County, Nevada, being further described as Area "A" as shown on the map filed within the Official Records of Douglas County, Nevada as Document No. 86414 and being more particularly described as follows:

Commencing at a point lying at the intersection of the Northerly right-of-way line of U.S. Highway 395 and the Westerly right-of-way line of 8th Street; thence North 26°35'00" East, 154.05 feet along the Westerly right-of-way line of 8th Street; thence North 79°00'00" East, 155.23 feet to the POINT OF

BEGINNING; thence North 26°35'00" East, 59.03 feet; thence South 63°25'00" East, 76.71 feet; thence South 79°00'00" West, 96.80 feet to the TRUE POINT OF BEGINNING.

Assessor's Parcel No. 25-170-21.

PARCEL 2:

Portion A:

A parcel of land situated in the Southwest 1/4 of Section 29 and a portion of the Southeast 1/4 of Section 30, Township 13 North, Range 20 East, M.D.B. & M., Douglas County, Nevada, more particularly described as follows:

Beginning at the Northwest corner of a 2.00 acre more or less parcel as set forth on that certain Record of Survey for Patrick A. and Jean E. Mulreany, filed for record in the Office of the County Recorder of Douglas County, Nevada on the 2nd day of September, 1983, in Book 983 at Page 101, Document No. 86414; said point also bears North 28°02'03" East, a distance of 1,221.56 feet from the section corner common to Sections 29, 30, 31, and 32; thence South 26°35'00" West, a distance of 187.77 feet; thence North 63°25'00" West, a distance of 98.23 feet; thence North 16°53'00" East, a distance of 214.60 feet; thence North 63°25'00" West, a distance of 86.00 feet; thence South 16°53'00" West, a distance of 214.60 feet; thence North 63°25'00" West, a distance of 368.97 feet; thence South 00°03'20" West, a distance of 139.71 feet to the Northeasterly right-of-way line of U.S. Highway 395; thence North 63°25'00" West along the Northeasterly right-of-way line of U.S. Highway 395 a distance of 45.20 feet; thence North 05°41'00" East, a distance of 412.40 feet to the Section line common to Sections 29 and 30; thence North 00°03'20" East along the section line common to Sections 29 and 30, a distance of 57.04 feet; thence South 72°39'07" East, a distance of 449.37 feet; thence South 62°50'16" East, a distance of 265.06 feet; thence South 26°35'00" West, a distance of 192.97 feet, returning to THE TRUE POINT OF BEGINNING.

EXCEPT THEREFROM THE FOLLOWING DESCRIBED PARCELS OF LAND:

EXCEPTING THEREFROM a parcel of land located within a portion of the Southwest 1/4 of Section 29, Township 13 North, Range 20 East, M.D.B. & M., Douglas County, Nevada, described as follows:

Commencing at the Northwest corner of the 2.00 acre more or less parcel as set forth on that certain Record of Survey for Patrick A. and Jean E. Mulreany, that was filed for record in

363455

BK0695PG0525

the Office of the County Recorder of Douglas County, Nevada, on September 2, 1983, in Book 983, at Page 101, under Document No. 86414, thence North 26°35'00" East, 192.97 feet; thence North 62°50'16" West, 265.06 feet; thence North 72°39'07" West, 8.06 feet, to the POINT OF BEGINNING; thence continuing North 72°39'07" West, 439.37 feet; thence South 00°16'26" West, 56.63 feet; thence South 05°54'44" West, 412.40 feet to the Northerly right-of-way line of U.S. Highway 395 (Railroad Avenue); thence South 63°25'00" East, 188.00 feet along the Northerly right-of-way line of U.S. Highway 395; thence North 26°35'00" East, 125.00 feet; thence South 63°25'00" East, 75.00 feet; thence North 26°35'00" East, 382.12 feet to the TRUE POINT OF BEGINNING.

EXCEPTING THEREFROM that portion deeded to Mulreany Associates, a Limited Partnership, by instrument recorded April 29, 1985, in Book 485 of Official Records, at page 2305, Douglas County, Nevada, as Document No. 116605, more particularly described as follows:

A parcel of land located in the Southwest 1/4 of the Southwest 1/4 of Section 29, Township 13 North, Range 20 East, M.D.B. & M., situated on the Northerly side of U.S. Highway 395 and West of the Westerly line of 10th Street extended across the highway, in Douglas County, Nevada, more particularly described as follows:

Beginning at the intersection of the Northerly right-of-way line of U.S. Highway 395 and the extension of the Westerly line of 10th Street in Minden, from which the Southeast corner of Section 30, Township 13 North, Range 20 East, M.D.B. & M., bears 07°20'31" West, 962.14 feet; thence along the highway North 63°25'00" West, 188.00 feet; thence North 05°37'32" East, 133.85 feet; thence South 63°25'00" East, 235.88 feet; thence South 26°35'00" West, 125.00 feet to the TRUE POINT OF BEGINNING.

EXCEPTING THEREFROM that portion that lies within the above described Parcel and was deeded to HENRY SEEMAN, et al, in Deed recorded February 11, 1971, in Book 83, Page 593, Document No. 51865, Official Records of Douglas County, State of Nevada, described as follows:

That certain irregular Parcel of land situate, lying and being in the East 1/2 of the Southeast 1/4 of Section 30, Township 13 North, Range 20 East, M.D.B. & M., Westerly of the Town of Minden, in Douglas County, Nevada, more particularly described as follows:

Beginning at the concrete monument which is 30 feet Northeasterly, measured at right angles, from the Surveyed centerline of Nevada State Highway Route 3 (U.S. Highway 395), and along the Northerly extension of the Westerly side of 10th Street of said Town of Minden; said concrete monument further described as being North 07°20' East, a distance of 962.20 feet from the Southeast corner of said Section 30; thence North 63°25' West, along the Northeasterly right-of-way line of said highway a distance of 142.80 feet to the TRUE POINT OF BEGINNING; thence North 63°25' West, along the Northeasterly highway right-of-way line, a distance of 45.20 feet to a point; thence Northerly and Easterly along a fence line a distance of 412.40 feet, more or less, to a point; thence South a distance of 430.60 feet to the POINT OF BEGINNING.

Portion B:

A parcel of land located within a portion of the Southwest 1/4 of Section 29, Township 13 North, Range 20 East, M.D.B. & M., Douglas County, Nevada, described as follows:

Commencing at the Northwest corner of the 2.00 acre more or less parcel as set forth on that certain Record of Survey for Patrick A. and Jean E. Mulreany, that was filed for record in the Office of the County Recorder of Douglas County, Nevada, on September 2, 1983, in Book 983, at Page 101, as Document No. 86414, thence North 26°35'00" East, 192.97 feet; thence North 62°50'16" West, 265.06 feet; thence North 72°39'07" West, 8.06 feet, to the TRUE POINT OF BEGINNING; thence continuing North 72°39'07" West, 439.37 feet; thence South 00°16'26" West, 56.63 feet; thence South 05°54'44" West, 412.40 feet to the Northerly right-of-way line of U.S. Highway 395 (Railroad Avenue); thence South 63°25'00" East, 188.00 feet along the Northerly right-of-way line of U.S. Highway 395; thence North 26°35'00" East, 125.00 feet; thence South 63°25'00" East, 75.00 feet; thence North 26°35'00" East, 382.12 feet to the POINT OF BEGINNING.

EXCEPTING THEREFROM that portion deeded to Mulreany Associates, a Limited Partnership, by instrument recorded April 29, 1985, in Book 485 of Official Records, at Page 2305, Douglas County, Nevada, as Document No. 116605, more particularly described as follows:

A parcel of land located in the Southwest 1/4 of the Southwest 1/4 of Section 29, Township 13 North, Range 20 East, M.D.B. & M., situated on the Northerly side of U.S. Highway 395 and West of the Westerly line of 10th Street extending across the highway, in Douglas County, Nevada, more particularly described

363455

BK0695PG0527

as follows:

Beginning at the intersection of the Northerly right-of-way line of U.S. Highway 395 and the extension of the Westerly line of 10th Street in Minden, from which the Southeast corner of Section 30, Township 13 North, Range 20 East, M.D.B. & M., bears South 07°20'31" West, 962.14 feet; thence along the highway North 63°25'00" West, 188.00 feet; thence North 05°37'32" East, 133.85 feet; thence South 63°25'00" East, 235.88 feet; thence South 26°35'00" West, 125.00 feet to the POINT OF BEGINNING.

EXCEPTING THEREFROM that portion that lies within the above described Parcel and was deeded to HENRY SEEMAN, et al, in Deed recorded February 11, 1971, in Book 83, Page 593, Document No. 51865, Official Records of Douglas County, State of Nevada, described as follows:

That certain irregular Parcel of land situate, lying and being in the East 1/2 of the Southeast 1/4 of Section 30, Township 13 North, Range 20 East, M.D.B. & M., Westerly of the Town of Minden, in Douglas County, Nevada, more particularly described as follows:

Beginning at a concrete monument which is 30 feet Northeasterly, measured at right angles, from the surveyed centerline of Nevada State Highway Route 3 (U.S. Highway 395), and along the Northerly extension of the Westerly side of 10th Street of said Town of Minden; said concrete monument further described as bearing North 07°20' East, a distance of 962.20 feet from the Southeast corner of said Section 30; thence North 63°25' West, along the Northeasterly right-of-way line of said highway a distance of 142.80 feet to the TRUE POINT OF BEGINNING; thence North 63°25' West, along the Northeasterly highway right-of-way line a distance of 45.20 feet to a point near a fence corner; thence Northerly and Easterly along a fence line a distance of 412.40 feet, more or less, to a point; then South a distance of 430.60 feet to the POINT OF BEGINNING.

Portion C:

A parcel of land located within a portion of the Southwest 1/4 of Section 29, Township 13 North, Range 20 East, M.D.B. & M., Douglas County, Nevada, described as follows:

Commencing at the Northwest corner of the 3,000 acre more or less parcel as set forth on that certain Record of Survey for Patrick A. and Jean E. Mulreany, that was filed for record in the Office of the County Recorder of Douglas County, Nevada, on September 2, 1983, in Book 983, at Page 101, as Document No.

86414, thence North 26°35'00" East, 192.97 feet; thence South 63°25'00" East, 720.06 feet; thence South 32°38'00" West, 98.28 feet; thence North 63°25'00" West, 47.70 feet; thence South 26°35'00" West, 36.71 feet; thence South 79°00'00" West, 95.96 feet; thence North 63°25'00" West, 585.96 feet, to the POINT OF BEGINNING.

Assessor's Parcel No. 25-170-24.

PARCEL 3:

Being all that certain land or parcel of land lying in the Southwest 1/4 of Section 29, Township 13 North, Range 20 East, M.D.B. & M. on the Northerly side of the Virginia and Truckee Railroad Spur (bearing North 63°25' West), Douglas County, Nevada, and more particularly described by metes and bounds as follows, to wit:

Beginning at a point at the Southeast corner of the parcel 45 feet from the centerline of the said Virginia and Truckee Railroad Spur, said POINT OF BEGINNING being described as bearing North 57°47'40" West, 1,899.13 feet from the Town Monument (No. 1) to the Town of Minden, said POINT OF BEGINNING being further described as bearing North 72°33' East, 3,189.40 feet from the 1/4 corner common to Sections 30 and 31, being North 63°25' West parallel to the railroad spur 86.00 feet to a point; thence North 16°53' East, 214.60 feet to a point; thence South 63°25' East, 86.00 to a point on the fence line at the Northeast corner of the parcel thence South 16°53' West along said fence line 214.60 feet to the POINT OF BEGINNING.

Assessor's Parcel No. 25-170-25.

PARCEL 4

A parcel of land in the Town of Minden, North of U.S. Highway 395, and West of Buckeye Lane (Sixth Street), and also being in the South 1/2 of the Southwest 1/4 of Section 29, Township 13 North, Range 20 East, M.D.B.&M., in Douglas County, Nevada, more particularly described as follows:

COMMENCING at the Northwest corner of the intersection of Buckeye Lane and U.S. Highway 395 from which the Minden Town Monument bears South 58°06'23" East 713.05 feet. The Town Monument being located South 89°18'25" West, 4,649.90 feet from the one-quarter corner common to Sections 30 and 31, Township 13 North Range 20 East, M.D.B.&M., thence running along the Northerly side of U.S. Highway 395, North 63°25' West, 1,423.40 feet to the Point of Beginning; thence North 26°35' East 120.00 feet; thence South

363455

BK0695PG0529

Order No. 95050716

left, having a radius of 110.00 feet, throughout a central angle of 52° 25', an arc length of 100.63 feet; thence South 26° 35' West, a distance of 72.36 feet; thence along a tangent curve to the right, having a radius of 10.00 feet, throughout a central angle of 90°, an arc length of 15.71 feet to the TRUE POINT OF BEGINNING.

Assessors Parcel No. 25-170-22.

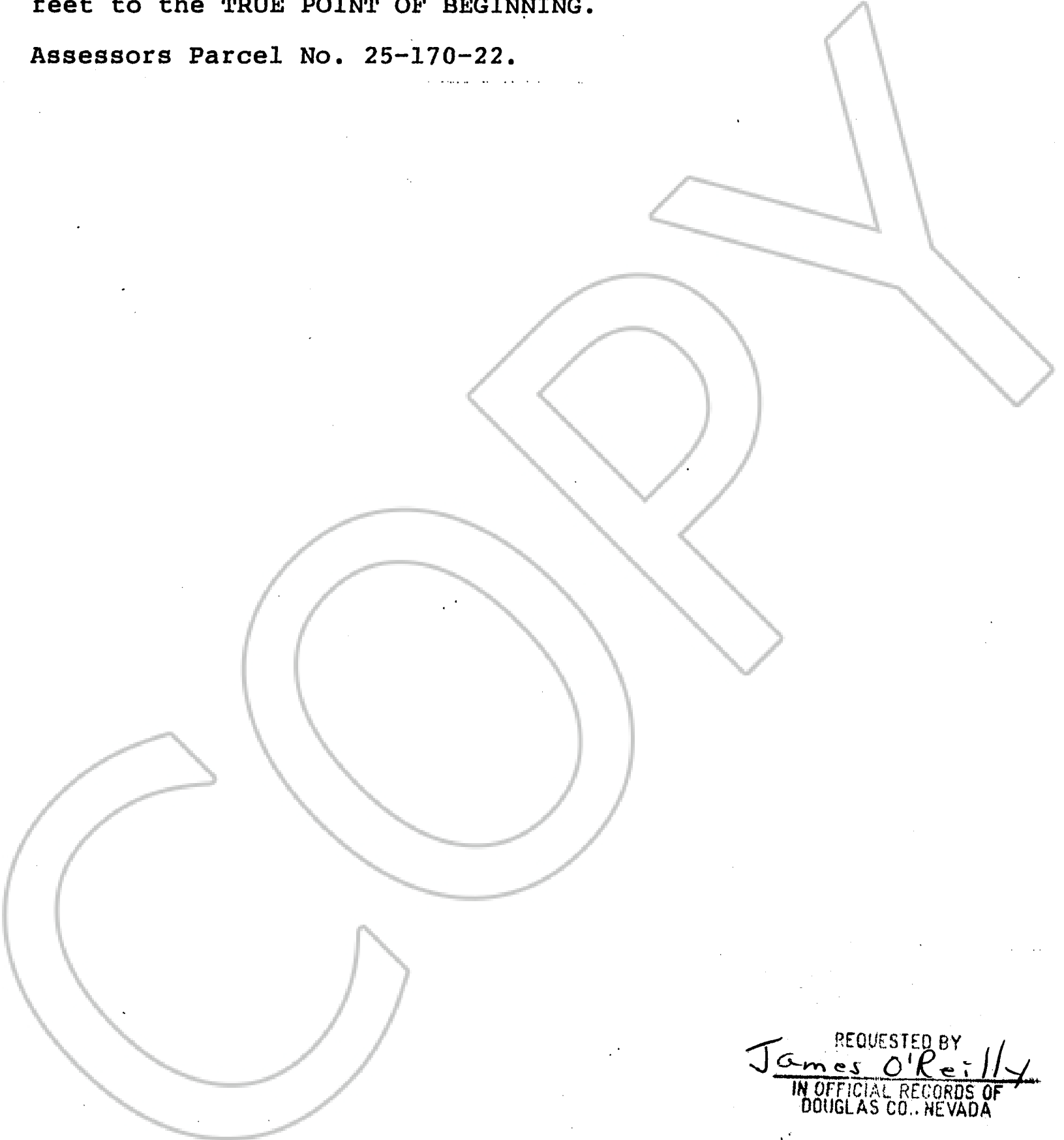

REQUESTED BY
James O'Reilly
IN OFFICIAL RECORDS OF
DOUGLAS CO., NEVADA

'95 JUN -5 AM 1:05

LINDA SLATER
RECORDER

\$16⁰⁰ PAID *K* DEPUTY

363455

BK0695PG0530