

THIS INSTRUMENT IS BEING RECORDED AS AN ACCOMMODATION ONLY. NO LIABILITY, EXPRESSED OR IMPLIED, IS ASSUMED AS TO ITS REGULARITY OR SUFFICIENCY NOR AS TO ITS AFFECT, IF ANY, UPON TITLE TO ANY REAL PROPERTY DESCRIBED THEREIN.

STEWART TITLE OF DOUGLAS COUNTY

ORDER NO: 95020853ACM

GRANT, BARGAIN, AND SALE DEED

THIS INDENTURE WITNESSETH: That

PHYLLIS D. WILSON, an unmarried woman

in consideration of the sum of TEN DOLLARS (\$10.00) lawful money of the United States, and other good and valuable consideration, the receipt of which is hereby acknowledged, does hereby Grant, Bargain, Sell and Convey to

PHYLLIS D. WILSON, an unmarried woman

and to the heirs and assigns of such Grantee forever, all that real property situated in the County of DOUGLAS, State of Nevada, bounded and described as follows:

SEE EXHIBIT "A" ATTACHED HERETO AND BY THIS REFERENCE MADE A PART HEREOF

ASSESSORS PARCEL NUMBER 07-180-64

Together with all and singular the tenements, hereditaments and appurtenances thereunto belonging or in anywise appertaining, and any reversions, remainders, rents, issues or profits thereof.

Witness my hand this 17 day of August, 1995.

Phyllis D. Wilson  
PHYLLIS D. WILSON

STATE OF Nevada )  
COUNTY OF Douglas ) SS.

On August 17, 1995, personally appeared before me, a Notary Public, PHYLLIS D. WILSON

personally known or proved to me to be the persons whose names are subscribed to the above instrument who acknowledged that they executed the same for the purposes therein stated.

Deirdre Randolph  
Notary Public

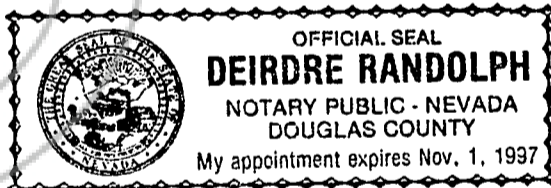

WHEN RECORDED, MAIL TO:

PHYLLIS D. WILSON  
P.O. BOX 3514  
STATELINE, NV 89449

The Grantor(s) declare(s): # 3  
Document Transfer Tax is \$0.00  
(X) computed on full value of property conveyed

MAIL TAX STATEMENTS TO:  
as shown above

369320

BK0895PG4782

DESCRIPTION

Adjusted APN 07-180-64

All that real property situate in the County of Douglas, State of Nevada, described as follows:

All that portion of the Northeast 1/4 of the Northwest 1/4 of Section 26, Township 13 North, Range 18 East, M.D.M., described as follows:

Beginning at a point which bears North 00 08'00" East 45.72 feet from the Northwest corner of that parcel shown on that Record of Survey for Ronald D., Carol & Nicole Bommarito, filed for record in Book 1091, Page 3718, Document No.263251;

thence North 00 08'00" East 169.10 feet;  
thence South 89 46'00" East 163.80 feet;  
thence South 00 08'00" West 75.87 feet;  
thence South 88 36'30" West 32.31 feet;  
thence South 60 46'00" West 8.93 feet;  
thence North 89 46'00" West 43.75 feet;  
thence South 42 28'04" West 118.75 feet to the Point of Beginning.

The Basis of Bearing of this description is identical with that of the Record of Survey for Ronald D., Carol and Nicole Bommarito, filed for record on October 22, 1991, as Document No.263251, being the bearing "North 89 46'00" West" between found corners.

Note: Refer this description to your title company before incorporating into any legal document.

Prepared by: Turner & Associates, Inc.  
Land Surveying  
PO Box 5067  
Stateline, NV 89449

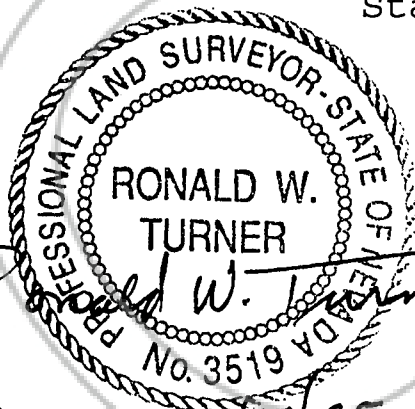

REQUESTED BY  
**STEWART TITLE of DOUGLAS COUNTY**  
IN OFFICIAL RECORDS OF  
DOUGLAS CO., NEVADA

'95 AUG 29 AM 11:22

LINDA SLATER  
RECORDER

\$ 8.00 PAID *ka* DEPUTY

**369320**  
**BK0895PG4783**