

SURVEYOR'S CERTIFICATE:
 I, RONALD W. TURNER, A PROFESSIONAL LAND SURVEYOR IN THE STATE OF NEVADA, CERTIFY THAT:
 1. THIS IS A TRUE AND ACCURATE REPRESENTATION OF THE LANDS MAPPED UNDER MY SUPERVISION AT THE INSTAANCE OF THE SCHWAKE FAMILY TRUST.
 2. THE LANDS SURVEYED LIE WITHIN SECTIONS 2, 3, 10 AND 11, T.12 N., R. 19 E., M. D.M., AND THE SURVEY WAS COMPLETED ON 12-15-92.
 3. THIS PLAT COMPLIES WITH NRS 218.320(4) AND NRS 218.460(2).
 4. THIS PLAT WAS PREPARED FROM RECORD INFORMATION.

Ronald W. Turner
 RONALD W. TURNER, P.L.S. 3919 12-20-92
 DATE

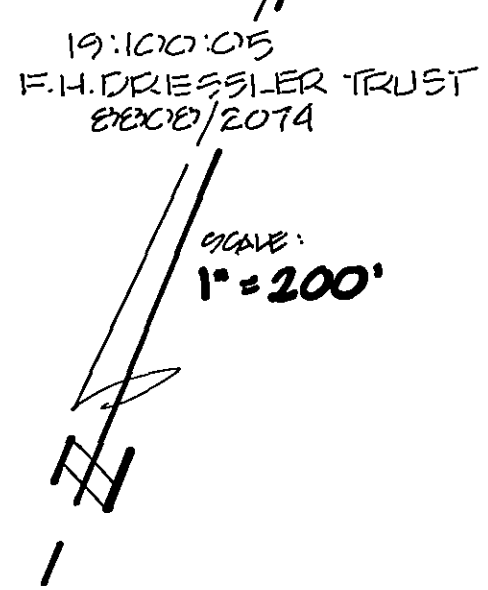
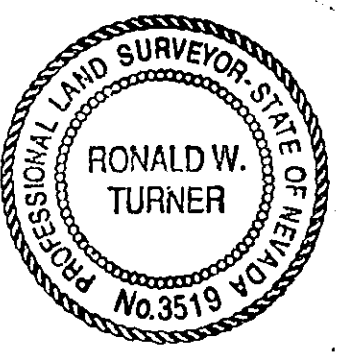

TAX COLLECTOR'S CERTIFICATE:
 I, BARBARA J. REED, DOUGLAS COUNTY CLERK-TREASURER AND EX-OFFICIO TAX COLLECTOR, DO HEREBY CERTIFY THAT ALL PROPERTY TAXES ON THIS LAND FOR THE FISCAL YEAR HAVE BEEN PAID.
 A.P.N. 19:110:09

Barbara J. Reed
 BARBARA J. REED
 DOUGLAS COUNTY CLERK-TREASURER
 AND EX-OFFICIO TAX COLLECTOR
 By: *J. Wheat*, Deputy

OWNERS' CERTIFICATE:
 WE, THE UNDERSIGNED OWNER OF THE LAND SHOWN ON THIS MAP DO HEREBY STATE:
 1) WE HAVE EXAMINED THIS PLAT AND APPROVE AND AUTHORIZE ITS RECORDATION.
 2) ALL PROPERTY TAXES ON THE LAND FOR THE FISCAL YEAR HAVE BEEN PAID.

Melvin H. Schwake Sr. Trustee
 MELVIN H. SCHWAKE, SR.
 TRUSTEE, SCHWAKE FAMILY TRUST
Edrie Cross Schwake Trustee
 EDRIE CROSS SCHWAKE
 TRUSTEE, SCHWAKE FAMILY TRUST

STATE OF NEVADA ss.
 COUNTY OF DOUGLAS
 ON THE 18th DAY OF FEBRUARY 1993, PERSONALLY APPEARED BEFORE ME, A NOTARY PUBLIC, MELVIN SCHWAKE, SR. AND EDRIE CROSS SCHWAKE, TRUSTEES OF THE SCHWAKE FAMILY TRUST, PERSONALLY KNOWN TO ME (OR PROVED TO ME ON THE BASIS OF SATISFACTORY EVIDENCE) TO BE THE PERSONS WHOSE NAMES ARE SUBSCRIBED TO THE WITHIN INSTRUMENT AND ACKNOWLEDGE THAT THEY EXECUTED IT.

Suzanne McCauley
 NOTARY PUBLIC
 SUZANNE MCCAULEY
 Notary Public - State of Nevada
 Appointment Recorded in Washoe County
 MY APPOINTMENT EXPIRES JUNE 25, 1995

BASIS OF BEARING:
 THE SOUTH LINE OF SECTION 3,
 WHICH IS "N 81° 57' E".

NOTE:
 NRS 218.320(4) EXEMPTS THE DIVISION OF LAND SET FORTH IN THIS MAP FROM ANY AND ALL REQUIREMENTS OF CHAPTER 218 N.R.S. ENTITLED "PLANNING AND ZONING". SPECIFICALLY, NRS 218.320(4) STATES AS FOLLOWS:
 THIS CHAPTER DOES NOT APPLY TO THE DIVISION OF LAND FOR AGRICULTURAL PURPOSES INTO PARCELS OF MORE THAN TEN ACRES IF A STREET, ROAD OR HIGHWAY OPENING OR UNDEVELOPED OR EMBANKMENT OF ANY KIND IS NOT INVOLVED.
 THIS MAP IS BEING RECORDED PURSUANT TO NRS 218.460(2) WHICH EXEMPTS FROM ALL RECORDING REQUIREMENTS CONTAINED IN NRS 218.00 TO 218.030, INCLUDING ANY MAP OF ANY LAND WHICH IS NOT A SUBDIVISION, WHICH DEFINITION INCLUDES THIS MAP, BECAUSE THE DIVISION OF LAND PURSUANT TO NRS 218.320(4) IS NOT CONSIDERED A SUBDIVISION OF LAND WITHIN THE MEANING OF CHAPTER 218 N.R.S.

RECORDER'S CERTIFICATE:
 FILED FOR RECORD THIS 29th DAY OF JULY 1996, AT 2:25 O'CLOCK P.M. IN BOOK 196 OF OFFICIAL RECORDS, DOUGLAS COUNTY, NEVADA, AT PAGE 4787 DOCUMENT NO. 393066. RECORDED AT THE REQUEST OF THE SCHWAKE FAMILY TRUST.

Butter Henderson
 BUTTER HENDERSON, Deputy
 DOUGLAS COUNTY RECORDER

TOTAL ACRES = 233.42 ACRES

SCHWAKE FAMILY TRUST - DOCUMENT #393066

MAP OF DIVISION OF LAND INTO PARCELS GREATER THAN TEN ACRES PURSUANT TO NRS 218.320(4) FOR THE SCHWAKE FAMILY TRUST PORTION OF SECTIONS 2, 3, 10 & 11, T.12 N., R. 19 E., M. D.M.

DOUGLAS COUNTY, NEVADA JUN 92089 SHEET 1 OF 1

2,3,10,11-12-19 Doc# 393066 SCHWAKE