

De Comm-DEO  
No fee

RECORDED AT THE REQUEST OF:  
Douglas County, Nevada  
Community Development  
P.O. Box 218  
Minden, Nevada 89423

**TEMPORARY CONSTRUCTION EASEMENT**

THIS INDENTURE is made between Douglas K. Hone and Kathleen L. Hone; Co-Trustees under the Hone Family Trust Agreement, dated March 21, 1989, Party of the First Part, hereinafter referred to as "GRANTOR", and the COUNTY OF DOUGLAS, a political subdivision of the STATE OF NEVADA, Party of the Second Part, hereinafter called "GRANTEE";

WITNESS:

GRANTOR, for and in consideration of the sum of one dollar (\$1.00), lawful money of the United States of America, the receipt whereof is hereby acknowledged, does by these presents grant, bargain, sell, and convey unto the GRANTEE a temporary construction easement for the repair and improvement of the Mottsville Road crossing of Big Ditch in conjunction with the operation of a public roadway and all related features through, under and across the lands of GRANTOR situate in the NW¼ of Section 2 Township 12 North., Range 19 East., MDB&M, County of Douglas, State of Nevada, said right-of-way is more particularly described as follows:

SEE ATTACHED EXHIBIT "A"

APN: 19-070-10

The temporary easement shall be abandoned after completion of construction but in no event later than December 31, 1997.

The parties further agree, as part of consideration of this conveyance, that the repair work will include the following items:

1. Installation of a culvert under Mottsville Road west of Big Ditch to divert roadside drainage downstream of the highway bridge.

IN WITNESS WHEREOF said GRANTOR has hereunto executed this document on the 13th day of April, 1997.

Douglas K. Hone, Co-Trustee  
Douglas K. Hone, Co-Trustee under the Hone Family Trust Agreement

Kathleen L. Hone, Co-Trustee  
Kathleen L. Hone, Co-Trustee under the Hone Family Trust Agreement

STATE OF NEVADA     )  
                                  ) SS:  
COUNTY OF DOUGLAS )

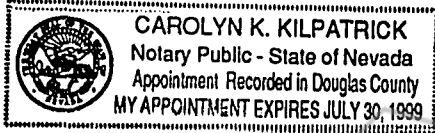

On this 23 day of April, in the year 1997 before me, CAROLYN K. KILPATRICK Notary Public, personally appeared Douglas & Kathleen Hone; personally known to me (or proved to me on the basis of satisfactory evidence) to be the person(s) whose name(s) is/are subscribed to this instrument, and acknowledge that he/she/they executed it.

WITNESS my hand and official seal.

Carolyn K. Kilpatrick  
Notary's Signature  
My Commission Expires: July 30, 1999

# EXHIBIT "A"

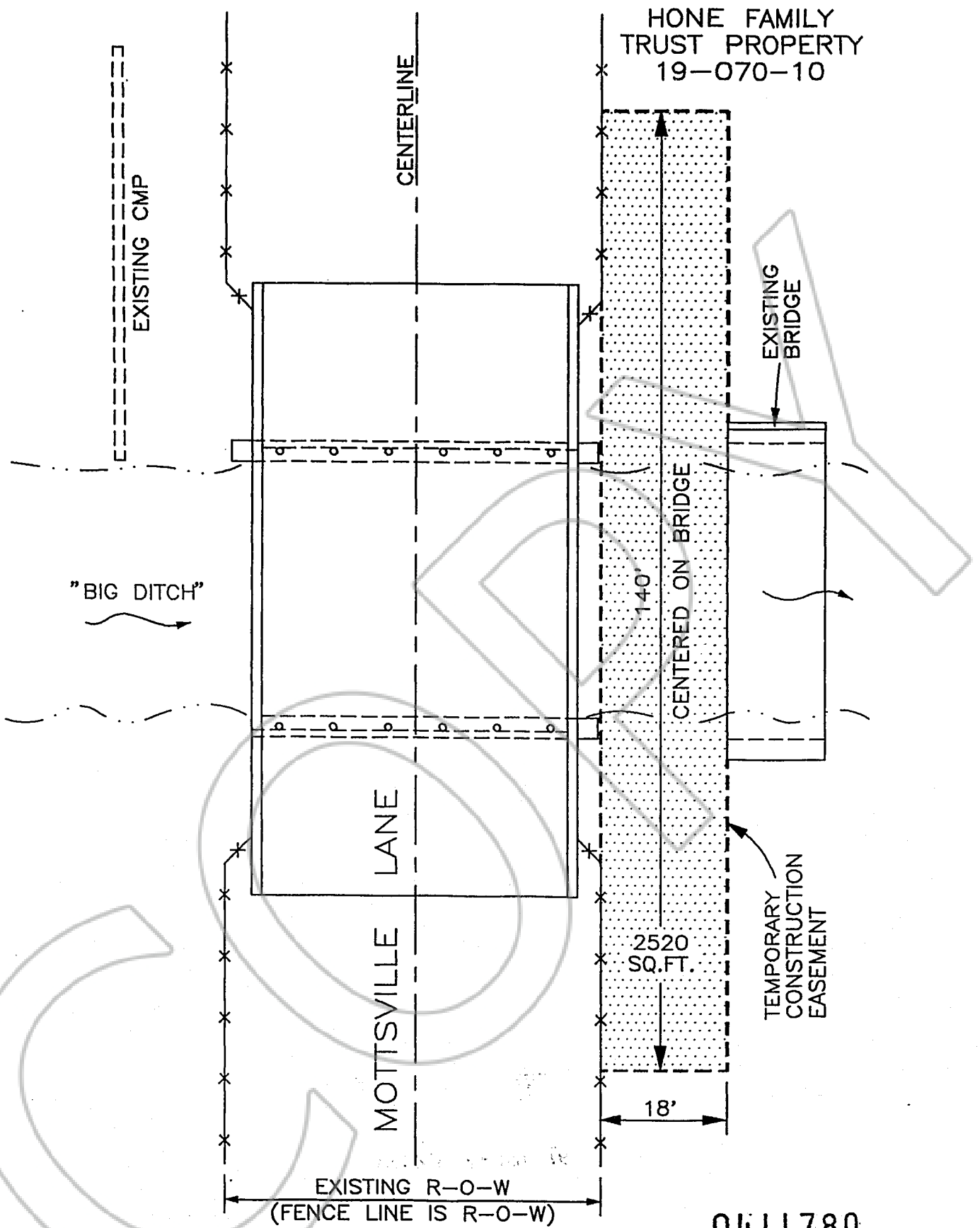

0411780

JLF73

BK0597PG0263

COPY

REQUESTED BY  
*W. P. Thomas, Jr.*  
IN OFFICIAL RECORDS OF  
DOUGLAS CO., NEVADA

'97 MAY -2 P2:56

LINDA SLATER  
RECORDER  
\$ *e* PAID *L* DEPUTY

0411780  
BK0597PG0264