

Exhibit "A"

All the real property situate in the County of Douglas, State of Nevada, more particularly described as follows:

Being a portion of the Northeast 1/4 of the Northeast 1/4 of Section 2, Township 12 North, Range 20 East, further described as follows:

Parcel 18A-3B as set forth on Parcel Map No. 4 for Tedsen/Anker, a redivision of Parcel 18A-3 of the Tedsen/Anker Parcel Map No. 2, Document No. 304722 filed for record in the office of the County Recorder, State of Nevada, on December 14, 1993, in Book 1293, Page 2965, as Document No. 324975.

A.P.N. 23-482-10

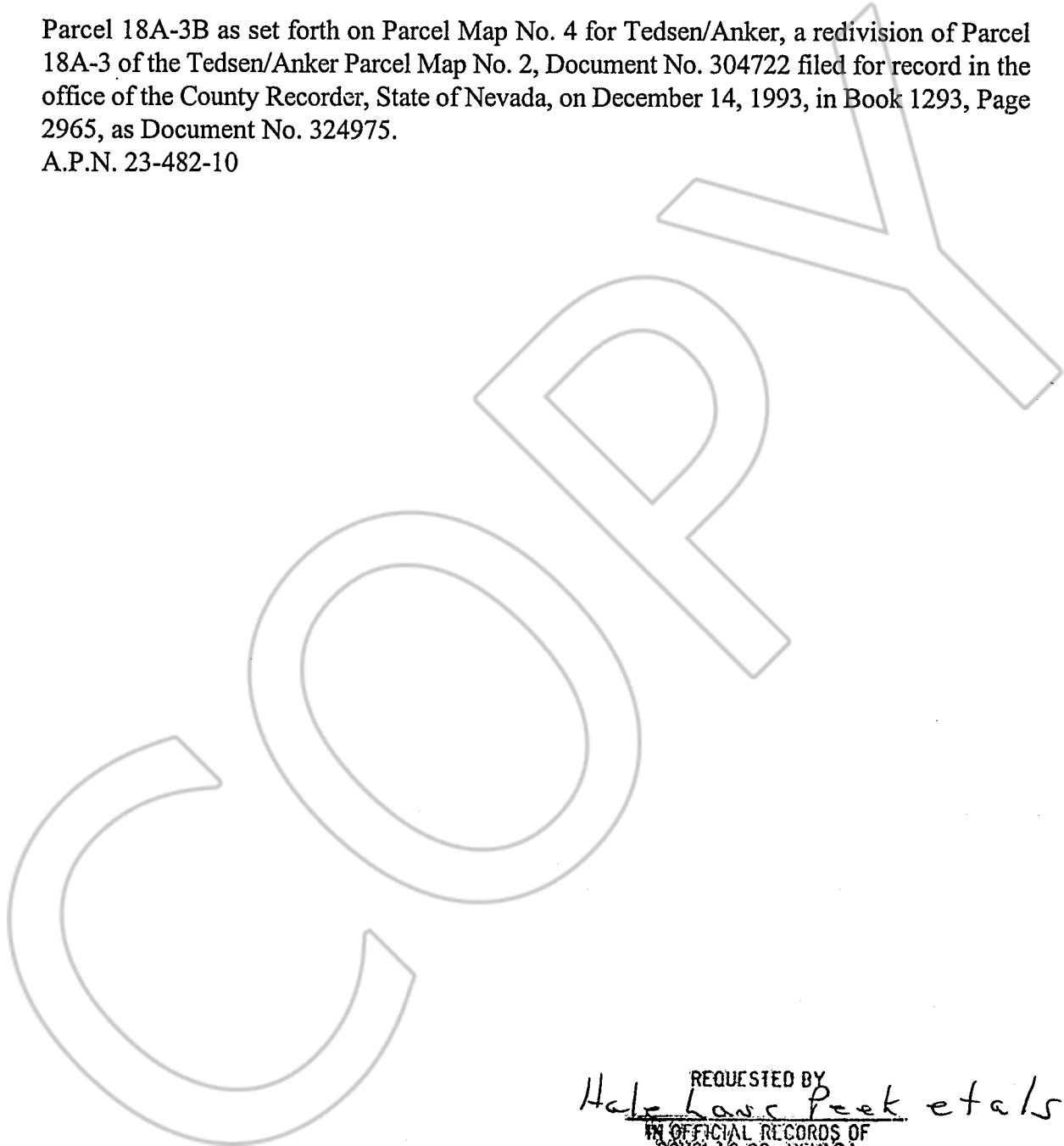

REQUESTED BY
Hale, Lane, Peck et al
IN OFFICIAL RECORDS OF
DOUGLAS CO., NEVADA

'97 AUG -1 P4:29

LINDA SLATER
RECORDER
\$ *ss* PAID *LD* DEPUTY

0418589
BK0897PG0331