

DC Comm Dev
no fee

RECORDED AT THE REQUEST OF:

✓ Douglas County, Nevada
Community Development
PO Box 218
Minden, Nevada 89423

R.P.T.T. \$ #2

GRANT DEED

THIS INDENTURE is made between Douglas K. Hone and Kathleen L. Hone; Co-Trustees under the Hone Family Trust Agreement, dated March 21, 1989, Party of the First Part, hereinafter referred to as "GRANTOR", and the COUNTY OF DOUGLAS, a political subdivision of the STATE OF NEVADA, Party of the Second Part, hereinafter called "GRANTEE";

WITNESS:

GRANTOR, for and in consideration of the sum of six hundred dollars (\$600.00), lawful money of the United States of America, the receipt whereof is hereby acknowledged, does by these presents grant, bargain, sell, and convey unto the GRANTEE a road right-of-way for the construction of improvements to the Mottsville Road crossing of Big Ditch, and the continued maintenance and repair of the improvements for use in conjunction with the operation of a public roadway and all related features through, under and across the lands of GRANTOR situate in the NW¼ of Section 2 Township 12 North., Range 19 East., MDB&M, County of Douglas, State of Nevada, said right-of-way is more particularly described as follows:

SEE ATTACHED EXHIBIT "A"

APN: 19-070-10

GRANTOR also grants and conveys to GRANTEE a temporary easement as shown on Exhibit "A" to facilitate construction of new right-of-way fencing, said temporary easement shall be abandoned after completion of construction, but in no event later than December 31, 1997.

The parties further agree, as part of consideration of this conveyance, that GRANTEE shall from time to time, and at all times hereafter, at its own cost and expense, repair and maintain in a proper, substantial, and workmanlike manner the bridge improvements within the right-of-way.

The parties further agree that GRANTOR shall have the reasonable right of ingress and egress to and from the property described above for the purpose of private access to GRANTOR's property.

IN WITNESS WHEREOF said GRANTOR has hereunto executed this document on the 25th day of August, 1997.

Douglas K. Hone
Douglas K. Hone, Co-Trustee under the Hone Family Trust Agreement

Kathleen L. Hone, Co-Trustee
Kathleen L. Hone, Co-Trustee under the Hone Family Trust Agreement

STATE OF NEVADA)
) SS:
COUNTY OF DOUGLAS)

On this 25th day of August, in the year 97 before me,

Christina M. Davis / Notary

Public, personally appeared Douglas and Kathleen Hone, personally known to me (or proved to me on the basis of satisfactory evidence) to be the person(s) whose name(s) is/are subscribed to this instrument, and acknowledge that he/she/they executed it.

WITNESS my hand and official seal.

Christina M. Davis
Notary's Signature
My Commission Expires: 9-17-2000

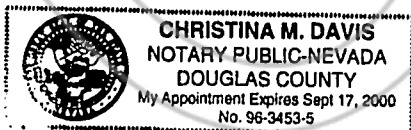

FRED H. DRESSLER
TRUST PROPERTY
19-100-05

NORTH
NTS

EXHIBIT "A"

HONE FAMILY
TRUST PROPERTY
19-070-10

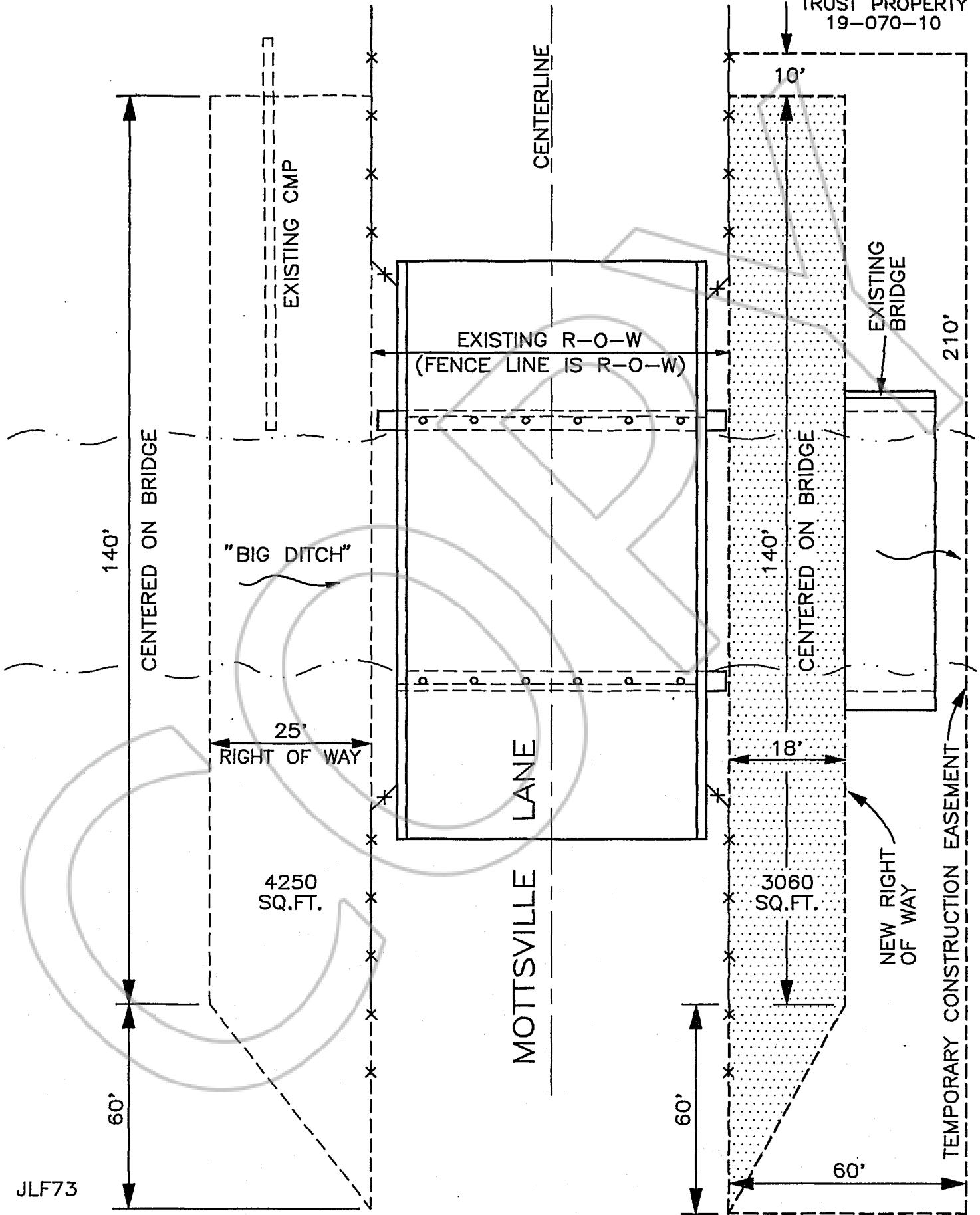

JLF73

0421879

RK0997PG3384

COPY

REQUESTED BY
~~DOUGLAS GILNEY~~
OFFICIAL RECORDS OF
DOUGLAS CO., NEVADA

'97 SEP 17 P12:52

LINDA SLATER
RECORDER

\$ Q PAID JK DEPUTY

0421879

BK0997PG3385