

NF
DAJ
Tom Perkins

FILED
NO. 97.181

'97 NOV 19 A9:13

Recorded at the request of:
Douglas County, Nevada
c/o Department of Public Works
Attn.: Dennis Little

BY *[Signature]*
CLERK OF COUNTY

ABANDONMENT:

**AN ORDER OF ABANDONMENT VACATING PORTIONS OF THE
LINCOLN PARK BEACH ROAD**

WHEREAS Douglas County, a political subdivision of the State of Nevada, presently holds an interest within Section 34, Township 14 North, Range 18 East, M.D.B. & M., for portions of that certain road right-of-way commonly known as the Lincoln Park Beach Road; and,

WHEREAS Douglas County, pursuant to the provisions of NRS 278.480 may vacate or abandon by formal order any portion of a public street or easement; and,

WHEREAS on the 19th day of November, 1996, Douglas County Planning Commission held a public hearing in conformance with the provisions of NRS 278.240, considered and approved the abandonment of portions of the Lincoln Park Beach Road, as hereinafter set forth; and

WHEREAS on June 19, 1997, the Douglas County Board of Commissioners held a public hearing on the petition for said abandonment, on notice, and found that the public would not be materially injured by the abandonment of the portions of the Lincoln Park Beach Road as hereinafter set forth;

NOW THEREFORE be it ordered by the Board of Douglas County Commissioners, that the portions of the right-of-way and incidents thereto, being all of the right, title and interest of Douglas County, Nevada, in and to the real property and improvements described on Exhibits "A", "B" and "C" shall be, and hereby is, abandoned, and shall revert to the abutting property owners in the following manner, to-wit:

- A. The real property and improvements described in Exhibit "A" shall revert to James H. Milligan, trustee of the James H. Milligan 1987 Trust Agreement dated July 2, 1987 and Lois Darlene Milligan, Trustee of the Lois Darlene Milligan Trust Agreement dated July 22, 1987; and
- B. The real property and improvements described in Exhibit "B" shall revert to Paul E. Pennington and Pamela R. Pennington, husband and wife, as successors to the previous owners, Robert Scurich, an individual, and Charles M. McGee, Trustee of the Craig Scurich Trust; and
- C. The real property and improvements described in Exhibit "C" shall revert to Jeffrey and Suzanne Lundahl.

Any Public Utility Easement embracing the limits of the original roadway is expressly reserved for the continuation, maintenance, expansion, and operation of the public utilities contained within the limits of this abandonment.

0426667

BK 1197PG3696

DATED this 18th day of November, 1997.

Jacques Etchegoyhen
Jacques Etchegoyhen, Chairman
Douglas County Board of Commissioners

STATE OF NEVADA)
)ss.
COUNTY OF DOUGLAS)

On the 18th day of November, 1997, Jacques Etchegoyhen, Chairman of the Douglas County Board of Commissioners, personally appeared before me, Barbara J. Reed, Douglas County Clerk, and acknowledged to me, that in conformance with the direction of the Board of Douglas County Commissioners meeting of June 19, 1997, he executed the above instrument on behalf of Douglas County, a political subdivision of the State of Nevada.

Barbara J. Reed by Sandra Condon
Barbara J. Reed, Douglas County Clerk *deputy*

0426667

BK 1197PG3697

DESCRIPTION

All that real property situate in the County of Douglas, State of Nevada, described as follows:

All that portion of Section 34, Township 14 North, Range 18 East, M.D.M., more particularly described as follows:

Beginning at a point on the North line of Lot 1, Block A, Lincoln Park filed for record on September 7th, 1921, Doc. No. 305, which bears South 19 33'30" East 19.14 feet and South 89 44'15" East 1.86 feet from the Meander Corner common to Sections 27 and 34;

thence North 34 43'00" East 4.70 feet;
thence North 68 56'24" East 16.72 feet,
thence North 35 00'24" East 6.37 feet,
thence North 87 06'00" East 6.38 feet,
thence North 54 59'36" East 9.54 feet,
thence North 35 00'24" East 1.00 feet,
thence North 54 55'07" East 19.15 feet and
thence North 89 44'15" East 52.37 feet to the Point of

Beginning.

The Basis of Bearing for this description is identical to the above referenced Lincoln Park.

Note: Refer this description to your title company before incorporating into any legal document.

Prepared by: Turner & Associates, Inc.
Land Surveying
PO Box 5067
Stateline, NV 89449

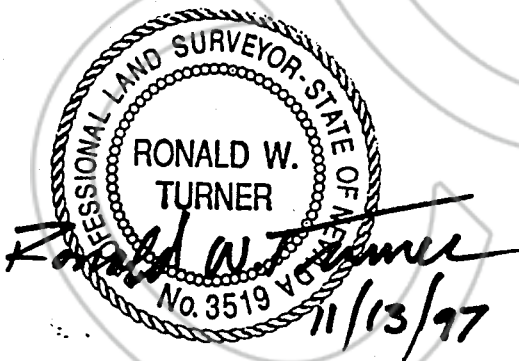

ORDER OF ABANDONMENT: LINCOLN PARK BEACH ROAD: EXHIBIT A

0426667

BK 1197PG3698

JUL 21 1997

JN 95221
7/28/97

DESCRIPTION

All that real property situate in the County of Douglas, State of Nevada, described as follows:

All that portion of Section 34, Township 14 North, Range 18 East, M.D.M., more particularly described as follows:

Commencing at the Northwest corner of Lot 13, Block A, of Lincoln Park, filed for record on September 7, 1921, Document No.305, said corner bears South 34 49'18" West 421.44 feet from the 1991 B.L.M. Meander Corner for Sections 27 and 34;
thence South 60 45'35" West 2.96 feet to the True Point of Beginning;
thence South 60 45'35" West 56.59 feet,
thence North 67 48'38" West 19.73 feet,
thence North 21 52'24" East 15.58 feet,
thence North 62 02'44" East 36.92 feet,
thence South 68 24'10" East 31.44 feet to the True Point of Beginning.

The Basis of Bearing for this description is identical to the above referenced Lincoln Park.

Note: Refer this description to your title company before incorporating into any legal document.

Prepared by: Turner & Associates, Inc.
Land Surveying
PO Box 5067
Stateline, NV 89449

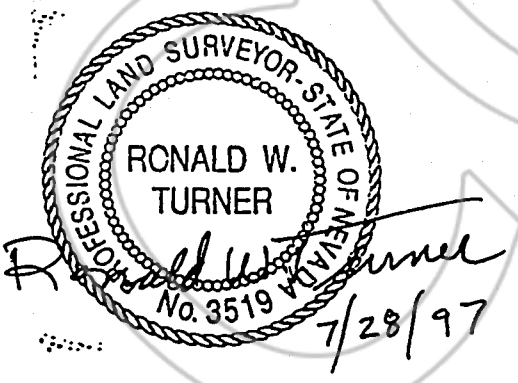

ORDER OF ABANDONMENT; LINCOLN PARK BEACH ROAD; EXHIBIT B

0426667

BK 1197PG3695

DESCRIPTION

All that real property situate in the County of Douglas,
State of Nevada, described as follows:

All that portion of Section 34, Township 14 North, Range 18
East, M.D.M., more particularly described as follows:

Commencing at the Southwest corner of Lot 14, Block A, of
Lincoln Park, filed for record on September 7, 1921,
Document No.305,
thence North 35 11'07"East 6.74 feet to the True Point of
Beginning;
thence North 66 34'45" West 16.66 feet,
thence North 07 49'50" West 26.57 feet,
thence North 58 01'10" East 8.20 feet,
thence South 67 20'06" East 32.01 feet,
thence South 35 11'07" West 30.52 feet to the True Point of
Beginning.

The Basis of Bearing for this description is identical to
the above referenced Lincoln Park.

Note: Refer this description to your title company
before incorporating into any legal document.

Prepared by: Turner & Associates, Inc.
Land Surveying
PO Box 5067
Stateline, NV 89449

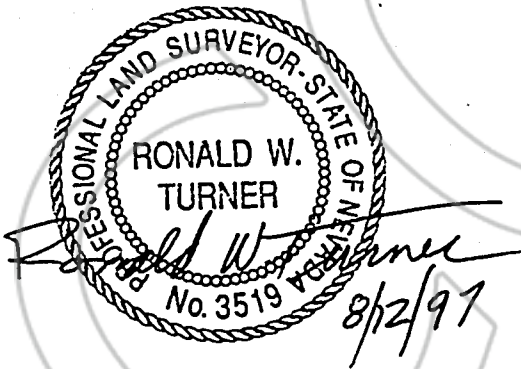

ORDER OF ABANDONMENT; LINCOLN PARK BEACH ROAD; EXHIBIT C

0426667

BK 1197PG3700

REQUESTED BY
DOUGLAS COUNTY
IN OFFICIAL RECORDS OF
DOUGLAS CO., NEVADA

'97 NOV 19 AM 11:36

0426667

LINDA SLATER
RECORDER

BK 1197PG3701 \$ 0 PAID ko DEPUTY

CERTIFIED COPY

The document to which this certificate is attached is a full, true and correct copy of the original on file and on record in my office.

DATE:

November 19, 1997
B. REED Clerk of the 9th Judicial District Court
of the State of Nevada, in and for the County of Douglas.

By

Carol M. Culloch Deputy

SEAL