

RECORD AND RETURN TO:  
PHH MORTGAGE SERVICES CORP.  
6000 ATRIUM WAY  
MT LAUREL, NJ 08054  
COMMT #: 97C69  
ID: 570150094

ASSIGNMENT OF DEED  
OF TRUST OR MORTGAGE

LOAN #: 6216899  
NAME : RAPOPORT  
STATE OF : NV  
COUNTY OF: DOUGLAS

KNOW ALL MEN BY THESE PRESENTS, THAT \*PHH MORTGAGE SERVICES CORPORATION 6000 ATRIUM WAY, MT LAUREL, NEW JERSEY, A CORPORATION EXISTING UNDER THE LAWS OF THE STATE OF NEW JERSEY, FOR VALUABLE CONSIDERATION, THE RECEIPT OF WHICH HEREBY ACKNOWLEDGED, DOES HEREBY GRANT, BARGAIN, SELL, ASSIGN AND TRANSFER TO:  
THE FIRST NATIONAL BANK OF CHICAGO AS TRUSTEE  
3350 ELECTONIC DRIVE, SUITE 140  
PASADENA, CA 91108

THAT CERTAIN PROMISSORY NOTE AND DEED OF TRUST OR MORTGAGE DESCRIBED AS FOLLOWS:

NOTE AND DEED OF TRUST OR MORTGAGE DATED: 97/08/25  
AMOUNT: \$320,000.00 EXECUTED BY: MICHAEL RAPOPORT  
KATHERINE D RAPOPORT

CLERKS FILE OR INSTRUMENT NO: 0420441 RECORDED DATE: 970828  
BOOK: 0897 VOLUME: PAGE: 5368  
ADDRESS: 180 SNOWSHOE LANE GENOA DOUGLAS NV 89411  
DESCRIBING LAND THEREIN AS DESCRIBED IN DEED OF TRUST/MORTGAGE REFERRED TO HEREIN.

\* FORMERLY DOING BUSINESS AS PHH US MORTGAGE CORPORATION

TOGETHER WITH THE NOTE THEREIN OR REFERRED TO, THE MONEY DUE AND TO BECOME DUE THEREON WITH INTEREST AND ALL RIGHTS ACCRUED OR TO ACCRUE UNDER SAID DEED OF TRUST OR MORTGAGE.

DATED: 12/01/97  
WITNESSED BY : [Signature]  
CHARLES DARKWAH

\*PHH MORTGAGE SERVICES CORPORATION  
6000 ATRIUM WAY  
MT LAUREL, NJ 08054

BY : [Signature]  
MIKE CRIST  
ASSISTANT VICE-PRESIDENT  
[Signature]  
JOE BERGBAUER  
ASSISTANT SECRETARY

SEAL

PREPARED BY : [Signature]  
JANINE KRIPS  
6000 ATRIUM WAY  
MT LAUREL, NJ 08054

STATE OF NEW JERSEY, COUNTY OF BURLINGTON  
ON 12/01/97, BEFORE ME, THE UNDERSIGNED, A NOTARY PUBLIC IN AND FOR SAID STATE AND COUNTY, PERSONALLY APPEARED MIKE CRIST AND JOE BERGBAUER PERSONALLY KNOWN TO ME OR PROVED TO ME ON THE BASIS OF SATISFACTORY EVIDENCE TO BE ASST VICE PRES. AND ASSISTANT SECRETARY OF THE CORPORATION THAT EXECUTED THE WITHIN INSTRUMENT, ON BEHALF OF THE CORPORATION THEREIN NAMED, AND ACKNOWLEDGED TO ME THAT SUCH CORPORATION EXECUTED THE WITHIN INSTRUMENT PURSUANT TO ITS BY-LAWS OR RESOLUTION OF ITS BOARD OF DIRECTORS. WITNESS MY HAND AND AND OFFICIAL SEAL IN THE STATE AND COUNTY LAST AFORESAID.

[Signature]  
NOTARY PUBLIC

MICHELLE L. KRAUSE  
NOTARY PUBLIC OF NEW JERSEY  
MY COMMISSION EXPIRES 12/19/2000

SEAL

0430896

BK0198PG3111

Rapaport  
Co 216890

Order No.: 970799-VM

### DESCRIPTION

The land referred to herein is situated in the State of Nevada, County of Douglas, described as follows:

Lot 10, of GENOA ESTATES, as shown on the Official Map recorded in the office of the County Recorder of Douglas County, Nevada, on March 7, 1966, as Document No. 31256.

Assessor's Parcel No. 17-071-03.

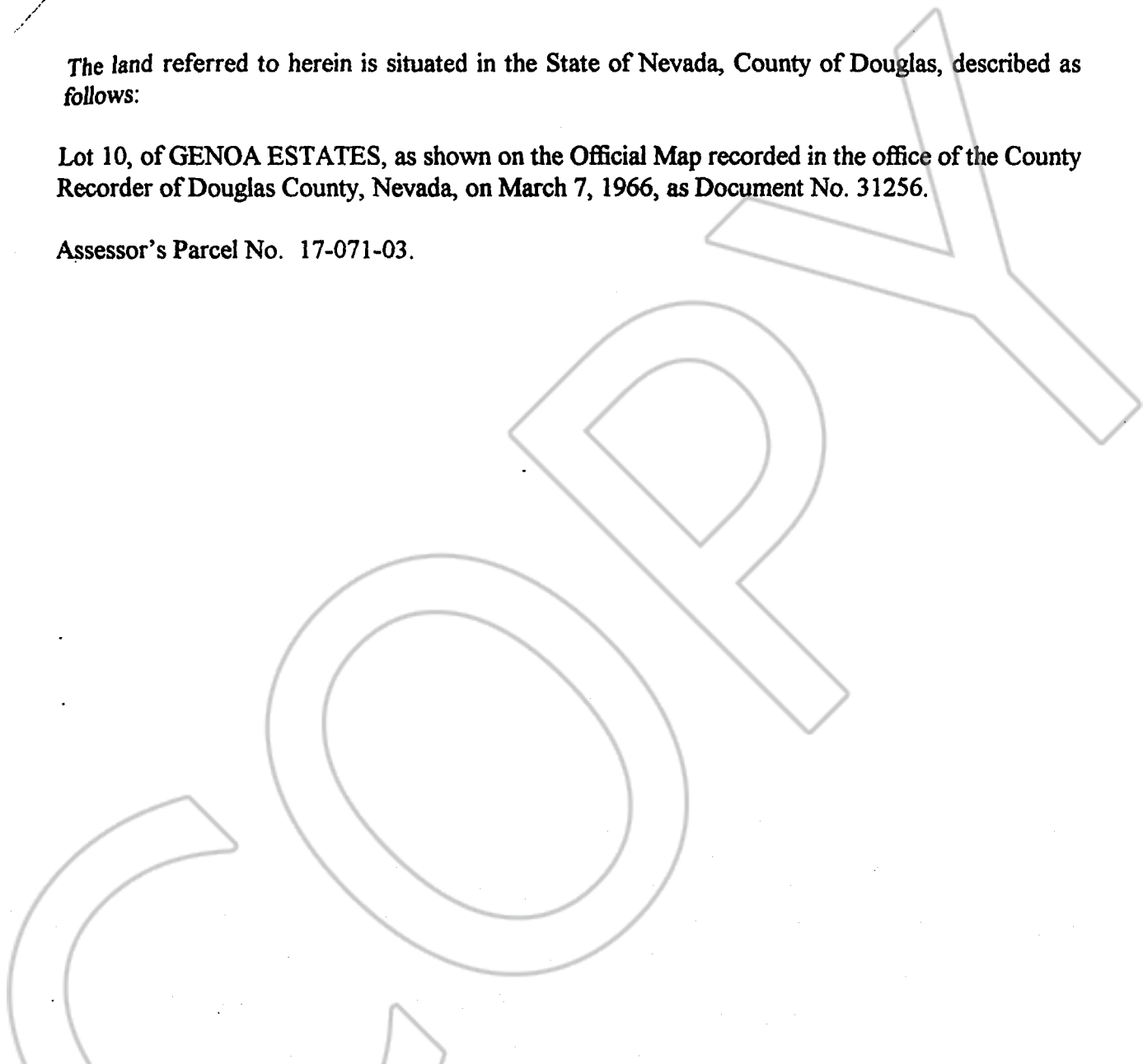

REQUESTED BY  
*Mortgage Services Center*  
IN OFFICIAL RECORDS OF  
DOUGLAS CO., NEVADA

'98 JAN 22 A9:40

REQUESTED BY  
**MARQUIS TITLE & ESCROW, INC.**  
IN OFFICIAL RECORDS OF  
DOUGLAS CO., NEVADA

'97 AUG 28 P2:45

5

0430896 LINDA SLATER  
RECORDER  
\$ 8<sup>00</sup> PAID *K2* DEPUTY  
BK0198PG3112

0420441  
BK0897PG5374

LINDA SLATER  
RECORDER  
\$ 13<sup>00</sup> PAID *K2* DEPUTY