

Recording requested by, and
mail tax statements to, and
when recorded, mail to:

T. Scott Brooke
Brooke & Shaw
Post Office Box 2860
Minden NV 89423

98070947

**GRANT DEED
(LOT LINE ADJUSTMENT)**

R.P.T.T. \$ #3

THIS DEED is made this 19th day of May, 1998, by and between RONALD L. SIMEK, an individual, (hereinafter referred to as "Grantor") and RONALD L. SIMEK, an individual (hereinafter referred to as "Grantee").

WITNESSETH:

Grantor is the owner of real property located in Douglas County, Nevada, described as follows:

See Exhibit A attached hereto and incorporated herein by this reference. (APN 15-060-68)

Grantor is also the owner of adjacent real property described as follows:

See Exhibit B attached hereto and incorporated herein by this reference. (APN 15-060-69)

Grantor desires to adjust the boundaries of said above two (2) real properties as set forth herein.

GRANTOR, for good and valuable consideration, the receipt of which is hereby acknowledged, and for the purpose of creating a lot line adjustment between contiguous parcels owned by Grantor, does by these presents, grant, bargain, sell, convey, transfer, and deliver to himself as Grantee, and his heirs, successors and assigns, all of Grantor's right, title and interest in and to the property situate in Douglas County, Nevada; so that, following said lot line adjustment, the real property remaining vested in Grantor as Grantee is that property which is more particularly described as set forth on Exhibits C and D attached hereto and incorporated herein by this reference.

TOGETHER WITH the tenements, hereditaments and appurtenances thereunto belonging or appertaining, and the reversion and reversions, remainder and remainders, rents, issues and profits thereof.

0441785

BK0698PG2770

TO HAVE AND TO HOLD the said premises, together with the appurtenances, unto the said

Grantee, and to its heirs, successors and assigns forever.

WITNESS my hand this 19th day of May, 1998.

Ronald L. Simek
RONALD L. SIMEK

STATE OF NEVADA)
) ss.
COUNTY OF DOUGLAS)

On May 19, 1998, before me, a notary public, personally appeared RONALD L. SIMEK, personally known or proved to me to be the person whose name is subscribed to the above instrument who acknowledged that he executed the instrument.

Karen M. Riley
Notary Public

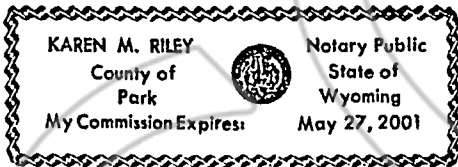

H:\REALESTA\SIMEKLOT.ADJ

0441785
BK0698PG2771

DESCRIPTION

PARCEL 21

(Adjusted APN 15-060-12)

All that real property situate in the County of Douglas, State of Nevada, described as follows:

A parcel of land located within the Southwest one-quarter (SW~~X~~) and within a portion of the South one-half of the North one-half of the Northwest one-quarter (S~~X~~N~~X~~NW~~X~~), the South one-half of the Northwest one-quarter (S~~X~~NW~~X~~), portions of the Northeast one-quarter (NE~~X~~), and portions of the Southeast one-quarter (SE~~X~~) of Section 27, and within the Northeast one-quarter of the Southeast one-quarter (NE~~X~~SE~~X~~) of Section 28, portions of the Northeast one-quarter (NE~~X~~), portions of the Southeast one-quarter of the Northwest one-quarter (SE~~X~~NW~~X~~), and within the North one-half of the Northwest one-quarter (N~~X~~NW~~X~~) of Section 34, Township 14 North, Range 19 East, Mount Diablo Meridian, more particularly described as follows:

Commencing at the north one-quarter corner of Section 27, T.14N., R.19E., M.D.M., a found 1985 BLM aluminum cap as shown on the Amended Record of Survey for Ronald Simek recorded May 28, 1996 in the office of Recorder, Douglas County, Nevada as Document No. 388745;

thence along the westerly line of the Northeast one-quarter of said Section 27 South 00°16'51" East, 667.52 feet to a found 1996 BLM brass cap, the POINT OF BEGINNING;

thence South 39°22'48" West, 215.33 feet;

thence South 28°01'13" East, 274.46 feet;

thence South 47°23'05" East, 944.76 feet;

thence South 45°25'40" East, 2700.25 feet to a point on the westerly line of Jacks Valley Road;

thence along said westerly line of Jacks Valley Road South 21°17'11" West, 512.14 feet to the northeasterly corner of Parcel 3-A as described in Quitclaim Deed recorded November 5, 1987 in the office of Recorder, Douglas County, Nevada, in Book 1187, at Page 757, as Document No. 165850;

thence the following six courses per said Quitclaim Deed;

thence North 80°27'30" West, 431.34 feet;

thence North 07°48'51" West, 117.97 feet;

thence West, 219.48 feet;

thence South 15°45'08" West, 251.57 feet;

thence South 00°55'37" East, 269.42 feet;

thence South 65°04'50" East, 559.20 feet to a point on said westerly line of Jacks Valley Road;

thence along said westerly line of Jacks Valley Road South 21°17'11" West, 2899.93 feet;

thence North 68°42'49" West, 819.87 feet;

thence South 61°44'16" West, 636.46 feet;

403934

0441785

BK1296PG4968

BK0698PG2772

thence South, 600.00 feet to a point on the south line of the Northwest one-quarter of said Section 34;

thence along said south line of the Northwest one-quarter of Section 34 South 89°09'36" West, 1121.09 feet to the southwest corner of the Southeast one-quarter of the Northwest one-quarter of said Section 34, a found 5/8" rebar and aluminum cap, RLS 3579;

thence along the west line of the Southeast one-quarter of the Northwest one-quarter of said Section 34 North 00°13'16" West, 1323.98 feet to the northwest corner of the Southeast one-quarter of the Northwest one-quarter of said Section 34, a found 5/8" rebar and aluminum cap, RLS 3579;

thence along the south line of the Northwest one-quarter of the Northwest one-quarter of said Section 34 South 89°10'48" West, 1323.12 feet to the southwest corner of the Northwest one-quarter of the Northwest one-quarter of said Section 34, a 5/8" rebar and aluminum cap per said Map, Document No. 388745;

thence along the west line of the Northwest one-quarter of the Northwest one-quarter of said Section 34 North 00°19'53" West, 1324.43 feet to the northwest corner of Section 34, a BLM brass cap per said Map, Document No. 388745;

thence along the west line of the Southwest one-quarter of said Section 27 North 00°11'37" West, 1310.03 feet to the northwest corner of the Southwest one-quarter of the Southwest one-quarter of said Section 27;

thence along the south line of the Northeast one-quarter of the Southeast one-quarter of said Section 28 South 89°45'03" West, 1301.50 feet to the southwest corner of the Northeast one-quarter of the Southeast one-quarter of said Section 28;

thence along the west line of the Northeast one-quarter of the Southeast one-quarter of said Section 28 North 00°06'59" West, 1310.98 feet to the northwest corner of the Northeast one-quarter of the Southeast one-quarter of said Section 28;

thence along the north line of the Northeast one-quarter of the Southeast one-quarter of said Section 28 North 89°47'33" East, 1299.73 feet to the west one-quarter corner of said Section 27, a BLM brass cap per Map, Document No. 388745;

thence along the west line of the Northwest one-quarter of said Section 27 North 00°00'49" West, 1324.56 feet to the northwest corner of the Southwest one-quarter of the Northwest one-quarter of said Section 27, a BLM brass cap per Map, Document No. 388745;

thence continuing along said west line of the Northwest one-quarter of Section 27 North 00°00'07" East, 662.18 feet to the northwest corner of the South one-half of the North one-half of the Northwest one-quarter of said Section 27, a found 1995 BLM brass cap;

thence along the north line of the South one-half of the North one-half of the Northwest one-quarter of said Section 27 North 88°34'40" East, 2636.43 feet to the POINT OF BEGINNING, containing 660.29 acres, more or less.

403934

0441785

BK1296PG4969

BK0698PG2773

The Basis of Bearing of this description is North 89°23'01" East, the north line of the Northeast one-quarter (NE $\frac{1}{4}$) of Section 26, T.14N., R.19E., M.D.M. per Map of Division Into Large Parcels for Little Mondeaux Limousin Corporation recorded July 31, 1992 as Document No. 284936.

Prepared By: R.O. ANDERSON ENGINEERING, INC.
P.O. Box 2294
Minden, Nevada 89423

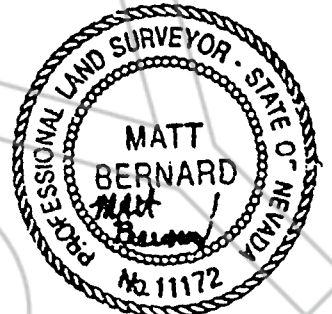

12-17-96

COPY

403934

0441785

BK1296PG4970

BK0698PG2774

DESCRIPTION
 PARCEL 24
 (Adjusted APN 15-060-03)

All that real property situate in the County of Douglas, State of Nevada, described as follows:

A parcel of land located within the Southeast one-quarter (SE $\frac{1}{4}$) of Section 22, and within portions of Sections 26 and 27, Township 14 North, Range 19 East, Mount Diablo Meridian, more particularly described as follows:

Commencing at the northwest corner of Section 26, T.12N., R.19E., M.D.M., a found 1985 BLM aluminum cap as shown on the Amended Record of Survey for Ronald Simek recorded May 28, 1996 in the office of Recorder, Douglas County, Nevada as Document No. 388745, the POINT OF BEGINNING;

thence South 20°20'03" West, 660.58 feet;

thence South 44°39'57" West, 485.08 feet;

thence South 22°05'14" West, 819.11 feet;

thence South 23°02'59" East, 707.48 feet;

thence North 76°07'21" East, 87.56 feet;

thence South 23°06'27" East, 578.41 feet;

thence North 81°33'57" East, 572.21 feet to a point on the westerly

line of Jacks Valley Road;

thence along said westerly line of Jacks Valley Road South 21°17'11" West, 905.19 feet;

thence North 45°25'40" West, 2700.25 feet;

thence North 47°23'05" West, 944.76 feet;

thence North 28°01'13" West, 274.46 feet;

thence North 39°22'48" East, 215.33 feet to the northwest corner of

the South one-half of the North one-half of the Northeast one-quarter of said Section 27, a found 1996 BLM brass cap;

thence along the west line of the Northwest one-quarter of the Northeast one-quarter of said Section 27 North 00°16'51" West, 667.52 feet to the north one-quarter corner of said Section 27, a found 1985 BLM aluminum cap;

thence along the west line of the Southeast one-quarter of said Section 22 North 00°05'09" East, 2646.46 feet to the northwest corner of the Southeast one-quarter of said Section 22, a found 1985 BLM aluminum cap;

thence along the north line of the Southeast one-quarter of said Section 22 North 89°05'23" East, 2658.40 feet to the east one-quarter corner of said Section 22, a found 1985 BLM aluminum cap;

thence along the east line of the Southeast one-quarter of said Section 22 South 00°05'51" East, 2654.73 feet to the POINT OF BEGINNING, containing 276.80 acres, more or less.

The Basis of Bearing of this description is North 89°23'01" East, the north line of the Northeast one-quarter (NE $\frac{1}{4}$) of Section 26, T.14N., R.19E., M.D.M. per Map of Division Into Large Parcels for Little Monocacy Limousin Corporation recorded July 31, 1992 as Document No. 284936

Prepared By: R.O. ANDERSON ENGINEERING, INC.
 P.O. Box 2294
 Minden, Nevada 89423

403934

BK1296PG4973

0441785

BK0698PG2775

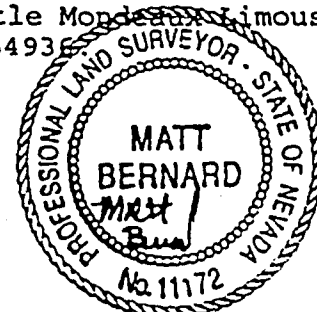

12-17-96

**DESCRIPTION
ADJUSTED PARCEL 21
(APN 15-060-68)**

All that real property situate in the County of Douglas, State of Nevada, described as follows:

A parcel of land located within a portion of the Southwest one-quarter (SW $\frac{1}{4}$) of Section 26, the Southwest one-quarter (SW $\frac{1}{4}$) and within a portion of the South one-half of the North one-half of the Northwest one-quarter (S $\frac{1}{2}$ N $\frac{1}{2}$ NW $\frac{1}{4}$), the South one-half of the Northwest one-quarter (S $\frac{1}{2}$ NW $\frac{1}{4}$), portions of the Northeast one-quarter (NE $\frac{1}{4}$), and portions of the Southeast one-quarter (SE $\frac{1}{4}$) of Section 27, and within the Northeast one-quarter of the Southeast one-quarter (NE $\frac{1}{4}$ SE $\frac{1}{4}$) of Section 28, portions of the Northeast one-quarter (NE $\frac{1}{4}$), portions of the Southeast one-quarter of the Northwest one-quarter (SE $\frac{1}{4}$ NW $\frac{1}{4}$), and within the North one-half of the Northwest one-quarter (N $\frac{1}{2}$ NW $\frac{1}{4}$) of Section 34, Township 14 North, Range 19 East, Mount Diablo Meridian, more particularly described as follows:

Commencing at the north one-quarter corner of Section 27, T.14N., R.19E., M.D.M., a found 1985 BLM aluminum cap as shown on the Amended Record of Survey for Ronald Simek recorded May 28, 1996 in the office of Recorder, Douglas County, Nevada as Document No. 388745;

thence along the westerly line of the Northeast one-quarter of said Section 27, South 00°16'51" East, 667.52 feet to a found 1996 BLM brass cap, the northwest corner of the South one-half of the North one-half of the Northeast one-quarter of said Section 27, as shown on the Record of Survey To Support A Boundary Line Adjustment for Ronald L. Simek, Little Mondeaux Limousin Corporation and The Pivot Limited Partnership recorded December 31, 1996 in the office of Recorder, Douglas County, Nevada as Document No. 403935, the POINT OF BEGINNING;

thence South 21°17'48" East, 904.81 feet;

thence South 53°33'58" East, 195.11 feet;

thence South 40°30'47" East, 1363.58 feet;

thence South 64°50'41" East, 460.73 feet;

thence South 45°26'07" East, 411.75 feet;

thence North 44°33'53" East, 416.04 feet;

thence North 81°33'57" East, 572.21 feet to a point on the westerly line of Jacks Valley Road;

thence along said westerly line of Jacks Valley Road, South

0441785

BK0698PG2776

21°17'11" West, 1417.33 feet to the northeasterly corner of Parcel 3-A as described in Quitclaim Deed recorded November 5, 1987 in the office of Recorder, Douglas County, Nevada, in Book 1187, at Page 757, as Document No. 165850;

thence the following six courses per said Quitclaim Deed;

thence North 80°27'30" West, 431.34 feet;

thence North 07°48'51" West, 117.97 feet;

thence West, 219.48 feet;

thence South 15°45'08" West, 251.57 feet;

thence South 00°55'37" East, 269.42 feet;

thence South 65°04'50" East, 559.20 feet to a point on said westerly line of Jacks Valley Road;

thence along said westerly line of Jacks Valley Road, South 21°17'11" West, 2899.93 feet;

thence North 68°42'49" West, 819.87 feet;

thence South 61°44'16" West, 636.46 feet;

thence South, 600.00 feet to a point on the south line of the Northwest one-quarter of said Section 34;

thence along said south line of the Northwest one-quarter of Section 34, South 89°09'36" West, 1121.09 feet to the southwest corner of the Southeast one-quarter of the Northwest one-quarter of said Section 34, a found 5/8" rebar and aluminum cap, RLS 3579;

thence along the west line of the Southeast one-quarter of the Northwest one-quarter of said Section 34, North 00°13'16" West, 1323.98 feet to the northwest corner of the Southeast one-quarter of the Northwest one-quarter of said Section 34, a found 5/8" rebar and aluminum cap, RLS 3579;

thence along the south line of the Northwest one-quarter of the Northwest one-quarter of said Section 34, South 89°10'48" West, 1323.12 feet to the southwest corner of the Northwest one-quarter of the Northwest one-quarter of said Section 34, a 5/8" rebar and aluminum cap per said Map, Document No. 388745;

thence along the west line of the Northwest one-quarter of the Northwest one-quarter of said Section 34, North 00°19'53" West, 1324.43 feet to the northwest corner of Section 34, a BLM brass cap per said Map, Document No. 388745;

thence along the west line of the Southwest one-quarter of said Section 27, North 00°11'37" West, 1310.03 feet to the northwest corner of the Southwest one-quarter of the Southwest one-quarter of said Section 27;

thence along the south line of the Northeast one-quarter of the Southeast one-quarter of said Section 28, South 89°45'03" West,

0441785

BK0698PG2777

1301.50 feet to the southwest corner of the Northeast one-quarter of the Southeast one-quarter of said Section 28;

thence along the west line of the Northeast one-quarter of the Southeast one-quarter of said Section 28, North $00^{\circ}06'59''$ West, 1310.98 feet to the northwest corner of the Northeast one-quarter of the Southeast one-quarter of said Section 28;

thence along the north line of the Northeast one-quarter of the Southeast one-quarter of said Section 28, North $89^{\circ}47'33''$ East, 1299.73 feet to the west one-quarter corner of said Section 27, a BLM brass cap per Map, Document No. 388745;

thence along the west line of the Northwest one-quarter of said Section 27, North $00^{\circ}00'49''$ West, 1324.56 feet to the northwest corner of the Southwest one-quarter of the Northwest one-quarter of said Section 27, a BLM brass cap per Map, Document No. 388745;

thence continuing along said west line of the Northwest one-quarter of Section 27, North $00^{\circ}00'07''$ East, 662.18 feet to the northwest corner of the South one-half of the North one-half of the Northwest one-quarter of said Section 27, a found 1995 BLM brass cap;

thence along the north line of the South one-half of the North one-half of the Northwest one-quarter of said Section 27, North $88^{\circ}34'40''$ East, 2636.43 feet to the POINT OF BEGINNING, containing 663.97 acres, more or less.

The Basis of Bearing of this description is North $89^{\circ}23'01''$ East, the north line of the Northeast one-quarter (NE $\frac{1}{4}$) of Section 26, T.14N., R.19E., M.D.M. per Map of Division Into Large Parcels for Little Mondeaux Limousin Corporation recorded July 31, 1992 as Document No. 284936.

Prepared By: R.O. ANDERSON ENGINEERING, INC.
P.O. Box 2294
Minden, Nevada 89423

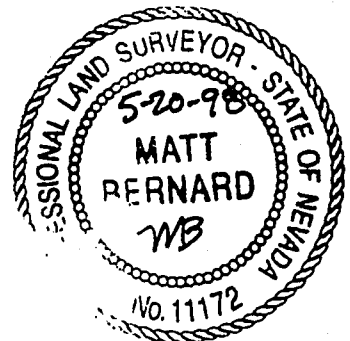

0441785

BK0698PG2778

DESCRIPTION
ADJUSTED PARCEL 24
(APN 15-060-69)

All that real property situate in the County of Douglas, State of Nevada, described as follows:

A parcel of land located within the Southeast one-quarter (SE $\frac{1}{4}$) of Section 22, and within portions of Section 27, Township 14 North, Range 19 East, Mount Diablo Meridian, more particularly described as follows:

Commencing at the northwest corner of Section 26, T.14N., R.19E., M.D.M., a found 1985 BLM aluminum cap as shown on the Amended Record of Survey for Ronald Simek recorded May 28, 1996 in the office of Recorder, Douglas County, Nevada as Document No. 388745, and an easterly corner of Parcel 24 as shown on the Record of Survey To Support A Boundary Line Adjustment for Ronald L. Simek, Little Mondeaux Limousin Corporation and The Pivot Limited Partnership recorded December 31, 1996 in the office of Recorder, Douglas County, Nevada as Document No. 403935, the POINT OF BEGINNING;

thence South 20°20'03" West, 660.58 feet;

thence South 44°39'57" West, 485.08 feet;

thence South 22°05'14" West, 819.11 feet;

thence South 23°02'59" East, 707.48 feet;

thence North 76°07'21" East, 87.56 feet;

thence South 23°06'27" East, 578.41 feet;

thence South 44°33'53" West, 416.04 feet;

thence North 45°26'07" West, 411.75 feet;

thence North 64°50'41" West, 460.73 feet;

thence North 40°30'47" West, 1363.58 feet;

thence North 53°33'58" West, 195.11 feet;

thence North 21°17'48" West, 904.81 feet to the northwest corner of the South one-half of the North one-half of the Northeast one-quarter of said Section 27, a found 1996 BLM brass cap;

thence along the west line of the Northwest one-quarter of the Northeast one-quarter of said Section 27, North 00°16'51" West, 667.52 feet to the north one-quarter corner of said Section 27, a found 1985 BLM aluminum cap;

0441785

BK0698PG2779

thence along the west line of the Southeast one-quarter of said Section 22, North 00°05'09" East, 2646.46 feet to the northwest corner of the Southeast one-quarter of said Section 22, a found 1985 BLM aluminum cap;

thence along the north line of the Southeast one-quarter of said Section 22, North 89°05'23" East, 2658.40 feet to the east one-quarter corner of said Section 22, a found 1985 BLM aluminum cap;

thence along the east line of the Southeast one-quarter of said Section 22, South 00°05'51" East, 2654.73 feet to the POINT OF BEGINNING, containing 273.12 acres, more or less.

The Basis of Bearing of this description is North 89°23'01" East, the north line of the Northeast one-quarter (NE $\frac{1}{4}$) of Section 26, T.14N., R.19E., M.D.M. per Map of Division Into Large Parcels for Little Mondeaux Limousin Corporation recorded July 31, 1992 as Document No. 284936.

Prepared By: R.O. ANDERSON ENGINEERING, INC.
P.O. Box 2294
Minden, Nevada 89423

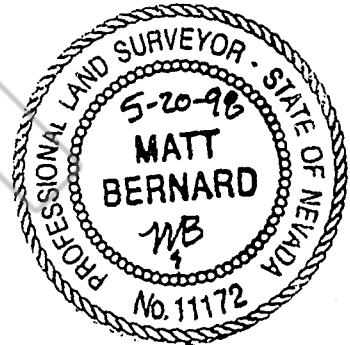

REQUESTED BY
STEWART TITLE OF DOUGLAS COUNTY
IN OFFICIAL RECORDS OF
DOUGLAS CO., NEVADA

'98 JUN 11 P3:17

LINDA SLATER
RECORDER
\$17⁰⁰ PAID 12 DEPUTY

0441785

BK0698PG2780