

LEGAL DESCRIPTION

The land referred to herein is situated in the State of Nevada, County of Douglas, described as follows:

Lot 19, as set forth on the map of Pleasant Meadow Subdivision, filed for record in the office of the Douglas County Recorder on October 12, 1993 in Book 1093, at Page 1611, as Document No. 319836, Official Records of Douglas County, Nevada.

Assessor's Parcel No. 37-630-19.

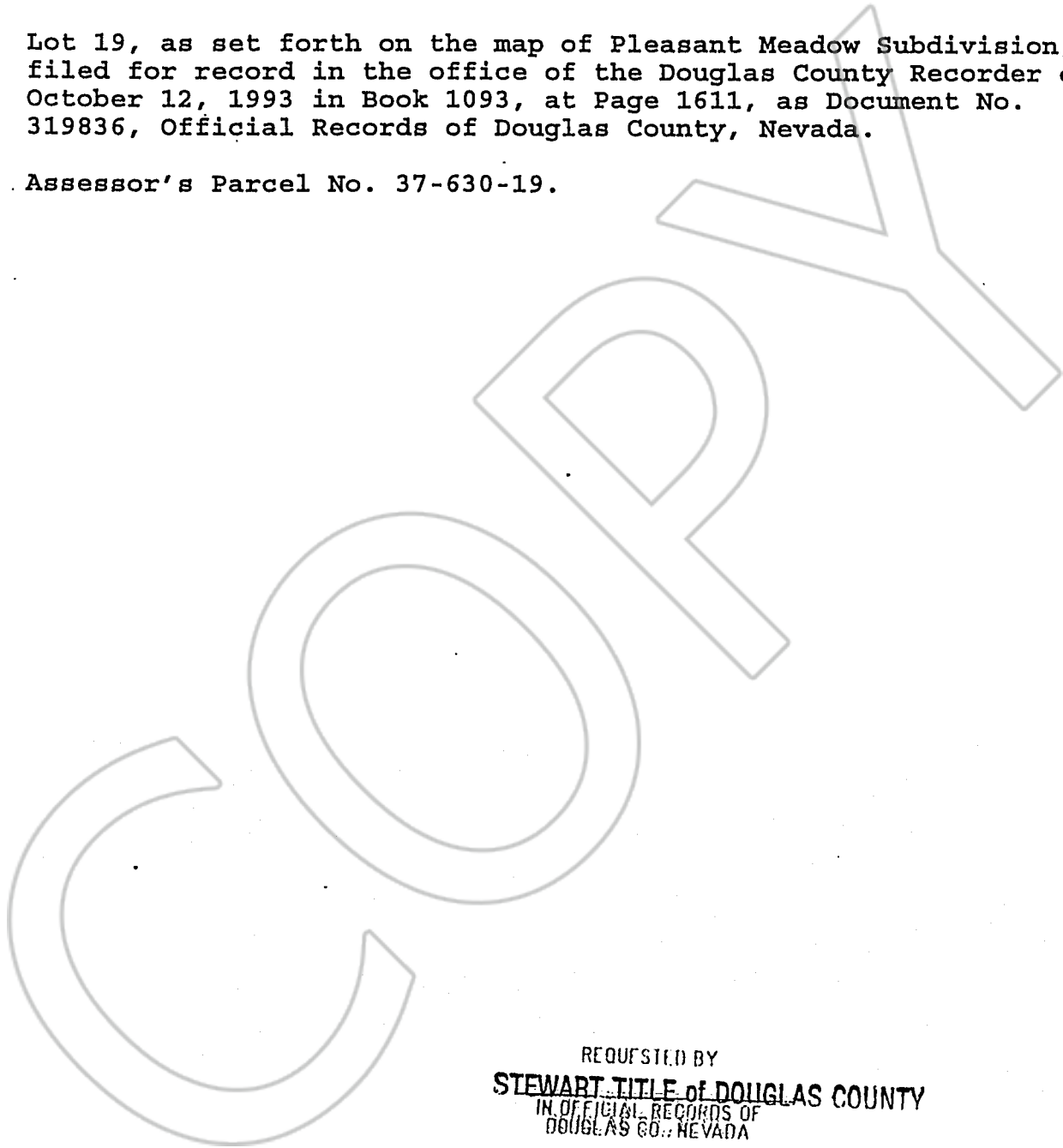

REQUESTED BY
STEWART TITLE OF DOUGLAS COUNTY
IN OFFICIAL RECORDS OF
DOUGLAS CO., NEVADA

'98 JUL 31 P1:12

0445927

LINDA SLATER
RECORDER

J. Co. PAID *OK* DEPUTY

SCHEDULE A

CLTA PRELIMINARY REPORT

(7/88)

BK 0798 PG 7230

STEWART TITLE

Guaranty Company