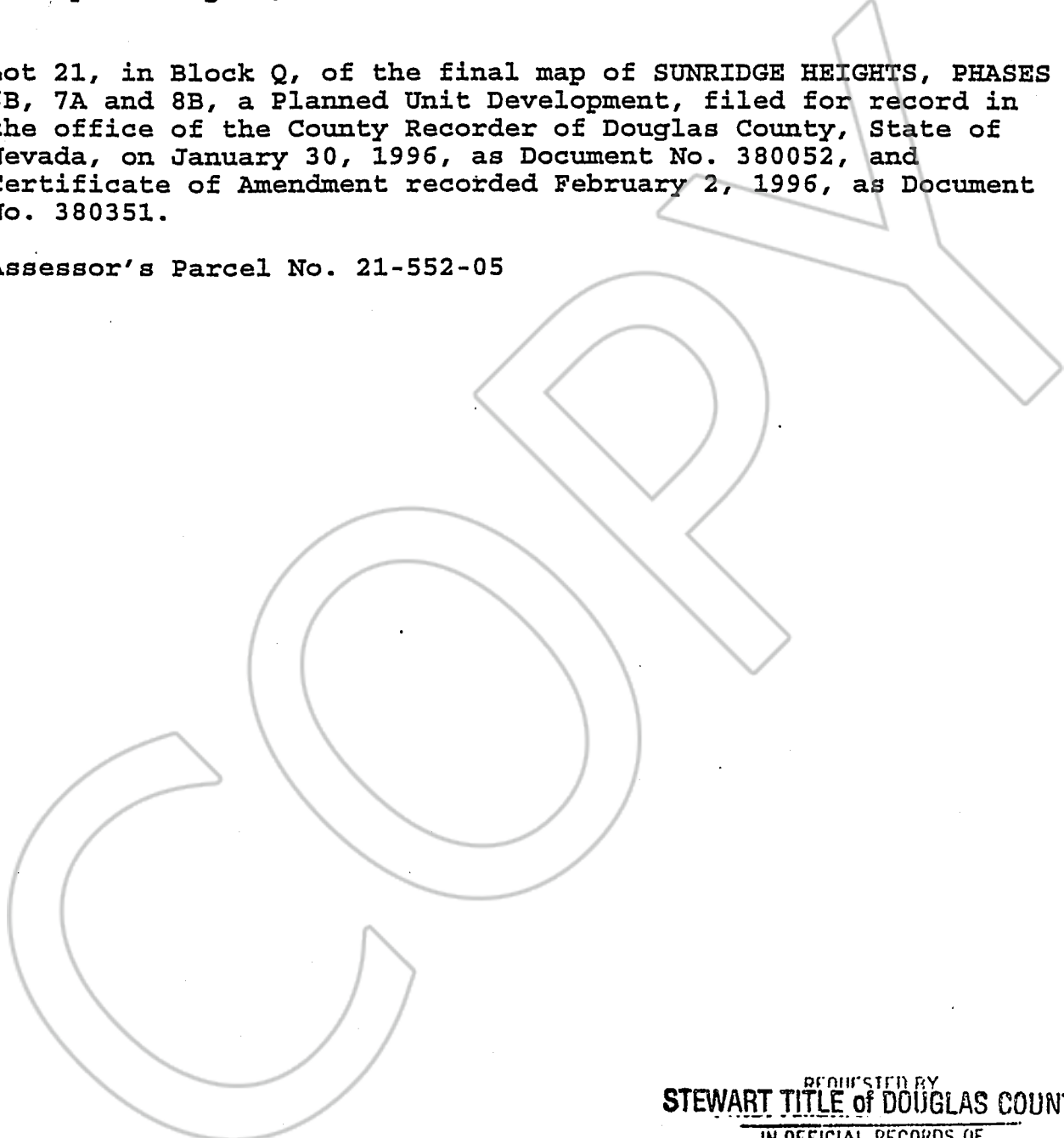

EXHIBIT "A"
LEGAL DESCRIPTION

The land referred to herein is situated in the State of Nevada,
County of Douglas, described as follows:

Lot 21, in Block Q, of the final map of SUNRIDGE HEIGHTS, PHASES
6B, 7A and 8B, a Planned Unit Development, filed for record in
the office of the County Recorder of Douglas County, State of
Nevada, on January 30, 1996, as Document No. 380052, and
Certificate of Amendment recorded February 2, 1996, as Document
No. 380351.

Assessor's Parcel No. 21-552-05



REGISTERED BY
STEWART TITLE of DOUGLAS COUNTY
IN OFFICIAL RECORDS OF
DOUGLAS CO., NEVADA

'98 AUG 12 P3:24

0446961

BK0898PG2624

LINDA SLATER
RECORDER
s. *[Signature]* PAID *[Signature]* DEPUTY