

WHEN RECORDED MAIL TO:
WELLS FARGO BANK, N.A.
111 SUTTER STREET 22ND FLOOR
SAN FRANCISCO, CA 94163

Order No.
Escrow No. M75691CH
R.P.T.T. 32.50
XXX Based of full value
Based on full value
less liens

BOUNDARY LINE ADJUSTMENT GRANT DEED

THIS INDENTURE WITNESSETH:

That for a valuable consideration, receipt of which is hereby acknowledged, STRATTON CENTER NORTH, a Nevada Partnership

(GRANTOR),
does hereby grant, bargain, sell, and convey to
WELLS FARGO BANK, N.A. A NATIONAL BANKING ASSOCIATION

(GRANTEE),
all that real property in the County of DOUGLAS, State of Nevada,
being Assessor's Parcel Number Portion 1320-32-602-002, specifically described as:

SEE EXHIBIT "A" ATTACHED HERETO AND MADE A PART HEREOF

Together with all singular the tenements, hereditaments and appurtenances thereunto belonging or in anywise appertaining, and any reversions, remainders, rents, issues or profits thereof.

Dated April 10, 1998

STATE OF NEVADA)
County of DOUGLAS) SS.

Edgar James Stratton Trustee
EDGAR JAMES STRATTON, TRUSTEE
Mary Jane Stratton Trustee
MARY JANE STRATTON, TRUSTEE
Daniel Wade Stratton
DANIEL WADE STRATTON
Steven Craig Stratton
STEVEN CRAIG STRATTON

This instrument was acknowledged before me on April 25, 1998 by EDGAR JAMES STRATTON, TRUSTEE MARY JANE STRATTON, TRUSTEE, DANIEL WADE STRATTON AND STEVEN CRAIG STRATTON

MAIL TAX STATEMENT TO:

Charlene L. Hanover
Notary Public

FOR RECORDER'S USE

CHARLENE L. HANOVER
Notary Public - State of Nevada
Appointment Recorded in Douglas County
MY APPOINTMENT EXPIRES JAN. 27, 1999

LEGAL DESCRIPTION
(Portion of Parcel 4 to New Parcel III A)

That portion of the southwest $\frac{1}{4}$ of the northeast $\frac{1}{4}$ of Section 32, Township 13 North, Range 20 East, M.D.B. & M. In the County of Douglas, State of Nevada, being more particularly described as follows:

Beginning at the most easterly corner of Parcel III of that certain Parcel Map recorded in Book 781 at Page 1137 as Document No. 58301 of the Official Records of said Douglas County; thence northwesterly along the northeasterly line of said Parcel III, N. $44^{\circ} 54' 00''$ W., 150.00 feet to the most northerly corner of said Parcel III; thence N. $45^{\circ} 06' 00''$ E., 25.00 feet to a point on the southwesterly right-of-way line of U.S. Highway 395; thence southeasterly along said right-of-way line S. $44^{\circ} 54' 00''$ E., 150.00 feet; thence S. $45^{\circ} 06' 00''$ W., 25.00 feet to the Point of Beginning.

Said Parcel Contains 0.086 acres (3750 square feet), more or less.

Prepared By:

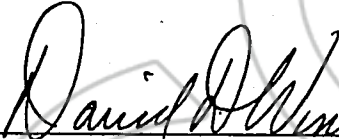

David D. Winchell, PLS 3209

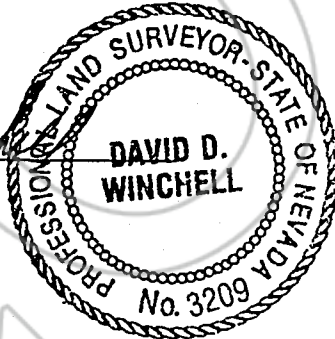

4/22/98

Date

REQUESTED BY
WESTERN TITLE COMPANY, INC.
IN OFFICIAL RECORDS OF
DOUGLAS CO., NEVADA

'98 SEP -1 P3:42

0448572

BK0998PG0246

LINDA SLATER
RECORDER
\$ 800 PAID *SL* DEPUTY