

WHEN RECORDED MAIL TO:
WELLS FARGO BANK, N.A.
111 SUTTER STREET 22nd FLOOR
SAN FRANCISCO, CA 94163

Order No.
Escrow No. M75691CH
R.P.T.T. -0- BOUNDARY LINE
Based of full value ^{ADJ}
Based on full value
less liens

BOUNDARY LINE ADJUSTMENT GRANT DEED

THIS INDENTURE WITNESSETH:

That for a valuable consideration, receipt of which is hereby acknowledged, WELLS FARGO BANK, N.A., A NATIONAL BANKING ASSOCIATION

(GRANTOR),
does hereby grant, bargain, sell, and convey to
WELLS FARGO BANK, N.A. A NATIONAL BANKING ASSOCIATION

(GRANTEE),
all that real property in the County of DOUGLAS, State of Nevada,
being Assessor's Parcel Number Portion 1320-32-602-002 and 1320-32-602-003, specifically described as:

SEE EXHIBIT "A" ATTACHED HERETO AND MADE A PART HEREOF

Together with all singular the tenements, hereditaments and appurtenances thereunto belonging or in anywise appertaining, and any reversions, remainders, rents, issues or profits thereof.

Dated April 10, 1998

STATE OF ^{California} NEVADA)
County of San Francisco) SS.

WELLS FARGO BANK, N.A.
Jeffery W. Rader
BY: JEFFERY W. RADER,
VICE PRESIDENT

This instrument was acknowledged
before me on April 30, 1998
by JEFFERY W. RADER

MAIL TAX STATEMENT TO:

Geoffrey M. Lewis
Notary Public

.....
FOR RECORDER'S USE
.....

 GEOFFREY M. LEWIS
COMM. #1146454
NOTARY PUBLIC-CALIFORNIA
SAN FRANCISCO COUNTY
My Comm. Expires July 11, 2001

0448574

BK0998PG0249

LEGAL DESCRIPTION
(New Parcel III A)

That portion of the southwest ¼ of the northeast ¼ of Section 32, Township 13 North, Range 20 East, M.D.B. & M. In the County of Douglas, State of Nevada, being more particularly described as follows:

Beginning at the most westerly corner of Parcel III of that certain Parcel Map recorded in Book 781 at Page 1137 as Document No. 58301 of the Official Records of said Douglas County; thence northeasterly along the northwesterly line of said Parcel III, N. 45° 06' 00" E., 175.00 feet to a point on the southwesterly right-of-way line of U.S. Highway 395; thence southeasterly along said right-of-way line S. 44° 54' 00" E., 150.00 feet; thence S. 45° 06' 00" W., 175.00 feet to the most southerly corner of said Parcel III; thence northwesterly along the southwesterly line of said Parcel III, N. 44° 54' 00" W., 150.00 feet to the Point of Beginning.

Said Parcel Contains 0.603 acres, more or less.

Prepared By:

David D. Winchell

David D. Winchell, PLS 3209

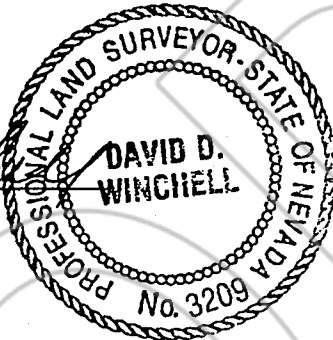

4/22/98

Date

REQUESTED BY
WESTERN TITLE COMPANY, INC.
IN OFFICIAL RECORDS OF
DOUGLAS CO., NEVADA

'98 SEP -1 P3:47

0448574

BK0998PG0250

LINDA SLATER
RECORDER

\$ *see* PAID *SL* DEPUTY