

GRANT, BARGAIN and SALE DEED

THIS INDENTURE WITNESSETH: That JOYCE RUBLE, WIFE OF GRANTEE

in consideration of \$10.00, the receipt of which is hereby acknowledged, does hereby Grant, Bargain Sell and Convey to HARRY RUBLE, A MARRIED MAN AS HIS SOLE AND SEPARATE PROPERTY

and to the heirs and assigns of such Grantee forever, all that real property situated in the County of State of Nevada, bounded and described as follows: SEE EXHIBIT "A" ATTACHED HERETO AND MADE A PART HEREOF FOR LEGAL DESCRIPTION OF SUBJECT PROPERTY...

IT IS THE EXPRESS INTENT OF THE GRANTOR, BEING THE SPOUSE OF THE GRANTEE, TO CONVEY ALL RIGHT, TITLE AND INTEREST OF THE GRANTOR, COMMUNITY OR OTHERWISE, IN AND TO THE HEREIN DESCRIBED PROPERTY TO THE GRANTEE AS GRANTEE'S SOLE AND SEPARATE PROPERTY.

Together with all and singular the tenements, hereditaments and appurtenances thereunto belonging or in anywise appertaining, and any reversions, remainders, rents, issues or profits thereof.

DATE: September 25, 1998

Joyce Ruble
JOYCE RUBLE

STATE OF Nevada
COUNTY OF Douglas } ss.



This instrument was acknowledged before me on 9-28-98
by Joyce Ruble

(This area above for official notarial seal)

Signature Mary H. Kelsch
Notary Public

RECORDING REQUESTED BY: STEWART TITLE COMPANY

WHEN RECORDED MAIL TO: HARRY RUBLE
1025 Arrowhead
Gardnerville
NV 89410

MAIL TAX STATEMENTS TO: same

0450772
BK0998PG6879

LEGAL DESCRIPTION

The land referred to herein is situated in the State of Nevada, County of Douglas, described as follows:

Lot 324, as said lot is shown on the Official Plat of GARDNERVILLE RANCHOS UNIT NO. 2, filed in the office of the County Recorder of Douglas County, Nevada, on June 1, 1965, in Book 1 of Maps, filed as No. 28309, and Title Sheet amended on June 4, 1965, as Filing No. 28377.

Assessor's Parcel No. 27-312-06

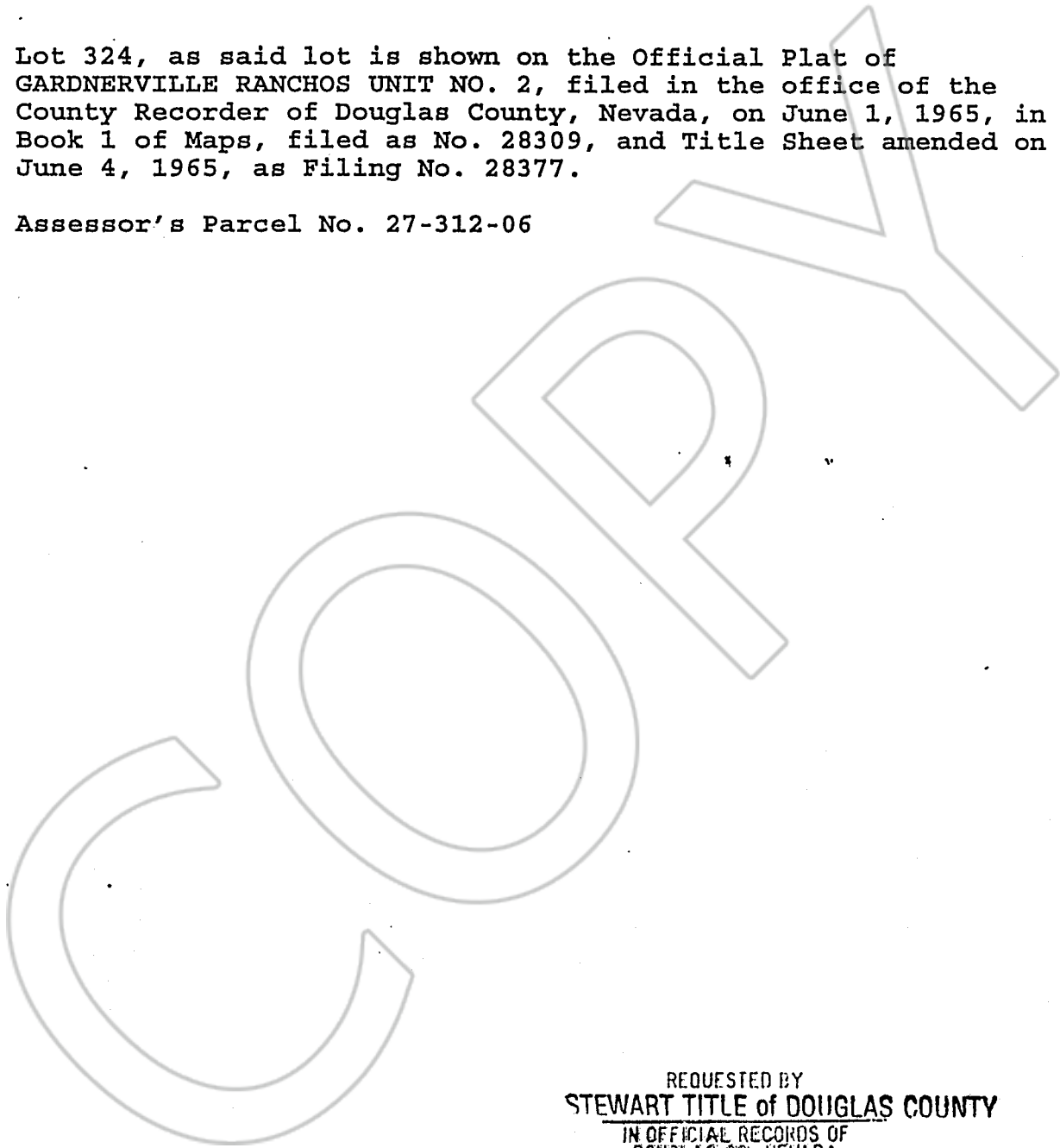

REQUESTED BY
STEWART TITLE OF DOUGLAS COUNTY
IN OFFICIAL RECORDS OF
DOUGLAS CO., NEVADA

'98 SEP 30 P4:51

LINDA SLATER
RECORDER

\$ 8.00 PAID ke DEPUTY STEWART TITLE
Guaranty Company

0450772

BK0998PG6880