

Exempt #3

GRANT, BARGAIN and SALE DEED

THIS INDENTURE WITNESSETH: That

JOHN W. BARTON AND WILLOW K. BARTON, HUSBAND AND WIFE AS JOINT TENANTS

in consideration of \$10.00, the receipt of which is hereby acknowledged, does hereby Grant, Bargain Sell and Convey to

JOHN W. BARTON AND WILLOW K. BARTON, HUSBAND AND WIFE AS JOINT TENANTS

and to the heirs and assigns of such Grantee forever, all that real property situated in the County of DOUGLAS State of Nevada, bounded and described as follows:

AS PER EXHIBIT "A" ATTACHED HERETO AND MADE A PART HEREOF

THIS DEED IS BEING RECORDED TO PERFECT A LOT LINE ADJUSTMENT AND RECORD OF SURVEY.

Together with all and singular the tenements, hereditaments and appurtenances thereunto belonging or in anywise appertaining, and any reversions, remainders, rents, issues or profits thereof.

DATE: OCTOBER 15, 1998

John W. Barton
JOHN W. BARTON

Willow K. Barton
WILLOW K. BARTON

STATE OF Washington }
COUNTY OF King } ss.

This instrument was acknowledged before me on Oct 20, 1998,
by John W. Barton
Willow K. Barton

Signature Mary F. Cleary
Notary Public

RECORDING REQUESTED BY:

WHEN RECORDED MAIL TO: MAIL TAX STATEMENTS TO:

11217 82nd place
N.E. Kirkland, Wa
98034

SEAL



(This area above for official notarial seal)

0452285
BK1098PG4453

DESCRIPTION
Adjusted Lot 104

All that real property situate in the County of Douglas,
State of Nevada, described as follows:

All that portion of Lots 101 and 104 as shown on the map of
Zephyr Knolls Unit No.4, filed for record on October 9,
1957, Document No.12699, more particularly described as
follows:

Beginning at the North corner of said Lot 104;
thence South 00 52'30" West 156.16 feet;
thence along a curve concave to the Southeast with a radius
of 45.00 feet, a central angle of 99 05'34" and an arc
length of 77.83 feet, the chord of said curve bears South 49
10'00" West 68.48 feet;
thence South 89 37'14" West 59.62 feet;
thence North 16 36'37" East 91.37 feet;
thence North 28 55'36" East 85.08 feet;
thence North 49 50'00" East 60.91 feet to the Point of
Beginning.

Containing 12,498 square feet.

The basis of bearing for this description is Zephyr Knolls
Unit No.4, filed for record on October 9, 1957, Document
No.12699.

Note: Refer this description to your title company
before incorporating into any legal document.

Prepared by: Turner & Associates, Inc.
Land Surveying
PO Box 5067
Stateline, NV 89449

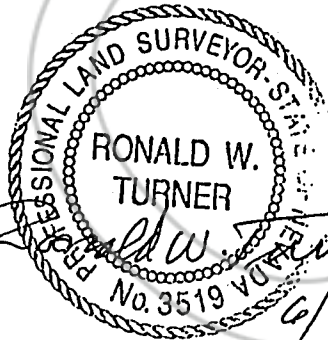

APN 0000-05-141-420

REQUESTED BY
STEWART TITLE OF DOUGLAS COUNTY
IN OFFICIAL RECORDS OF
DOUGLAS CO., NEVADA

'98 OCT 22 P3:52

0452285

BK1098PG4454

LINDA SLATER
RECORDER
\$ 8.00 PAID DEPUTY