

LEGAL DESCRIPTION

The land referred to herein is situated in the State of Nevada,
County of Douglas, described as follows:

Lot 183, as shown on the map of SKYLAND SUBDIVISION NO. 3, filed
in the office of the County Recorder of Douglas County, Nevada,
on February 24, 1960, as Document No. 15653.

Assessor's Parcel No. 05-043-200

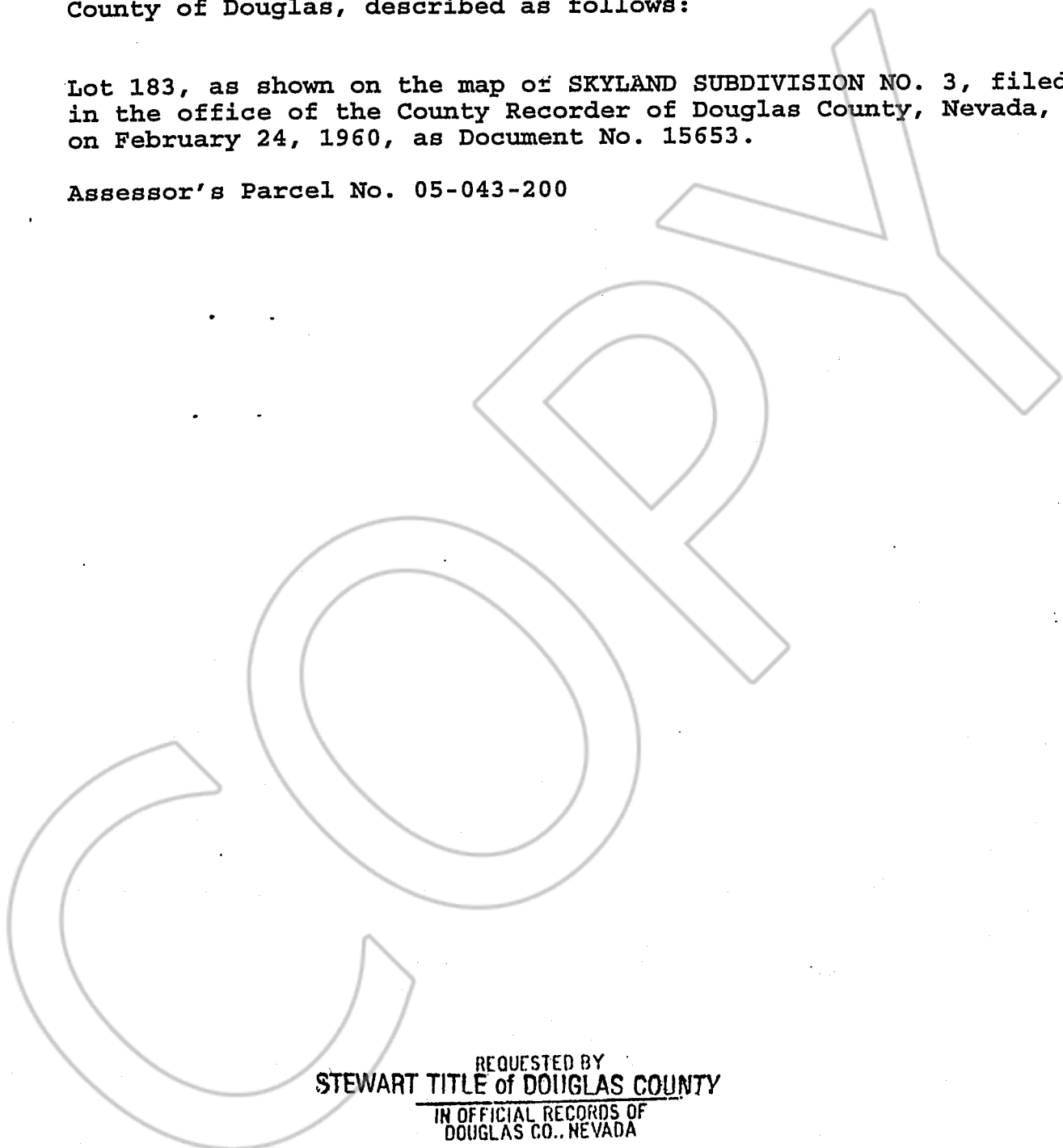

REQUESTED BY
STEWART TITLE of DOUGLAS COUNTY
IN OFFICIAL RECORDS OF
DOUGLAS CO., NEVADA

'98 DEC -4 P2:37

SCHEDULE A
CLTA PRELIMINARY REPORT
(7/88)

LINDA SLATER
RECORDER
\$8⁰⁰ PAID *Bh* DEPUTY

045577 | STEWART TITLE
Guaranty Company

BK 1298 PG 1333