

### GRANT, BARGAIN and SALE DEED

THIS INDENTURE WITNESSETH: That KEITH L. SIEBERT, TRUSTEE AND MICHELE SIEBERT, TRUSTEE OF THE KEITH L. SIEBERT AND MICHELE SIEBERT FAMILY LIVING TRUST DATED APRIL 29, 1991

in consideration of \$10.00, the receipt of which is hereby acknowledged, does hereby Grant, Bargain Sell and Convey to ~~BRIAN TRUTE AND KATHY TRUTE~~ /husband and wife/as ~~Joint Tenants/~~

BRIAN TRUTE AND KATHY TRUTE, HUSBAND AND WIFE AS JOINT TENANTS

and to the heirs and assigns of such Grantee forever, all that real property situated in the unincorporated area County of DOUGLAS State of Nevada, bounded and described as follows:  
SEE EXHIBIT "A" ATTACHED HERETO AND MADE A PART HEREOF

THIS DOCUMENT IS BEING RE-RECORDED TO CORRECT THE SPELLING OF THE GRANTEE

Together with all and singular the tenements, hereditaments and appurtenances thereunto belonging or in anywise appertaining, and any reversions, remainders, rents, issues or profits thereof.

DATE: September 21, 1998

*Keith Siebert*  
\_\_\_\_\_  
KEITH L. SIEBERT, TRUSTEE

*Michele Siebert*  
\_\_\_\_\_  
MICHELE SIEBERT, TRUSTEE

STATE OF CALIFORNIA }  
          CONTRA COSTA } ss.  
COUNTY OF DOUGLAS }

This instrument was acknowledged before me on October 8<sup>th</sup> 1998  
by, KEITH LEON SIEBERT / MICHELE SIEBERT

(This area above for official notarial seal)

Signature *Mitchell Newman*  
Notary Public

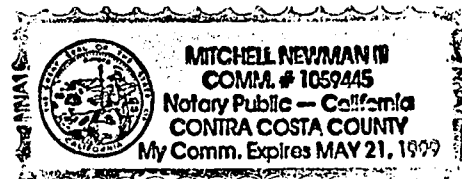

RECORDING REQUESTED BY:

STEWART TITLE COMPANY

WHEN RECORDED MAIL TO:

MR. AND MRS. TRUTE  
707 Winners Circle  
Gardnerville, Nv 89410

MAIL TAX STATEMENTS TO:

SAME

0456931

0452061

BK 1298PG4743

BK 1098PG3696

*Exhibit A*

LEGAL DESCRIPTION

The land referred to herein is situated in the State of Nevada, County of Douglas, described as follows:

All that certain lot, piece or parcel of land situate in the Northwest 1/4 of Section 32, Township 14 North, Range 20 East, M.D.B.&M., Douglas County, Nevada, further described as follows:

Parcel 25A, as set forth on the Parcel Map for FRANK PETRASICH, filed for record in the office of the County Recorder, Douglas County, Nevada on June 24, 1991, in Book 691, Page 3494, as Document No. 253524.

A.P.N. 21-290-71

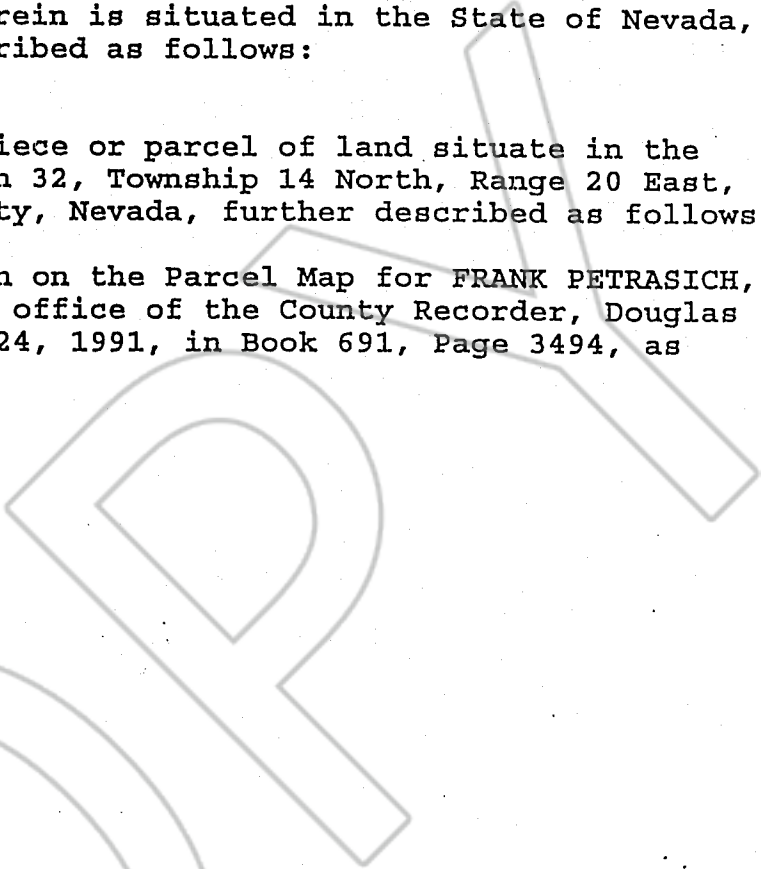

BK 1298PG4744  
0456931

REQUESTED BY  
**STEWART TITLE of DOUGLAS COUNTY**  
IN OFFICIAL RECORDS OF  
DOUGLAS CO., NEVADA

'98 OCT 19 P4:42

LINDA SLATER  
RECORDER  
\$8.00 PAID *KG* DEPUTY

**STEWART TITLE**  
Guaranty Company

SCHEDULE A  
CLTA PRELIMINARY REPORT  
(7/88)

0452061  
BK 1098PG3697

COPY

REQUESTED BY  
**STEWART TITLE of DOUGLAS COUNTY**  
IN OFFICIAL RECORDS OF  
DOUGLAS CO., NEVADA

'98 DEC 18 P3:17

0456931  
BK 1298PG4745

LINDA SLATER  
RECORDER  
\$ 9.00 PAID 22 DEPUTY