

All that certain lot, piece or parcel of land situate in the County of Douglas, State of Nevada, described as follows:

PARCEL 1:

Lots 1, 2, 3, 4, and 5, in Block L, as shown on the map of TOWN OF MINDEN, filed for record in the office of the County Recorder of Douglas County, State of Nevada, on July 2, 1906, as Document No. 20840.

A.P.N. 1320-32-111-020

PARCEL 2:

All that certain lot, piece or parcel of land situate in the County of Douglas, State of Nevada, described as follows:

Lots 17, 18, 19 and 20, in Block L, as shown on the map of TOWN OF MINDEN, filed for record in the office of the County Recorder of Douglas County, State of Nevada, on July 2, 1906, as Document No. 20840.

A.P.N. 1320-32-111-024

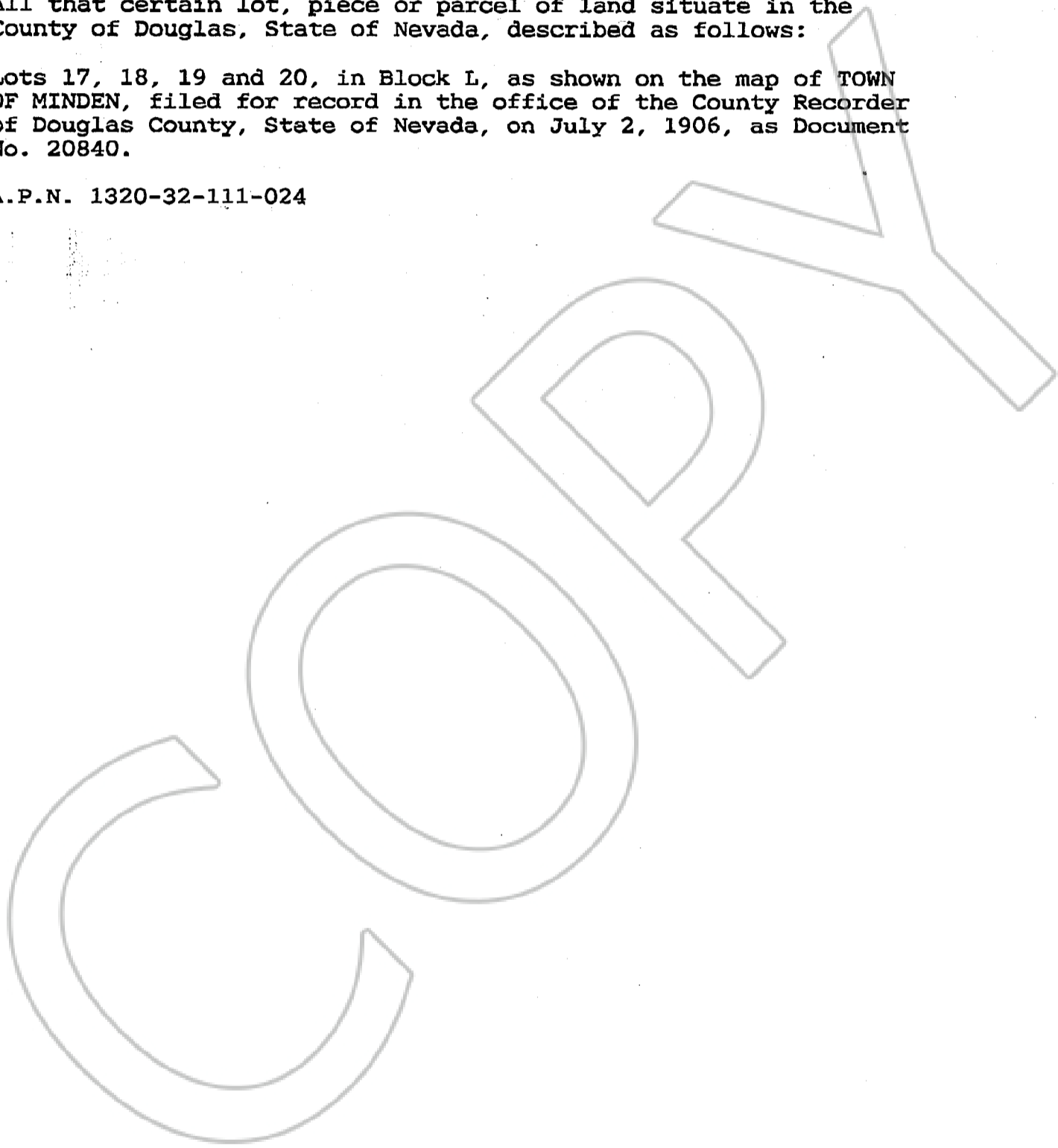

REQUESTED BY
WESTERN TITLE COMPANY, INC.
THE OFFICIAL RECORDS OF
DOUGLAS CO., NEVADA

'98 DEC 18 P3:45

0456948

LINDA SLATER
RECORDER
\$8⁰⁰ PAID *SL* DEPUTY

BK 1298PG4807