



LEGAL DESCRIPTION

The land referred to herein is situated in the State of Nevada,  
County of Douglas, described as follows:

Lot 3, in Block D, as shown on the Final Map of Valley Vista  
Estates 1, Phase 1B filed for record in the office of the  
Douglas County Recorder on June 2, 1995 in Book 695, Page 389  
as Document No. 363386, Official Records.

Assessors Parcel No. 13-333-16

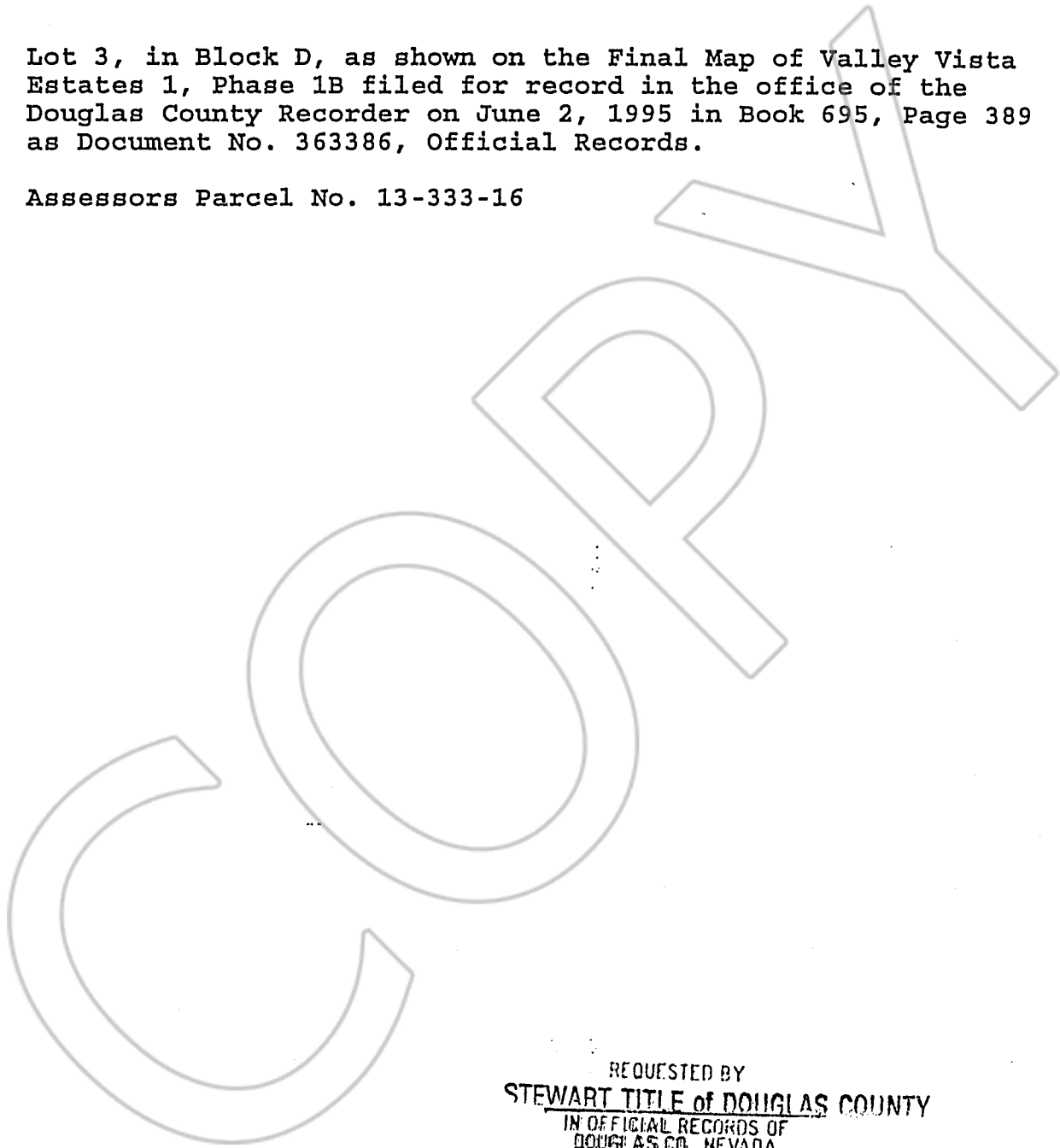

REQUESTED BY  
STEWART TITLE of DOUGLAS COUNTY  
IN OFFICIAL RECORDS OF  
DOUGLAS CO., NEVADA

'99 JAN 29 P3:01

0459947

SCHEDULE A  
CLTA PRELIMINARY REPORT  
(7/88)

BK 0199 PG 6091

LINDA SLATER  
RECORDER  
\$8<sup>00</sup> PAID *KS* DEPUTY

STEWART TITLE  
Guaranty Company