

All that certain lot, piece or parcel of land situate in the County of Douglas, State of Nevada, described as follows:

The land referred to herein is situated on the State of Nevada, County of Douglas, described as follows:

PARCEL 1:

The East 1/2 of the Southwest 1/4 of the Northwest 1/4 of the Northwest 1/4 of Section 29, Township 10 North, Range 22 East, M.D.B.&M.

EXCEPTING THEREFROM the North 264.00 feet thereof.

A.P.N. 39-070-01

PARCEL 2:

The West 1/2 of the Southwest 1/4 of the Northwest 1/4 of the Northwest 1/4 of Section 29, Township 10 North, Range 22 East, M.D.B.&M.

Assessors Parcel No. 39-070-11

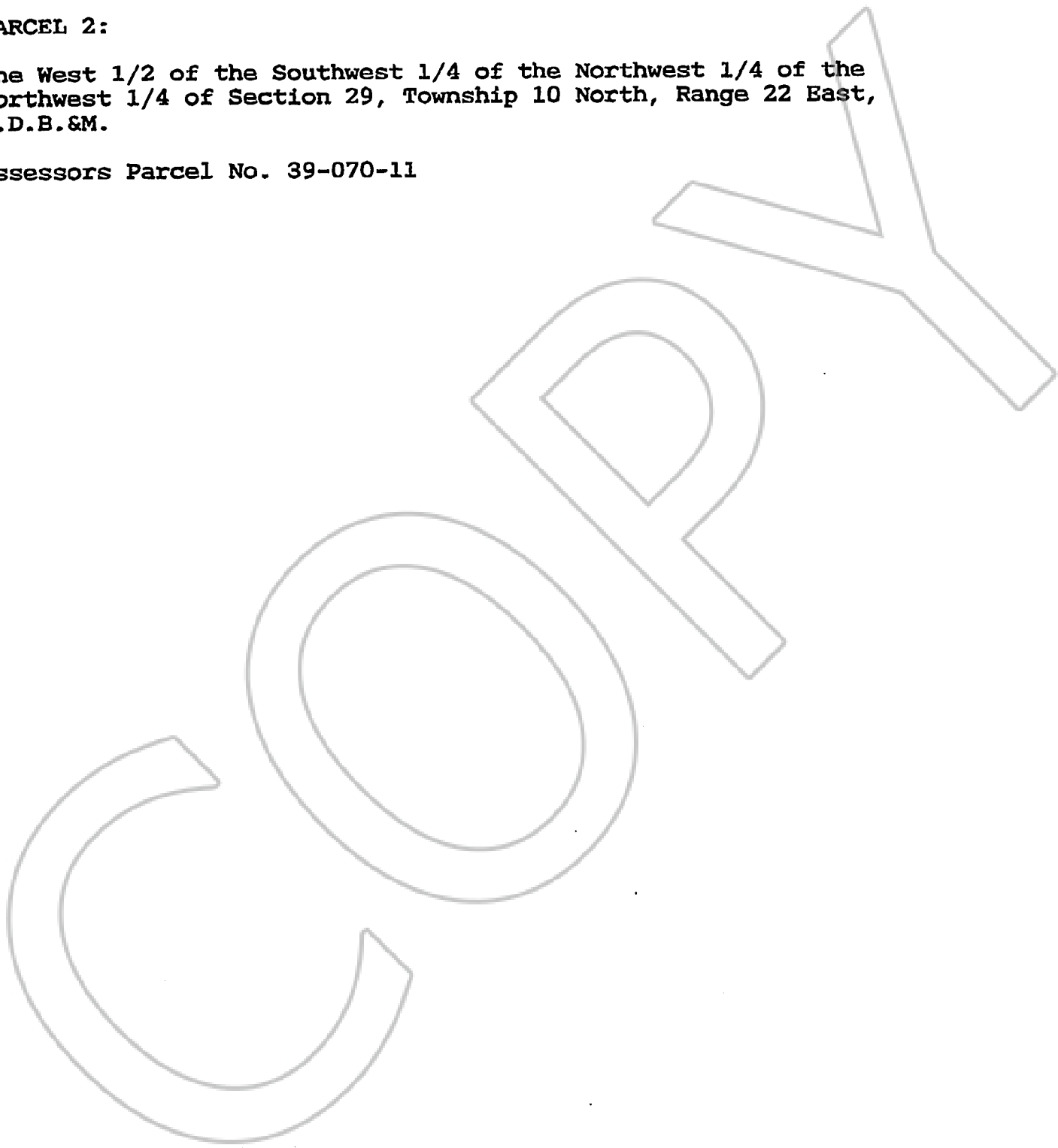

REQUESTED BY
WESTERN TITLE COMPANY, INC.
IN OFFICIAL RECORDS OF
DOUGLAS CO., NEVADA

'99 FEB 17 P3:37

0461367
BK0299PG3532

LINDA SLATER
RECORDER
\$ 8.00 PAID *to* DEPUTY