

EXHIBIT "A"

LEGAL DESCRIPTION

ESCROW NO.: 98041381

The land referred to herein is situated in the County of Douglas, State of Nevada, described as follows:

Lot 27, in Block M, as set forth on that certain Final Map of SUNRIDGE HEIGHTS, PHASES 7B and 9, a Planned Unit Development, recorded in the office of the County Recorder on September 5, 1995 in Book 995, Page 410, as Document No. 369825, and by Certificate of Amendment recorded August 14, 1996, in Book 896, Page 2588, as Document NO. 394289.

A.P.N. 21-530-27

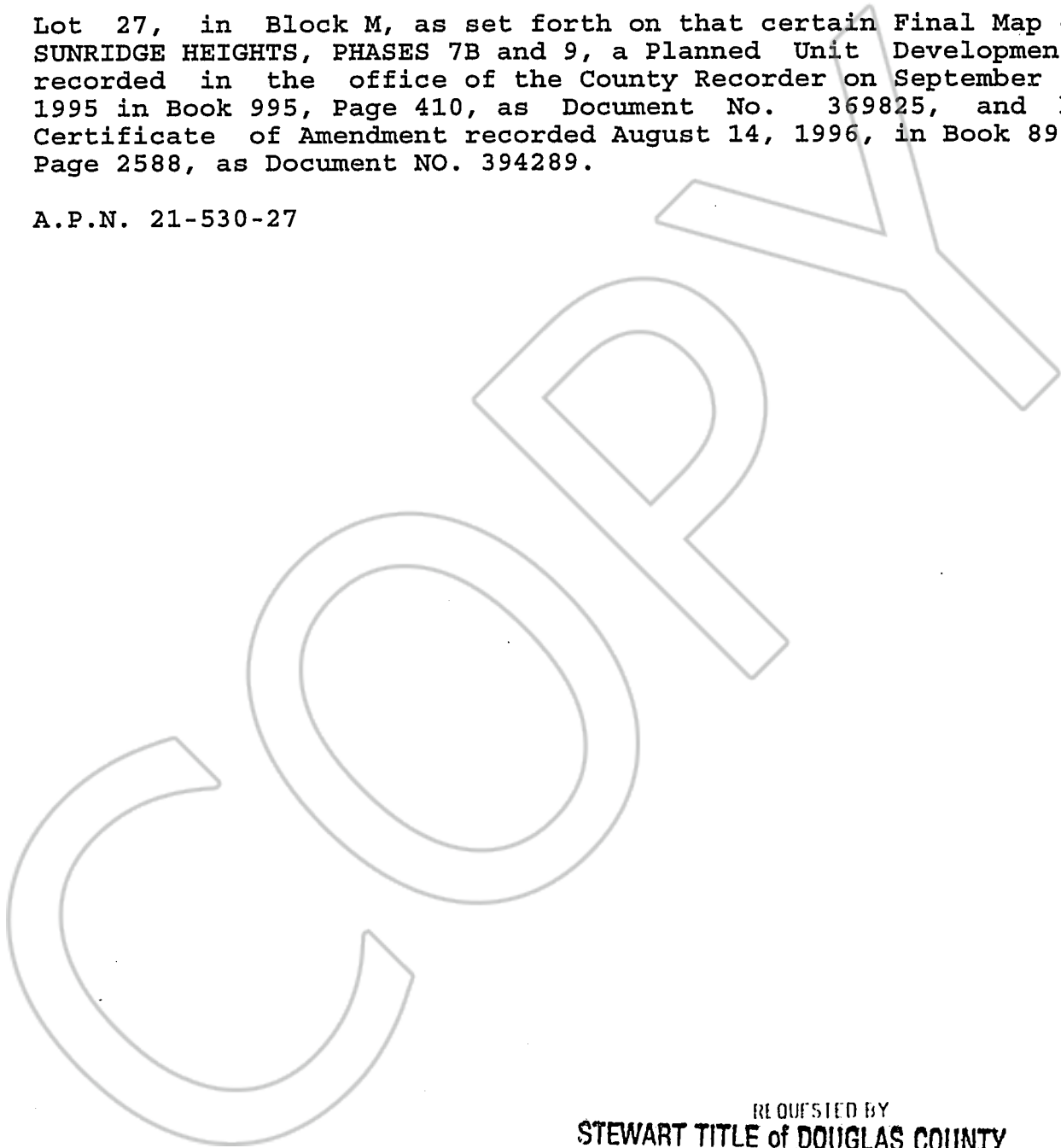

REQUESTED BY
STEWART TITLE of DOUGLAS COUNTY
IN OFFICIAL RECORDS OF
DOUGLAS CO., NEVADA

'99 MAR 23 P3:58

0464032
BK0399PG5428

LINDA SLATER
RECORDER
8⁰⁰ PAI *sh* DEPUTY

BK #399 PAGE 5429 NOT USED

COPY