

DESCRIPTION
20' Water Line Easement
UNR Board of Regents to K.G.I.D.

All that real property situate in the County of Douglas, State of Nevada, described as follows:

All that portion of the South 1/2 of Section 22, Township 13 North, Range 18 East, M.D.M., more particularly described as follows:

Beginning at a point which bears South 52 30'13" East 3,371.73 feet from the Northeast corner of the Northwest 1/4 of the Southwest 1/4 of said Section 22;

thence along the centerline of this easement description North 45 20'02" West 17.50 feet;

thence North 60 59'34" West 289.33 feet;

thence North 08 59'05" West 26.38 feet;

thence North 57 35'47" West 315.91 feet;

thence North 59 55'34" West 287.68 feet;

thence North 61 40'15" West 298.61 feet;

thence North 59 39'36" West 629.77 feet;

thence South 68 26'12" West 28.86 feet;

thence North 58 57'29" West 336.04 feet;

thence North 33 39'11" East 21.06 feet;

thence North 57 36'11" West 62.24 feet;

thence North 66 04'07" West 185.79 feet;

thence North 50 30'50" West 96.23 feet;

thence North 60 17'09" West 593.78 feet;

thence North 07 37'29" West 192.80 feet;

thence North 37 31'37" West 34.98 feet;

thence North 87 22'52" West 112.17 feet;

thence North 66 26'52" West 40.96 feet;

thence North 88 15'47" West 11.91 feet;

thence North 00 48'30" East 2.76 feet to the terminus of this easement description, said point bears South 48 22'00" West 321.53 feet from the Northeast corner of the Northwest 1/4 of the Southwest 1/4 of said Section 22.

Also, beginning at a point which bears South 50 43'09" East 2,525.63 feet from the Northeast corner of the Northwest 1/4 of the Southwest 1/4 of said Section 22;

thence North 28 16'26" East 161.50 feet;

thence North 37 05'17" East 213.56 feet to the Northeasterly terminus of this easement description.

The Basis of Bearing for this description is referenced to that Record of Survey filed as Document No. 65904.

Refer this description to your title company before incorporating into any legal document.

Turner & Associates, Inc.

Land Surveying

P.O. Box 5067

Stateline, NV 89449

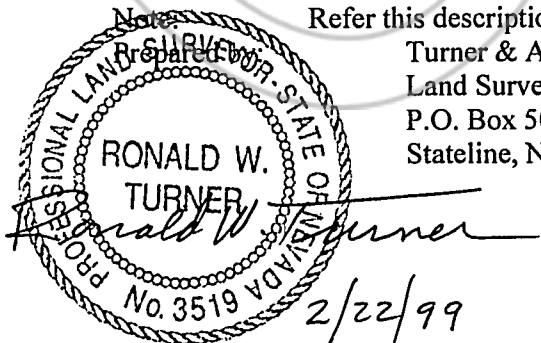

0464592

BK0399PG7208

COPY

REQUESTED BY
Kingsbury G-ID
IN OFFICIAL RECORDS OF
DOUGLAS CO., NEVADA

'99 MAR 31 A10:42

0464592

BK0399PG7209

LINDA SLATER
RECORDER

PAID ^{9.00} ₁₀ DEPUTY