

All that lot, piece or parcel of land situate in the County of Douglas, State of Nevada, described as follows:

PARCEL 1:

A Parcel of land being situated in the Southeast 1/4 of Section 24, Township 12 North, Range 20 East, M.D.B. & M., described as follows:

Parcel 4-A, as shown on Parcel Map for Michaels Construction filed for record August 14, 1990, in Book 890, Page 1972, Document No. 232280 of Official Records of Douglas County, State of Nevada.

PARCEL 2:

TOGETHER WITH an access easement for road and public utilities over and across the lands lying adjacent to Parcel No. 4, as set forth on that certain Parcel Map for GARY B. WILLIAMS, et ux, filed for record in the office of the County Recorder of Douglas County, Nevada on June 6, 1978 as Document No. 21529, more particularly described as follows:

BEGINNING at the Northeast corner of said Parcel Map, thence South 00°00'15" West, a distance of 25.00 feet; thence West, a distance of 942.29 feet to a point; thence Southwesterly along a curve having a radius of 25 feet through a central angle of 90, an arc distance of 39.27 feet to a point; thence North 00°02'15" East, a distance of 50.09 feet to a point, which is the Northwest corner of said Parcel Map; thence East, a distance of 967 feet, more or less to the POINT OF BEGINNING.

A.P.N. 29-512-13

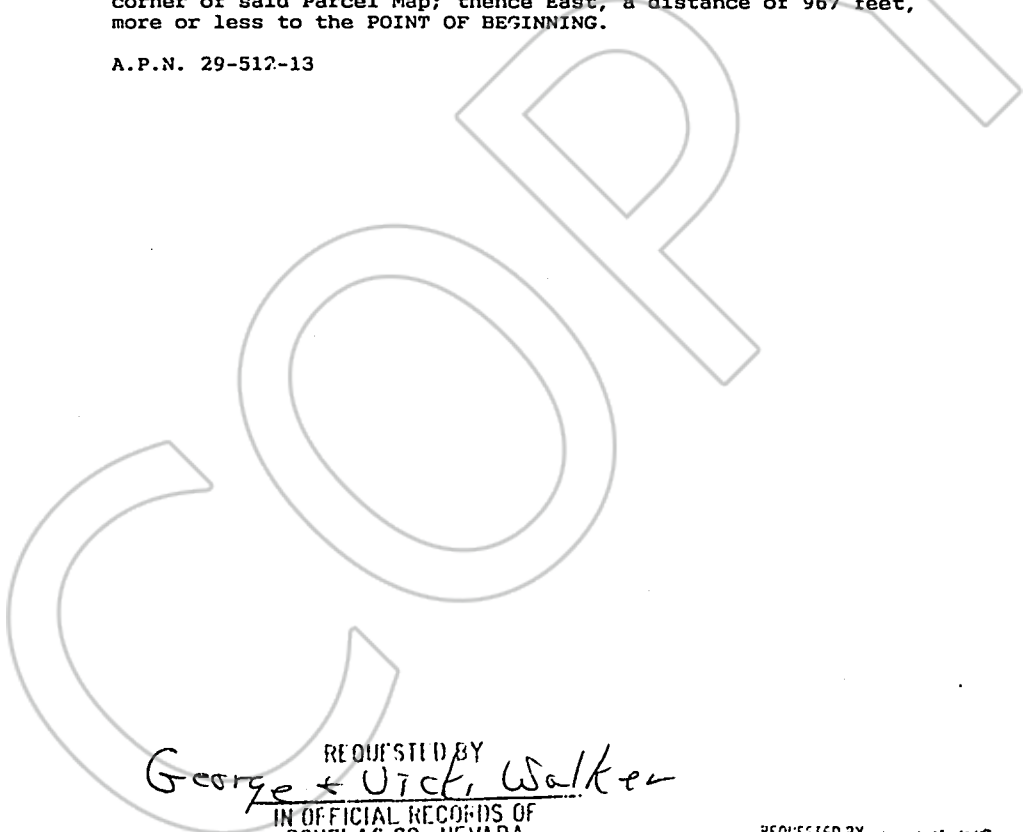

REQUESTED BY
George + Vicki Walker
IN OFFICIAL RECORDS OF
DOUGLAS CO., NEVADA

REQUESTED BY
WESTERN TITLE COMPANY, INC.
INDEXED & RECORDED

'99 APR -8 P3:18

92 JUN -5 P3:37

0465330

LINDA SLATER
RECORDER
PAID 62 DEPUTY

280395
BOOK 892 PAGE 1120

BK0499PG1693