

Escrow No:acom

**GRANT, BARGAIN AND SALE DEED**

**THIS INDENTURE WITNESSETH:** That for a valuable consideration, receipt of which is hereby acknowledged,

MICHAEL BRAY and JUDITH BRAY, husband and wife

doe(s) hereby **GRANT, BARGAIN, SELL, and CONVEY** to

MICHAEL BRAY and JUDITH BRAY, husband and wife as joint tenants

all that real property situated in the County of Douglas, State of Nevada, being a portion of Assessor's Parcel Nos. 21-180-29, 21-180-30, 21-180- 31, specifically described as follows:

See exhibit "A" attached hereto and by this reference made a part hereof

This document is being recorded to complete a Lot Line adjustment as set forth on Record of Survey recorded on April 12, 1999, in Book 499, Page 2137, as Document No. 465505, Official Records.

TOGETHER WITH all and singular the tenements, hereditaments, and appurtenances, including easement and water rights, if any, thereto belonging or in anywise appertaining, and any reversions, rents, issues, or profits thereof.

WITNESS my hand this 15<sup>th</sup> day of April, 1999

This document is recorded as an accommodation and without liability for the consideration therefore or as to the validity or sufficiency of said instrument or for the effect of such recording on the title of the property involved.

Michael Bray  
Michael Bray

Judith Bray  
Judith Bray

STATE OF NEVADA  
COUNTY OF Douglas

On 4/15/99, personally appeared before me, a notary public, Michael Bray and Judith Bray

Who acknowledged that they  
executed the above instrument.

E. Jane Mulcahy  
Notary Public

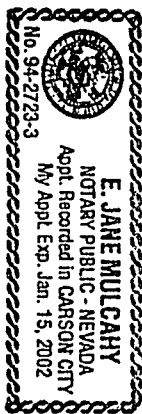

When recorded mail to:  
Grantee  
P.O. Box 2436  
Minden, NV 89423

The Grantors declare:  
Documentary Transfer Tax is \$-0-#5<sup>FR</sup>  
\_\_\_ computed on full vale  
\_\_\_ computed on full value less liens

0465855

BK0499PG3237

**LEGAL DESCRIPTION**  
**(New Parcel 2A)**

That portion of the Northwest 1/4 of the Northeast 1/4 of Section 34, Township 14 North, Range 20 East, M.D.B. & M. in the County of Douglas, State of Nevada, being more particularly described as follows:

The Westerly 236.77 feet of Parcel 2 of that Certain Parcel Map for Michael and Judith Bray, Recorded in Book 1098 at Page 1895 as Document No. 451403 in the Official Records of said Douglas County.

Said Parcel Contains 1.003 Acres, more or less.

Prepared By:

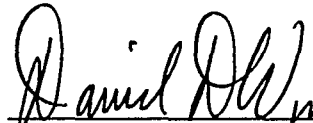
  
David D. Winchell, PLS



4/5/99

Date

0465855

BK0499PG3238

**LEGAL DESCRIPTION**  
**(New Parcel 3A)**

That portion of the Northwest 1/4 of the Northeast 1/4 of Section 34, Township 14 North, Range 20 East, M.D.B. & M. in the County of Douglas, State of Nevada, being more particularly described as follows:

Parcels 2, 3 & 4 of that Certain Parcel Map for Michael and Judith Bray, Recorded in Book 1098 at Page 1895 as Document No. 451403 in the Official Records of said Douglas County.

Excepting therefrom the Westerly 236.77 feet of Parcels 2 & 4 of said Parcel Map for Michael and Judith Bray.

Said Parcel Contains 9.078 Acres, more or less.

Prepared By:

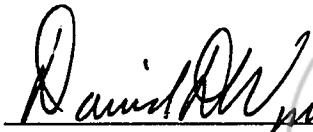

David D. Winchell, PLS



4/5/99

Date

0465855

BK0499PG3239

**LEGAL DESCRIPTION**  
**(New Parcel 4A)**

That portion of the Northwest 1/4 of the Northeast 1/4 of Section 34, Township 14 North, Range 20 East, M.D.B. & M. in the County of Douglas, State of Nevada, being more particularly described as follows:

The Westerly 236.77 feet of Parcel 4 of the Certain Parcel Map for Michael and Judith Bray, Recorded in Book 1098 at Page 1895 as Document No. 451403 in the Official Records of said Douglas County.

Said Parcel Contains 1.000 Acres, more or less.

Prepared By:

*David D. Winchell*

David D. Winchell, PLS 3240

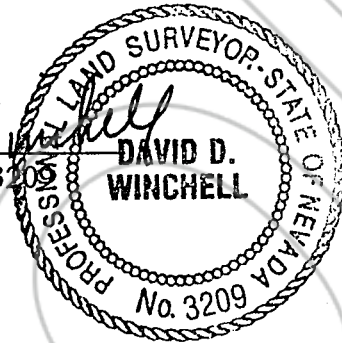

4/5/99

Date

REQUESTED BY  
**MARQUIS TITLE & ESCROW, INC.**  
IN OFFICIAL RECORDS OF  
DOUGLAS CO., NEVADA

'99 APR 16 A9:07

0465855

BK0499PG3240

LINDA SLATER  
RECORDER  
\$10.00 PAID *KO* DEPUTY