

GRANT, BARGAIN and SALE DEED

THIS INDENTURE WITNESSETH: That **STEVE CHAMBERS HUSBAND OF GRANTEE AND KENT HAYS, HUSBAND OF GRANTEE AND EDWARD TRAPP, HUSBAND OF GRANTEE**

in consideration of \$10.00, the receipt of which is hereby acknowledged, does hereby Grant, Bargain Sell and Convey to **LINDA MAY CHAMBERS, a married woman as her sole and separate property and ELIZABETH FRANCES HAYS, a married woman as her sole and separate property and MARSHA ANNE TRAPP, a married woman as her sole and separate property**

and to the heirs and assigns of such Grantee forever, all that real property situated in the **unincorporated area** County of **Douglas** State of Nevada, bounded and described as follows:
SEE EXHIBIT "A" ATTACHED HERETO AND MADE A PART HEREOF FOR LEGAL DESCRIPTION OF SUBJECT PROPERTY...

IT IS THE EXPRESS INTENT OF THE GRANTOR, BEING THE SPOUSE OF THE GRANTEE, TO CONVEY ALL RIGHT, TITLE AND INTEREST OF THE GRANTOR, COMMUNITY OR OTHERWISE, IN AND TO THE HEREIN DESCRIBED PROPERTY TO THE GRANTEE AS GRANTEE'S SOLE AND SEPARATE PROPERTY.

Together with all and singular the tenements, hereditaments and appurtenances thereunto belonging or in anywise appertaining, and any reversions, remainders, rents, issues or profits thereof.

DATE: April 26, 1999

This documnet is being executed in counter-part

Steve Chambers

Kent Hays
Kent Hays

Edward Trapp

STATE OF NEVADA }
 } ss.
COUNTY OF Douglas }



This instrument was acknowledged before me on 5-4-99,
by, Kent Hays

(This area above for official notarial seal)

Signature [Signature]
Notary Public

RECORDING REQUESTED BY:
STEWART TITLE COMPANY
WHEN RECORDED MAIL TO: Chamber/Hays/Trapp P.O. 2850 Gardnerville, NV 89410
MAIL TAX STATEMENTS TO: **| SAME**

0468108

BK0599PG3023

GRANT, BARGAIN and SALE DEED

THIS INDENTURE WITNESSETH: That **STEVE CHAMBERS HUSBAND OF GRANTEE AND KENT HAYS , HUSBAND OF GRANTEE AND EDWARD TRAPP, HUSBAND OF GRANTEE**

in consideration of \$10.00, the receipt of which is hereby acknowledged, does hereby Grant, Bargain Sell and Convey to **LINDA MAY CHAMBERS, a married woman as her sole and separate property and ELIZABETH FRANCES HAYS, a married woman as her sole and separate property and MARSHA ANNE TRAPP, a married woman as her sole and separate property**

and to the heirs and assigns of such Grantee forever, all that real property situated in the **unincorporated area** County of **Douglas** State of Nevada, bounded and described as follows:
SEE EXHIBIT "A" ATTACHED HERETO AND MADE A PART HEREOF FOR LEGAL DESCRIPTION OF SUBJECT PROPERTY...

IT IS THE EXPRESS INTENT OF THE GRANTOR, BEING THE SPOUSE OF THE GRANTEE, TO CONVEY ALL RIGHT, TITLE AND INTEREST OF THE GRANTOR, COMMUNITY OR OTHERWISE, IN AND TO THE HEREIN DESCRIBED PROPERTY TO THE GRANTEE AS GRANTEE'S SOLE AND SEPARATE PROPERTY.

Together with all and singular the tenements, hereditaments and appurtenances thereunto belonging or in anywise appertaining, and any reversions, remainders, rents, issues or profits thereof.

DATE: **April 26, 1999**

This document is being executed in counter-part

Steve Chambers

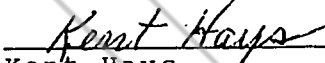
Kent Hays



Edward Trapp

STATE OF NEVADA }
 } ss.
COUNTY OF Douglas }



This instrument was acknowledged before me on 5-4-99,
by Kent Hays

(This area above for official notarial seal)

Signature 
Notary Public

RECORDING REQUESTED BY:
STEWART TITLE COMPANY
WHEN RECORDED MAIL TO: MAIL TAX STATEMENTS TO:
IAN ALLAN | **SAME**

0468108
BK0599PG3024

STATE OF ARIZONA)
) SS.
COUNTY OF Gila)

This instrument was acknowledged before me on May 7,
1999, by EDWARD TRAPP



Meme Heflin
Notary Public

STATE OF Nevada)
) SS.
COUNTY OF Douglas)



This instrument was acknowledged before me on May 10,
1999, by Steve Chambers



Lori Mae Silva
Notary Public

0468108
BK0599PG3025

LEGAL DESCRIPTION

The land referred to herein is situated in the State of Nevada, County of Douglas, described as follows:

Lot 58, in Block D, as shown on the Official Plat of WINHAVEN UNIT NO. 2, PHASE A, filed for record in the office of the County Recorder on September 14, 1990, in Book 990 of Official Records, at Page 1934, Douglas County, Nevada, as Document No. 234654.

Assessors Parcel No. 1320-29-213-004

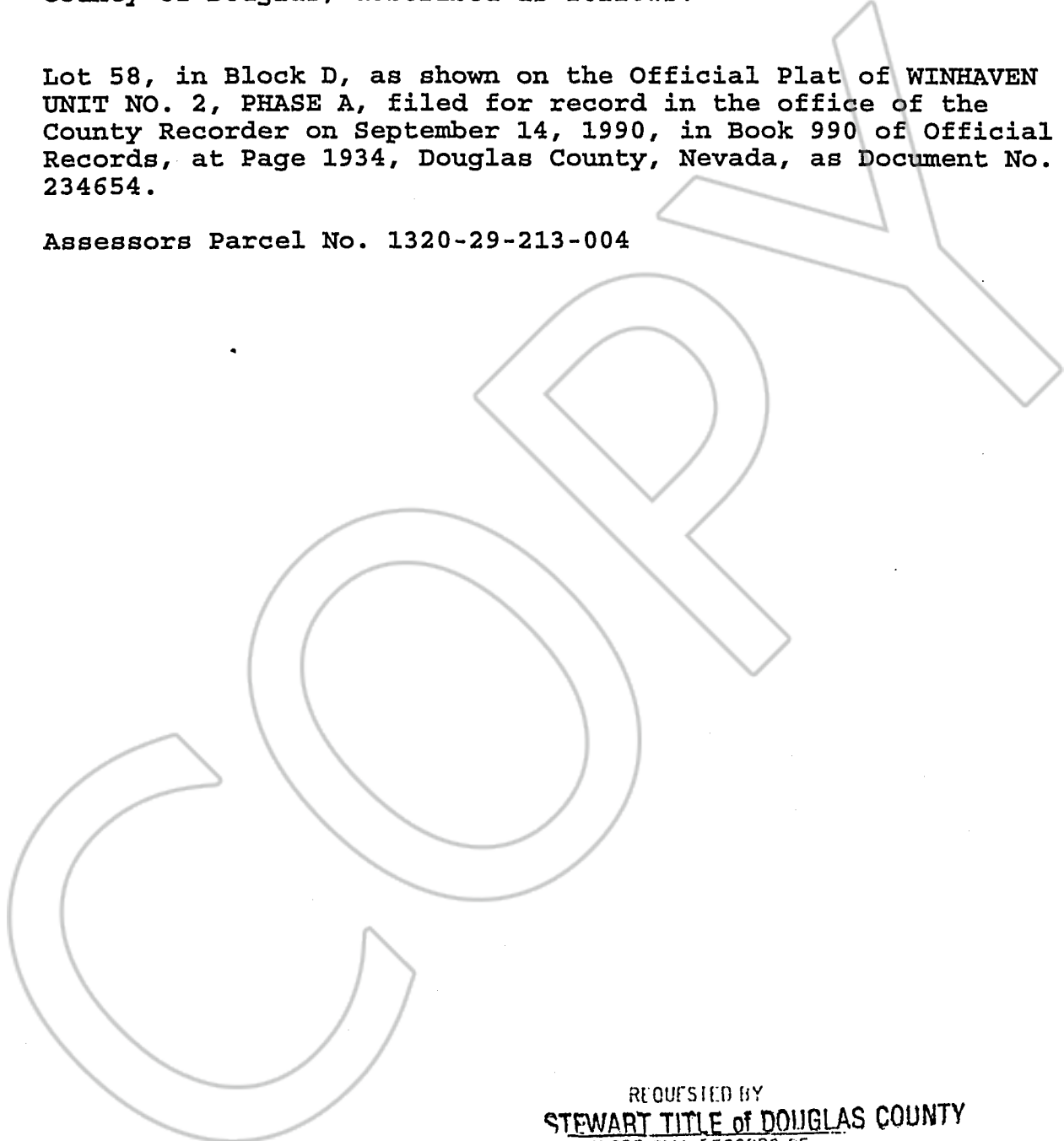

REQUESTED BY
STEWART TITLE OF DOUGLAS COUNTY
IN OFFICIAL RECORDS OF
DOUGLAS CO., NEVADA

'99 MAY 14 P4:31

SCHEDULE A
CLTA PRELIMINARY REPORT
(7/88)

0468108

BK0599PG3026

LINDA SLATER
RECORDER
\$10⁰⁰ PAID *Kg* DEPUTY

STEWART TITLE
Guaranty Company