

Assessors Parcel No. 1320-29-2 GRANT, BARGAIN and SALE DEED

THIS INDENTURE WITNESSETH: That LINDA MAY CHAMBERS, a married woman as her sole and separate property and ELIZABETH FRANCES HAYS, a married woman as her sole and separate property and MARSHA ANNE TRAPP, a married woman as her sole and separate property in consideration of \$10.00, the receipt of which is hereby acknowledged, does hereby Grant, Bargain Sell and Convey to IAN J. ALLAN, an unmarried man

and to the heirs and assigns of such Grantee forever, all that real property situated in the unincorporated area County of Douglas State of Nevada, bounded and described as follows:
Lot 58, in Block D, as shown on the Official Plat of WINHAVEN UNIT NO. 2, PHASE A, filed for record in the office of the County Recorder on September 14, 1990, in Book 990 of Official Records, at Page 1934, Douglas County, Nevada, as Document No. 234654.

Together with all and singular the tenements, hereditaments and appurtenances thereunto belonging or in anywise appertaining, and any reversions, remainders, rents, issues or profits thereof.

DATE: April 26, 1999

This Document is being executed in counter-part

LINDA MAY CHAMBERS
Elizabeth Frances Hays
ELIZABETH FRANCES HAYS
MARSHA ANNE TRAPP

STATE OF NEVADA }
COUNTY OF Douglas } ss.

This instrument was acknowledged before me on 5-4-99
by ELIZABETH
FRANCES HAYS



(This area above for official notarial seal)

Signature Lori Mae Silva
Notary Public

RECORDING REQUESTED BY:

STEWART TITLE COMPANY

WHEN RECORDED MAIL TO:
IAN ALLAN
1078 Wisteria Dr
Minden, NV 89423

MAIL TAX STATEMENTS TO:
Chase Manhattan
802 Delaware Ave.
Wilmington, Delaware 19886

0468109

BK0599PG3027

R.P.T.T. \$228.80
Full Value

ESCROW NO. 99080732

Assessors Parcel No. 1320-29-23044 **GRANT, BARGAIN and SALE DEED**

THIS INDENTURE WITNESSETH: That LINDA MAY CHAMBERS, a married woman as her sole and separate property and ELIZABETH FRANCES HAYS, a married woman as her sole and separate property and MARSHA ANNE TRAPP, a married woman as her sole and separate property in consideration of \$10.00, the receipt of which is hereby acknowledged, does hereby Grant, Bargain Sell and Convey to IAN J. ALLAN, an unmarried man

and to the heirs and assigns of such Grantee forever, all that real property situated in the unincorporated area County of Douglas State of Nevada, bounded and described as follows: Lot 58, in Block D, as shown on the Official Plat of WINHAVEN UNIT NO. 2, PHASE A, filed for record in the office of the County Recorder on September 14, 1990, in Book 990 of Official Records, at Page 1934, Douglas County, Nevada, as Document No. 234654.

Together with all and singular the tenements, hereditaments and appurtenances thereunto belonging or in anywise appertaining, and any reversions, remainders, rents, issues or profits thereof.

DATE: April 26, 1999

This Document is being executed in counter-part

Linda May Chambers
LINDA MAY CHAMBERS
Elizabeth Frances Hays
ELIZABETH FRANCES HAYS
Marsha Anne Trapp
MARSHA ANNE TRAPP

STATE OF NEVADA }
 } ss.
COUNTY OF Douglas }



This instrument was acknowledged before me on 5-4-99
by ELIZABETH
FRANCES HAYS

(This area above for official notarial seal)

Signature *Lori Mae Silva*
Notary Public

RECORDING REQUESTED BY:
STEWART TITLE COMPANY
WHEN RECORDED MAIL TO:
IAN ALLAN
1078 Wisteria Dr
Minden, NV 89423

MAIL TAX STATEMENTS TO:
| SAME
Chase Manhattan
802 Delaware Ave
Wilmington, Delaware 19886

0468109

BK0599PG3028

STATE OF ARIZONA)
) SS.
COUNTY OF Gila)

This instrument was acknowledged before me on May 7
1999, by MARSHA ANNE TRAPP



Meme Heflin
Notary Public

STATE OF Nevada)
) SS.
COUNTY OF Douglas)

This instrument was acknowledged before me on May 11
1999, by Linda May Chambers



Lori Mae Silva
Notary Public

0468109

BK0599PG3029

LEGAL DESCRIPTION

The land referred to herein is situated in the State of Nevada, County of Douglas, described as follows:

Lot 58, in Block D, as shown on the Official Plat of WINHAVEN UNIT NO. 2, PHASE A, filed for record in the office of the County Recorder on September 14, 1990, in Book 990 of Official Records, at Page 1934, Douglas County, Nevada, as Document No. 234654.

Assessors Parcel No. 1320-29-213-004

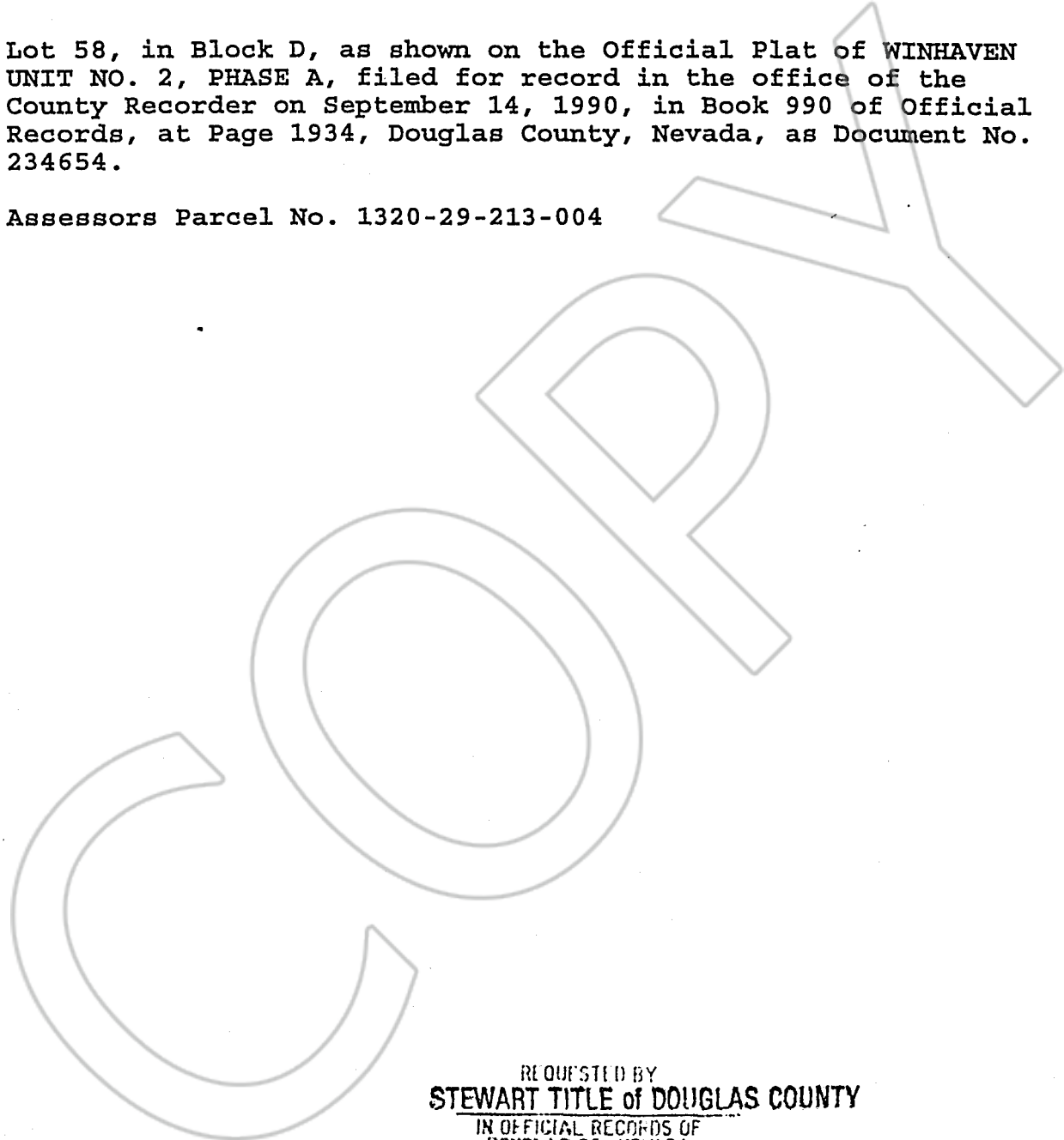

REQUESTED BY
STEWART TITLE OF DOUGLAS COUNTY
IN OFFICIAL RECORDS OF
DOUGLAS CO., NEVADA

'99 MAY 14 P4:32

LINDA SLATER
RECORDER
\$10.00 PAID *Ka* DEPUTY

STEWART TITLE
Guaranty Company

SCHEDULE A
CLTA PRELIMINARY REPORT
(7/88)

0468109

BK0599PG3030