

95022132 95022132

AFFIDAVIT TERMINATING JOINT TENANCY

HAROLD V. FULLER, being first duly sworn, deposes and says that Affiant is over the age of 18 years and competent to be a witness as to the matters hereinafter stated.

That Affiant is the surviving spouse of FRANCES D. FULLER, and that the Affiant and the said FRANCES D. FULLER, deceased, are the Grantees in Joint Tenancy

under that certain Joint Tenancy Deed dated February 5, 1980 under the terms of which WILLIAM F. MC CREARY AND MARILYN MC CREARY,

BURNEIT GREEN AND YUKIKO GREEN, husband and wife, AS JOINT TENANTS AND was seller to HAROLD V. FULLER AND FRANCES D. FULLER

husband and wife, as Joint Tenants, upon the terms, covenants and provisions as set forth therein, said document recorded February 6, 1980

in Book 280 page 383, as document no. 41291, of the Official Records of Douglas County, State of Nevada

affecting all that certain piece or parcel of land, situate in the County of Douglas, State of Nevada, described as follows:

SEE EXHIBIT "A" ATTACHED HERETO AND MADE A PART HEREOF BY REFERENCE

THIS DOCUMENT IS BEING RE-RECORDED TO CORRECT THE LEGAL DESCRIPTION ATTACHED AS EXHIBIT "A", SEE EXHIBIT "B" ATTACHED AND MADE A PART HEREOF\*\*\*\*\*

That the said FRANCES D. FULLER, one of the Grantees on the Joint Tenancy Deed, died on \_\_\_\_\_, in \_\_\_\_\_, and is the identical person named in the Certificate of Death, attached hereto. That all interest in and to said real property hereinabove described, vested absolutely in Affiant as of the date of decedent's death.

[Signature of Harold V. Fuller] HAROLD V. FULLER

State of Nevada )
County of Douglas ) SS

On February 6, 1996, before me, the undersigned, a Notary Public in and for said State, personally appeared HAROLD V. FULLER known ( or proved ) to me to be the person whose name is subscribed to the within instrument and acknowledged to me that he executed the same.

WITNESS my hand and official seal.
Signature [Signature]

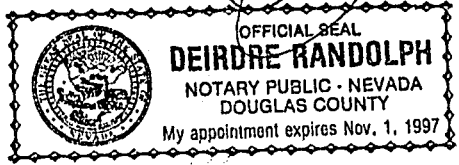

0470506
BK0699PG3694
382165
BK0296PG4525

CERTIFICATION OF VITAL RECORD

EL DORADO COUNTY  
PLACERVILLE, CALIFORNIA

CERTIFICATE OF DEATH

3-91-09-000504 37-641

STATE FILE NUMBER		STATE OF CALIFORNIA USE BLACK INK ONLY			LOCAL REGISTRATION DISTRICT AND CERTIFICATE NUMBER				
1. A. NAME OF DECEDENT—FIRST (GIVEN) <b>FRANCES</b>		1B. MIDDLE <b>DIANE</b>	1C. LAST (FAMILY) <b>FULLER</b>		2A. DATE OF DEATH—MO. DAY, YR. <b>SEPT. 5, 1991</b>	2B. HOUR <b>1703</b>	3. SEX <b>F</b>		
4. RACE <b>White</b>		5. HISPANIC—SPECIFY <input type="checkbox"/> YES <input checked="" type="checkbox"/> NO	6. DATE OF BIRTH—MO. DAY YR. <b>JULY 3, 1937</b>		7. AGE IN YEARS <b>54</b>	8. IF UNDER 1 YEAR MONTHS DAYS	9. IF UNDER 24 HOURS HOURS MINUTES		
DECEDENT PERSONAL DATA	8. STATE OF BIRTH <b>CA</b>	9. CITIZEN OF WHAT COUNTRY <b>U.S.A.</b>	10A. FULL NAME OF FATHER <b>Floyd P. Auten</b>		10B. STATE OF BIRTH <b>MO</b>	11A. FULL MAIDEN NAME OF MOTHER <b>Marion Rogue</b>		11B. STATE OF BIRTH <b>WA</b>	
12. MILITARY SERVICE <b>1D TO 1E NONE</b>		13. SOCIAL SECURITY NO. <b>2949</b>		14. MARITAL STATUS <b>Married</b>	15. NAME OF SURVIVING SPOUSE (IF WIFE, ENTER MAIDEN NAME) <b>Harold V. Fuller</b>				
16A. USUAL OCCUPATION <b>Homemaker</b>		16B. USUAL KIND OF BUSINESS OR INDUSTRY <b>Own Home</b>	16C. USUAL EMPLOYER <b>Self-Employed</b>	16D. YEARS IN OCCUPATION <b>35</b>	17. EDUCATION—YEARS COMPLETED <b>12</b>				
USUAL RESIDENCE	18A. RESIDENCE—STREET AND NUMBER OR LOCATION <b>1301 Highway 50</b>				18B. CITY <b>Glenbrook</b>	18C. ZIP CODE <b>89413</b>			
PLACE OF DEATH	18D. COUNTY <b>Douglas</b>	18E. NUMBER OF YEARS IN THIS COUNTY <b>12</b>	18F. STATE OR FOREIGN COUNTRY <b>Nevada</b>		20. NAME, RELATIONSHIP, MAILING ADDRESS AND ZIP CODE OF INFORMANT <b>Harold V. Fuller - Husband 1301 Highway 50 Glenbrook, NV 89413</b>				
CAUSE OF DEATH	19A. PLACE OF DEATH <b>Barton Memorial Hospital</b>		19B. HOSPITAL SPECIFY ONE: IP, ER/OP, OOA <b>IP</b>	19C. COUNTY <b>El Dorado</b>		21. TIME INTERVAL BETWEEN ONSET AND DEATH <b>0.00</b>		22. WAS DEATH REPORTED TO CORONER? REFERRAL NUMBER <input type="checkbox"/> YES <input checked="" type="checkbox"/> NO	
CORONER'S COPY ONLY	21. DEATH WAS CAUSED BY: (ENTER ONLY ONE CAUSE PER LINE FOR A, B, AND C) IMMEDIATE CAUSE (A) <b>cardiac arrest</b>		DUE TO (B) <b>septic shock</b>	DUE TO (C) <b>perforated cecum</b>	23. WASopsy PERFORMED? <input checked="" type="checkbox"/> YES <input type="checkbox"/> NO	24A. WAS AUTOPSY PERFORMED? <input type="checkbox"/> YES <input checked="" type="checkbox"/> NO		24B. WAS IT USED IN DETERMINING CAUSE OF DEATH? <input type="checkbox"/> YES <input checked="" type="checkbox"/> NO	
PHYSICIAN'S CERTIFICATION	25. OTHER SIGNIFICANT CONDITIONS CONTRIBUTING TO DEATH BUT NOT RELATED TO CAUSE GIVEN IN 21 <b>Diabetes Mellitus, Lt hemiparic stroke</b>				26. WAS OPERATION PERFORMED FOR ANY CONDITION IN ITEM 21 OR 25? IF YES, 1ST TYPE OF OPERATION AND DATE <b>near total colectomy ileostomy 9/3/1991</b>				
CORONER'S COPY ONLY	27A. DECEASED ATTENDED SINCE MONTH DAY YEAR <b>8/29/91</b>		27B. DECEASED LAST SEEN ALIVE MONTH DAY YEAR <b>9/5/91</b>		27C. SIGNATURE AND ADDRESS OF PHYSICIAN <b>Gregory E. Ginn, MD, P.O. Box 61221, So. Lake Tahoe, CA, 96152</b>		27D. DATE SIGNED <b>9/6/91</b>		
CORONER'S COPY ONLY	28A. SIGNATURE AND TITLE OF CORONER OR DEPUTY CORONER		28B. DATE SIGNED		29. MANNER OF DEATH—WHY OR HOW AND DATE (DO NOT CHECK MORE THAN ONE) <input type="checkbox"/> SUICIDE <input type="checkbox"/> HOMICIDE <input type="checkbox"/> OTHER	30A. PLACE OF INJURY	30B. JOB INJURY AT WORK <input type="checkbox"/> YES <input checked="" type="checkbox"/> NO	30C. DATE OF INJURY MONTH DAY YEAR	31. HOUR
FUNERAL DIRECTOR AND LOCAL REGISTRAR	32. LOCATION (STREET AND NUMBER OR LOCATION AND CITY)		33. DESCRIBE (BRIEFLY) THE INCIDENT (EVENTS WHICH RESULTED IN INJURY)		34A. DISPOSITIONS <b>CR/TR/RES</b>	34B. PLACE OF FINAL DISPOSITION, NAME AND ADDRESS <b>Harold V. Fuller, 1301 Highway 50 Glenbrook, NV</b>	34C. DATE MO DAY YEAR <b>9-7-91</b>	34D. SIGNATURE OF EMBALMER <b>Not Embalmed</b>	34E. LICENSE NUMBER <b>None</b>
FUNERAL DIRECTOR AND LOCAL REGISTRAR	35A. NAME OF FUNERAL DIRECTOR OR PERSON ACTING AS SUCH		35B. LICENSE NO. <b>FD-1180</b>	35C. SIGNATURE OF LOCAL REGISTRAR <b>William E. Schatzky</b>		35D. REGISTRATION DATE <b>709900</b>	35E. REGISTRATION DATE <b>9-6-91, M Mc.</b>		

12086

CERTIFIED COPY OF VITAL RECORDS

STATE OF CALIFORNIA }  
COUNTY OF EL DORADO } SS

DATE ISSUED

FEB 14 1996

This is a true and exact reproduction of the document officially registered and placed on file in the office of the EL DORADO COUNTY RECORDER-CLERK.

EL DORADO COUNTY RECORDER-CLERK

0470506

382165

This copy not valid unless prepared on engraved bond displaying seal and signature of County Recorder-Clerk.

BK0699PG3695 BK0296PG4326



ANY ALTERATION OR ERASURE VOID THIS CERTIFICATE

LEGAL DESCRIPTION

The land referred to herein is situated in the State of Nevada, County of Douglas,, described as follows:

Lot 2, in Block F, as shown on the Amended Map of Zephyr Cove Properties, Inc, in Sections 9 and 10, Township 13 North, Range 18 East, M.D.B.&M., filed in the office of the County Recorder of Douglas County, Nevada on August 5, 1929.

Assessors Parcel No. 05-090-02

Excepting therefrom all that portion thereof, lying below the natural ordinary high water line of Lake Tahoe.

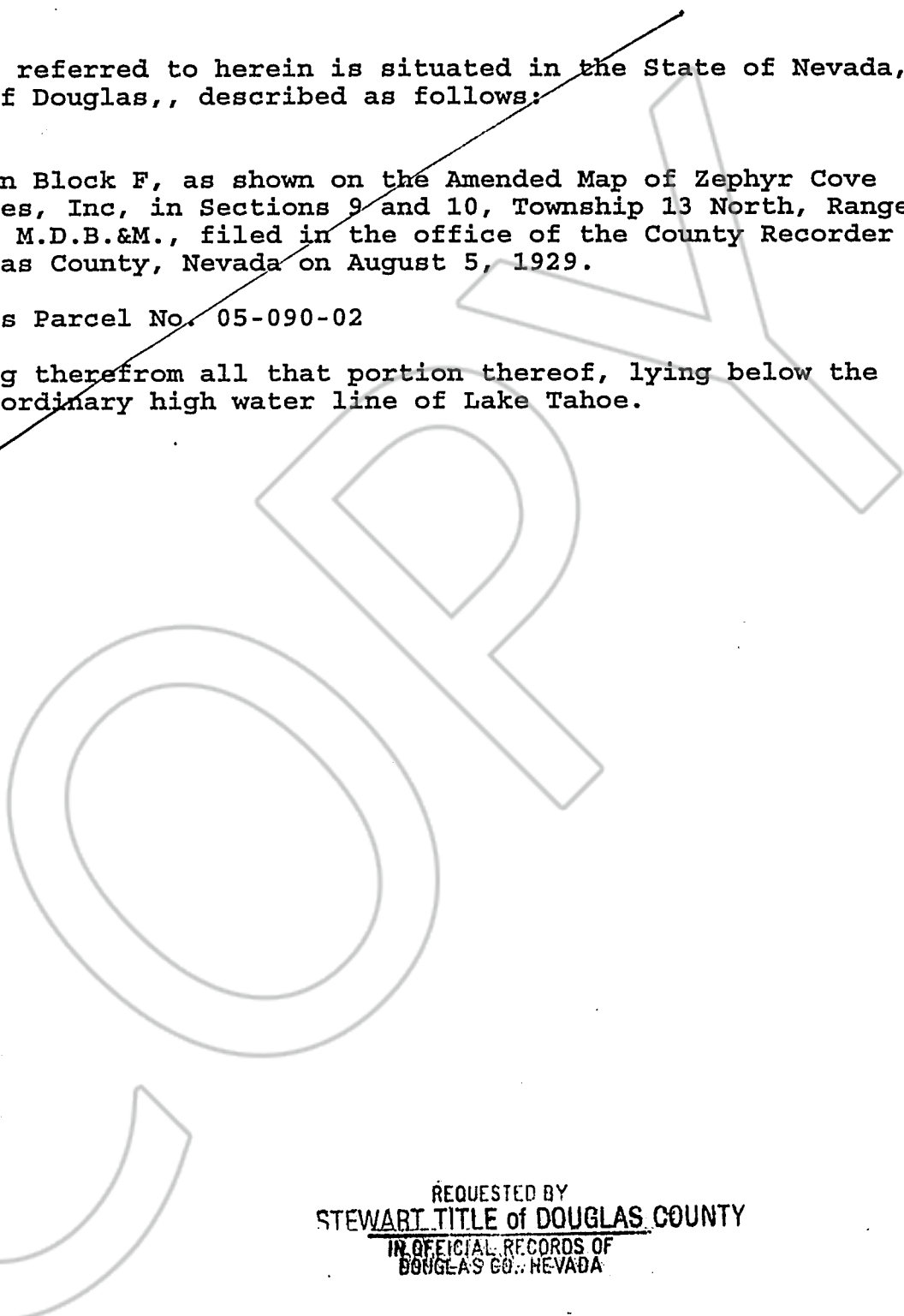

BK0699PG3696  
0470506

REQUESTED BY  
STEWART TITLE of DOUGLAS COUNTY  
IN OFFICIAL RECORDS OF  
DOUGLAS CO., NEVADA

'96 FEB 28 10:10

382165

LINDA SLATER  
RECORDER  
PAID K2 DEPUTY

SCHEDULE A  
CLTA PRELIMINARY REPORT  
(7/88)

BK0296PG45279

STEWART TITLE  
Guaranty Company

EXHIBIT "B"

LEGAL DESCRIPTION

The land referred to herein is situated in the State of Nevada, County of Douglas,, described as follows:

A parcel of land situate between the East right of way line of the State Highway, and the East boundary line of Section 34, Township 14 North, Range 18 East, M.D.B.&M., described as follows:

Beginning at the 1/4 corner common to Sections 27 and 34, Township 14 North, Range 18 East, M.D.B.&M.; thence South 0 degree 30'54" West, a distance of 360.00 feet to a point; thence North 89 degree 44'15" West, a distance of 908.20 feet to a point; thence North 26 degrees 56'00" East, a distance of 134.29 feet, thence continuing North to the Southwest corner of Cave Rock Village Subdivision, thence East along the South boundary line of said Cave Rock Village Subdivision, a distance of 839.84 feet more or less to the Southeast corner of said Subdivision; thence North along the East boundary line of said Subdivision a distance of 234.66 feet to the Northeast corner of said subdivision; thence East a distance of 4.71 feet more or less to the 1/4 corner common to said Section 27 and 34, to the Point of Beginning.

Assessors Parcel No. 03-150-01

REQUESTED BY  
STEWART TITLE of DOUGLAS COUNTY  
IN OFFICIAL RECORDS OF  
DOUGLAS CO., NEVADA

'99 JUN 17 P3:03

SCHEDULE A  
CLTA PRELIMINARY REPORT  
(7/88)

0470506  
BK0699PG3697

LINDA SLATER  
RECORDER  
PAID *KJ* DEPUTY

STEWART TITLE  
Guaranty Company