

Declaration of Homestead

(CHECK ONE)

(TYPE OR PRINT CLEARLY WITH BLACK PEN)

- MARRIED (filing joint declaration)
- MARRIED (as sole and separate property)
- By Husband (filing for joint benefit of both)
- By Wife (filing for joint benefit of both)
- By Trustee of Trust (Personal Living Trust)

- Single, Widow or Unmarried Person
- Multiple Single Persons
- Single Head of Family
- Other: (Describe) _____

(CHECK ONE) HOUSE MOBILE HOME CONDOMINIUM UNIT TOWNHOUSE

Name on title of property: TORBEN HANSEN + Martha HANSEN

Do individually and severally certify and declare that the following named persons is/are residing on the land premises (or mobile home, condominium unit, townhouse) as follows: _____

located at (street address) 766 Sunnyside Ct.

City of GARDNERVILLE, County of DOUGLAS, State of Nevada, and more particularly described as follows: _____

SEE EXHIBIT A ATTACHED HERETO

SUBDIVISION: _____

LOT: 30

BLOCK: _____

PLAT BOOK: 494

PAGE NO.: 2192

ASSESSORS PARCEL NO. 27-861-22 NEW 1220-21-110-047

I/We claim the land and premises hereinabove described, together with the dwelling house thereon, and its appurtenances, or the described mobile home, condominium unit, or townhouse as a Homestead.

The Undersigned person(s) do hereby certify and declare that there is no current Declaration of Homestead on file.

In Witness Whereof, I/We have hereunto set my hand/our hands on _____

Torben Hansen
Signature of Declarant

Martha Hansen
Signature of Declarant

TORBEN HANSEN
(Print or type name here)

MARTHA HANSEN
(Print or type name here)

STATE OF NEVADA)

) ss.

COUNTY OF DOUGLAS

) This instrument was acknowledged before me on JUNE 29, 1999

By TORBEN HANSEN AND MARTHA HANSEN

Kathy Swain
(Signature of Notary Public)



My commission expires: 8/13/00

(Notary Stamp)

RECORDING REQUESTED BY AND MAIL TO

NAME: TORBEN HANSEN + Martha HANSEN

ADDRESS: 766 Sunnyside Court

CITY, STATE, ZIP: GARDNERVILLE NV 89410

THIS SPACE FOR RECORDERS OFFICE ONLY

0471269
BK0699PG5856

EXHIBIT A

The land referred to in this policy is situated in the State of Nevada, County of DOUGLAS and is described as follows:

All that certain lot, piece, or parcel of land situate in the County of Douglas, State of Nevada, described as follows:

Lot 30 as set forth on the Final Map of TILLMAN ESTATES, filed for record in the Office of the County Recorder of Douglas County, State of Nevada, on April 12, 1994, in Book 494, at Page 2192, as Document No. 334956.

APN: 27-861-22 NEW 1220-21-110-047

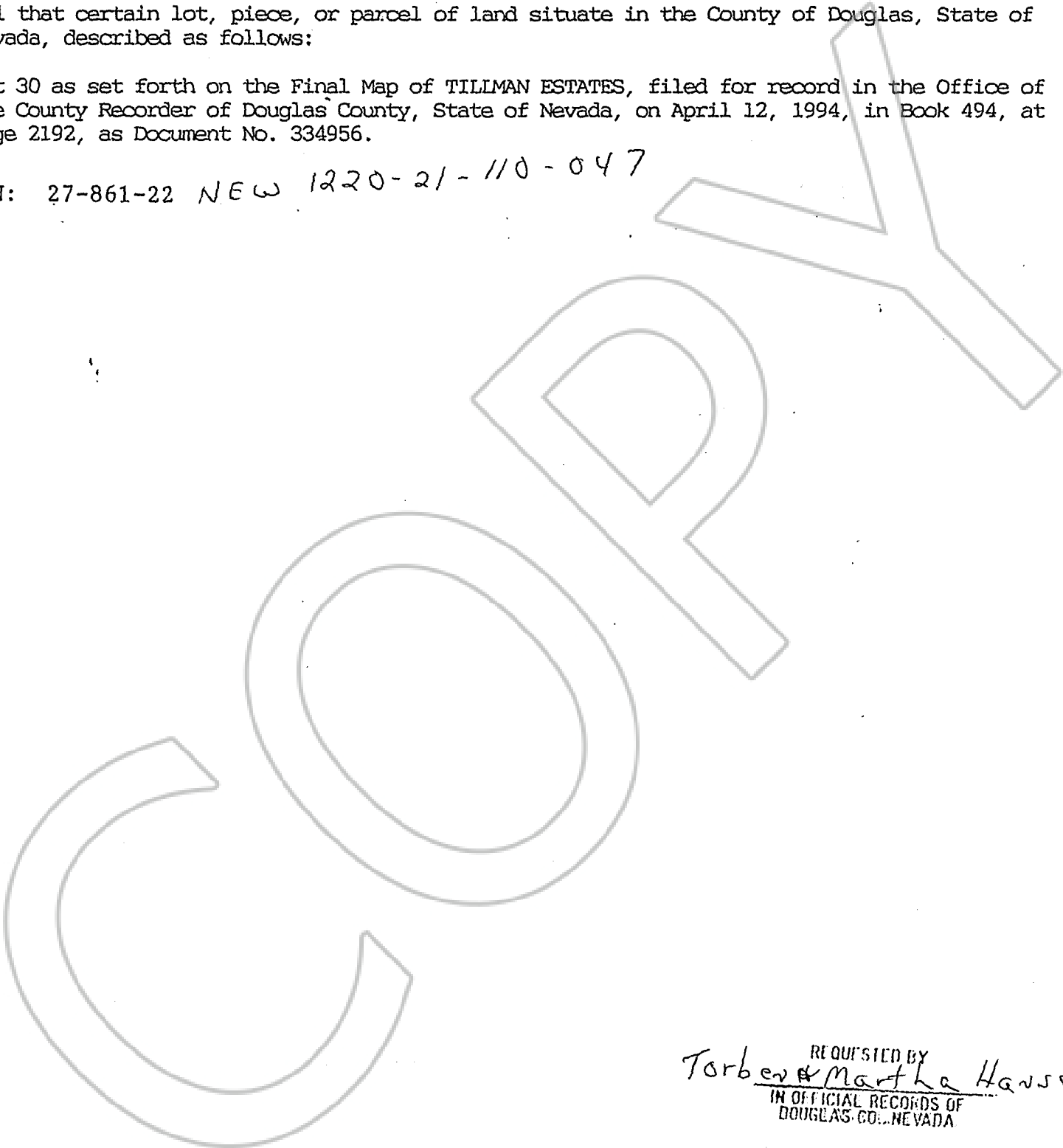

REQUESTED BY
Torben & Martha Hansen
IN OFFICIAL RECORDS OF
DOUGLAS CO., NEVADA

'99 JUN 29 AIO:14

0471269

BK0699PG5857

LINDA SLATER
RECORDER
PAID *ko* DEPUTY