

R.P.T.T. \$214.50
Full Value

ESCROW NO. 99080781

GRANT, BARGAIN and SALE DEED

THIS INDENTURE WITNESSETH: That JEANNE B. DOSSEY TRUSTEE OF THE JEANNE B. DOSSEY LIVING TRUST DATED NOVEMBER 7, 1990

in consideration of \$10.00, the receipt of which is hereby acknowledged, does hereby Grant, Bargain Sell and Convey to JING YUAN AND JIPING SHIH, WIFE AND HUSBAND AS JOINT TENANTS TENANTS

and to the heirs and assigns of such Grantee forever, all that real property situated in the unincorporated area County of DOUGLAS State of Nevada, bounded and described as follows:
SEE EXHIBIT "A" ATTACHED HERETO AND MADE A PART HEREOF

Together with all and singular the tenements, hereditaments and appurtenances thereunto belonging or in anywise appertaining, and any reversions, remainders, rents, issues or profits thereof.

DATE: June 14, 1999

Jeanne B. Dossey
JEANNE B. DOSSEY, TRUSTEE



STATE OF Nevada }
COUNTY OF Douglas } ss.

This instrument was acknowledged before me on 6-30-99,
by JEANNE B. DOSSEY, TRUSTEE

(This area above for official notarial seal)

Signature Mary H. Kelsh
Notary Public

RECORDING REQUESTED BY:

STEWART TITLE COMPANY

WHEN RECORDED MAIL TO:

MAIL TAX STATEMENTS TO:

JING YUAM
836 MAHOGANY

SAME

Minden, NV 89423

0472009

BK0799PG1059

LEGAL DESCRIPTION

The land referred to herein is situated in the State of Nevada, County of Douglas, described as follows:

Lot 20, Block E, as shown on the Official Map of WESTWOOD VILLAGE UNIT NO. 1, filed for record in the Office of the County Recorder on October 5, 1979, in Book 1079, Page 440, Document No. 37417, and A Certificate of Amendment recorded July 14, 1980, in Book 780, Page 783 and further A Certificate of Amendment recorded January 31, 1991, in Book 191, Page 3820, Document No. 243938, Official Records of Douglas County, Nevada.

Assessor's Parcel No. 1320-30-211-019

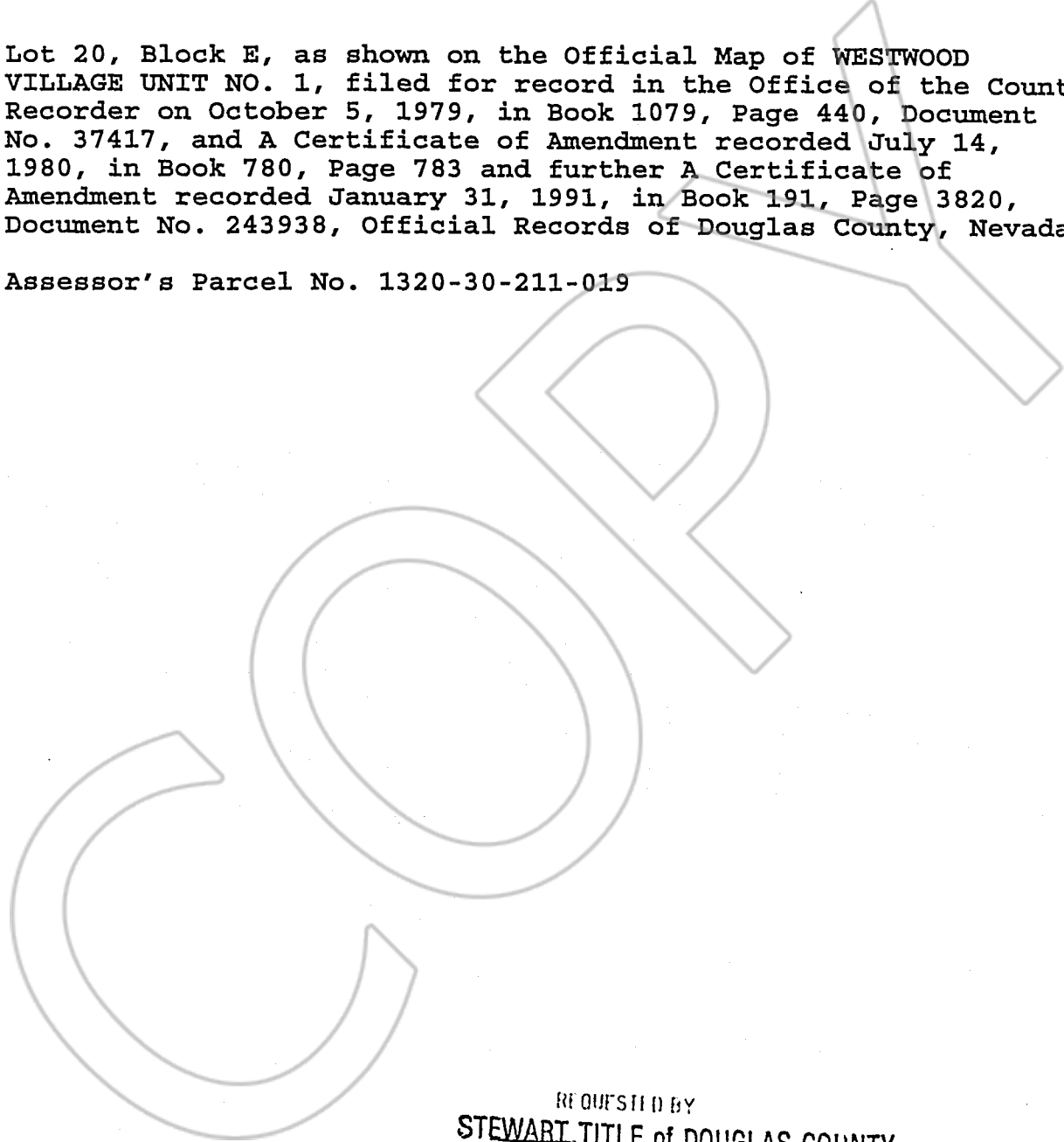

REQUESTED BY
STEWART TITLE of DOUGLAS COUNTY
IN OFFICIAL RECORDS OF
DOUGLAS CO., NEVADA

'99 JUL -7 P3:05

LINDA SLATER
RECORDER
\$8.00 PAID \$10.00 DEPUTY

STEWART TITLE
Guaranty Company