

EXHIBIT A

All that Real Property situate in the County of Douglas, State of Nevada, described as follows:

Lot 27, Genoa Lakes Phase 1, filed in Book 393, at page 3260 Official Maps of Douglas County, Document No. 302137, more particularly described as follows:

Together with All that portion of Lot 28 of said subdivision described as follows:

Beginning at the most Northerly corner of said lot 28; thence South 41°09'39" East 148.66 feet to a point on the Westerly Right-of-Way line of Genoa Aspen Court; thence along said Right-of-Way line along a curve concave to the East having a central angel of 13°24'22", and a Radius of 45.00', said curve having a Chord Bearing of North 37°57'38" East; thence leaving said Right-of-Way line North 45°13'56" West 147.02 feet to the point of beginning. Containing 774 square feet more or less.

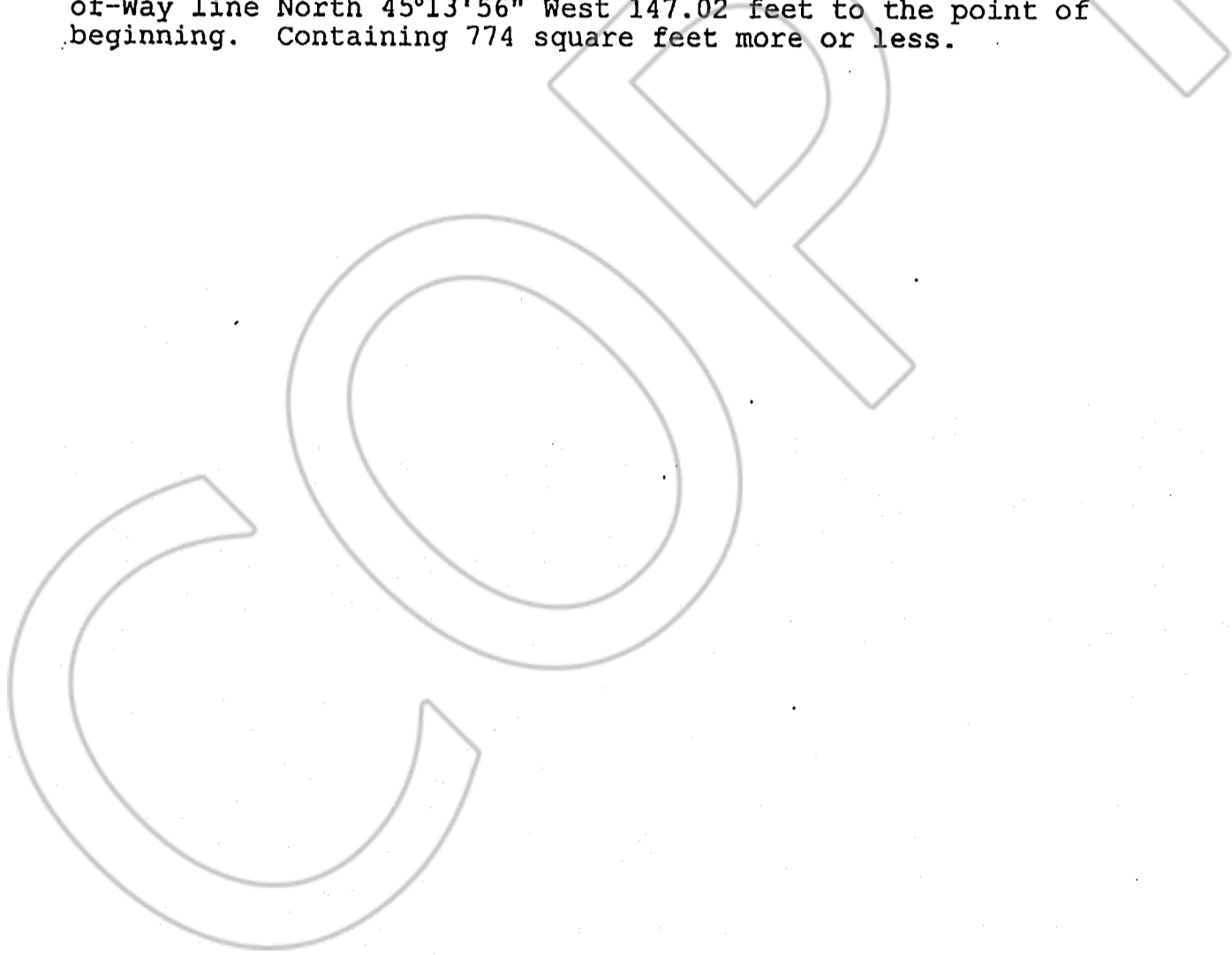

REQUESTED BY
WESTERN TITLE COMPANY, INC.
IN OFFICIAL RECORDS OF
DOUGLAS CO., NEVADA

'99 JUL 20 P12:11

0472831

BK0799PG3371

LINDA SLATER
RECORDER

\$ 8.00 PAID AS DEPUTY