

APN

WHEN RECORDED MAIL TO

Name

CAROL A. STAMENSON

Street Address

P.O. Box 24
Glenbrook, NV 89413

City
State
Zip

APN 01-180-060

SPACE ABOVE THIS LINE FOR RECORDER'S USE

Grant Deed

The undersigned grantor(s) declare(s):
Documentary transfer tax is \$ 0 # 8

- () computed on full value of property conveyed, or
- () computed on full value less value of liens and encumbrances remaining at time of sale.
- () Unincorporated area: () City of
- () Realty not sold.

FOR A VALUABLE CONSIDERATION, receipt of which is hereby acknowledged,
CAROL A. STAMENSON, an unmarried woman

hereby GRANT(S) to

The Carol A. Stamenson Trust Dated May 22, 1999,
CAROL A. STAMENSON, Settlor and Trustee

that property in

Douglas County, State of Nevada and more particularly
described in attached Exhibit "A"

Mail Tax Statements to CAROL A. STAMENSON, P.O. Box 24, Glenbrook, Nevada 89413

Date 7/22/99

Carol A. Stamenson
CAROL A. STAMENSON

NEVADA
STATE OF CALIFORNIA
COUNTY OF Douglas

On July 22, 1999 before me, the
undersigned, a Notary Public in and for said State, personally appeared

Carol A. Stamenson

~~personally known to me~~ (or proved to me on the basis of satisfactory
evidence) to be the person(s) whose name(s) ~~is~~ are subscribed to the within
instrument and acknowledged to me that he/~~she~~ they executed the same in
his/~~her~~ their authorized capacity(ies), and that by his/~~her~~ their signature(s) on
the instrument the person(s), or the entity upon behalf of which the person(s)
acted, executed the instrument.

WITNESS my hand and official seal.

Signature Linda L. Slater

Name Linda L. Slater
(typed or printed)



DESCRIPTION

All that certain lot, piece or parcel of land situate in the County of Douglas, State of Nevada, described as follows:

PARCEL 1:

Lot 84, in Block E, as shown on the second AMENDED MAP OF GLENBROOK SUBDIVISION UNIT 2, filed for record in the Office of the County Recorder of Douglas County, Nevada, on January 30, 1980, in Book 180, Page 1512, as Document No. 41035, Official Records of Douglas County, Nevada.

PARCEL 2:

The exclusive right to use for garage purposes that parcel designated as "Garage Easement" that is appurtenant to Lot 84, in Block E, as shown on the map referenced in Parcel One above.

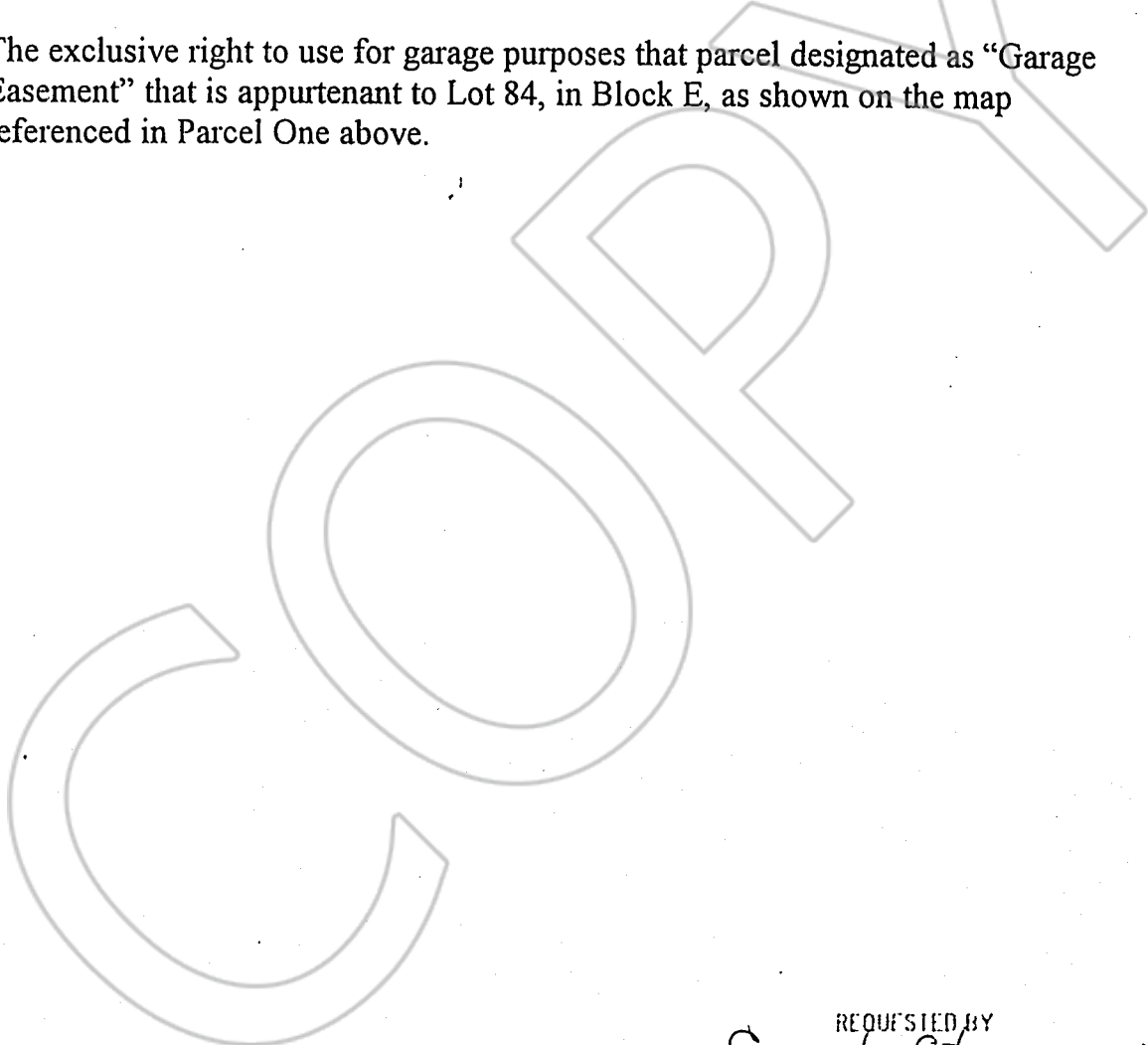

REQUESTED BY
Carol Stameason
IN OFFICIAL RECORDS OF
DOUGLAS CO., NEVADA

'99 JUL 22 P3:07

0472974

BK0799PG3773

LINDA SLATER
RECORDER
\$800 PAID *la* DEPUTY