

A.P.N. 23-040-18  
MALDREP, JEANETTE M.,  
TRUSTEE

A.P.N. 23-550-03  
RAJAN II, LLC

A.P.N. 23-551-08  
NILREMOT INC.

**BASIS OF BEARING**

N 89°46'14" E - SOUTHERLY RIGHT-OF-WAY AIRPORT ROAD PER LAND DIVISION MAP FOR F.A. AND M.M. THAHELD, DOC. NO. 101922.

**LEGEND**

- ▲ SET 5/8" REBAR WITH PLASTIC CAP PLS 11172
- △ FOUND 3/4" IP WITH PLUG, PLS 3519, PER DOC. NO. 426476
- FOUND 5/8" REBAR WITH PLASTIC CAP, RLS 1586, PER DOC. NO. 204160
- FOUND CENTERLINE MONUMENT IN WELL

**NOTES**

AREA: 3.18 ACRES  
 THIS IS A RESUBDIVISION OF ADJUSTED TRACT 1, IN BLOCK A, AS SHOWN ON THAT CERTAIN RECORD OF SURVEY FOR A BOUNDARY LINE ADJUSTMENT RECORDED IN BK. 899 AT PG 4277 AS DOCUMENT NO.475103.  
 THIS MAP IS NOT IN CONFLICT WITH THE REQUIREMENTS OF N.R.S. 278.010 TO 278.630, INCLUSIVE.  
 THIS RECORD OF SURVEY IS BEING RECORDED TO DEFINE THE LIMITS OF THE SPECIAL PARCELS SHOWN HEREON IN ACCORDANCE WITH THE PROVISIONS OF NRS 278.325  
 PARCEL A IS SUBJECT TO RECIPROCAL EASEMENT RECORDED IN BOOK 292, AT PAGE 4554

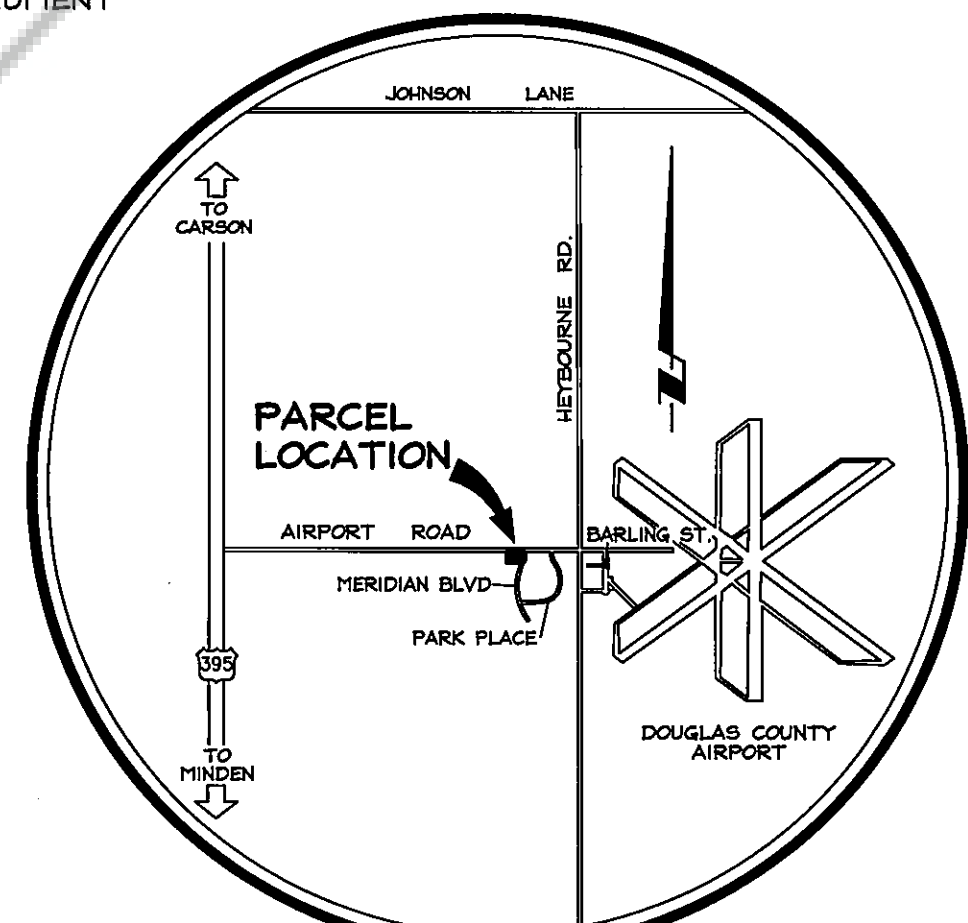

**VICINITY MAP**  
NO SCALE

**OWNER'S CERTIFICATE**

I, A.R. SHANKLE, MANAGER/MEMBER RAJAN, LLC CERTIFY THAT I AM THE LEGAL OWNER OF THIS PARCEL AND DO HEREBY CONSENT TO THE PREPARATION AND RECORDING OF THIS MAP.

*A.R. Shankle*  
A.R. SHANKLE, MANAGER/MEMBER  
RAJAN LLC

COUNTY OF DOUGLAS  
STATE OF NEVADA

SS:  
ON THIS 23<sup>rd</sup> DAY OF August, IN THE YEAR 1999, BEFORE ME, A NOTARY PUBLIC, PERSONALLY APPEARED A.R. Shankle PERSONALLY KNOWN BY ME TO BE THE PERSON WHOSE NAME IS SUBSCRIBED TO THE ABOVE INSTRUMENT WHO ACKNOWLEDGED THAT HE EXECUTED THE SAME IN HIS AUTHORIZED CAPACITIES AND THAT BY HIS SIGNATURE ON THE INSTRUMENT, THE PERSONS, OR THE ENTITY ON BEHALF OF WHICH THE PERSONS ACTED, EXECUTED THE INSTRUMENT.

WITNESS MY HAND AND OFFICIAL SEAL  
NOTARY'S SIGNATURE *Jolite McDuffee*  
MY COMMISSION EXPIRES: March 10, 2001

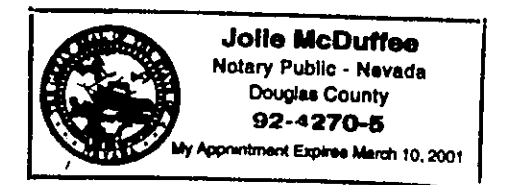

**SURVEYOR'S CERTIFICATE**

I, MATT BERNARD, A PROFESSIONAL LAND SURVEYOR LICENSED IN THE STATE OF NEVADA CERTIFY THAT:

- 1) THIS PLAT REPRESENTS THE RESULTS OF A SURVEY CONDUCTED UNDER MY DIRECT SUPERVISION AT THE INSTANCE OF A.R. SHANKLE.
- 2) THE LANDS SURVEYED LIE WITHIN A PORTION OF SECTION 8, T.13N., R.20E., M.D.M. AND THE SURVEY WAS COMPLETED ON 8-23-99.
- 3) THIS PLAT COMPLIES WITH THE APPLICABLE STATE STATUTES AND ANY LOCAL ORDINANCE IN EFFECT ON THE DATE THAT THE GOVERNING BODY GAVE ITS FINAL APPROVAL.
- 4) THE MONUMENTS DEPICTED ON THE PLAT ARE OF THE CHARACTER SHOWN, OCCUPY THE POSITIONS INDICATED AND ARE OF SUFFICIENT NUMBER AND DURABILITY.

*Matt Bernard*  
MATT BERNARD, P.L.S. 11172  
DATE 8-23-99



**RECORDER'S CERTIFICATE**

FILED FOR RECORD THIS 24<sup>th</sup> DAY OF August, 1999, AT 46 MINUTES PAST 3 O'CLOCK P.M., IN BOOK 399 OF OFFICIAL RECORDS, AT PAGE 4562, DOCUMENT NO. 475180.  
RECORDED AT THE REQUEST OF A.R. SHANKLE.

*Barbara Clark*, Deputy Recorder  
DOUGLAS COUNTY RECORDER

SCALE: 1" = 40' SHEET 1 OF 1

**RECORD OF SURVEY**  
FOR  
**MERIDIAN BUSINESS PARK**  
**RAJAN R&D PARK**

LOCATED WITHIN A PORTION OF SECTION 8  
T.13N., R.20E., M.D.M.  
DOUGLAS COUNTY, NEVADA

177-31-98  
17731ROS.dwg  
06/29/99



Z:\PROJ\ECTS\17731\dwg\17731ROS.dwg Mon Aug 23 14:57:20 1999