

Legal Description
for
Exhibit "A"

All that certain lot, piece or parcel of land situate in the County of Douglas, State of Nevada, described as follows:

That portion of the southwest $\frac{1}{4}$ of the southwest $\frac{1}{4}$ of Section 23, T.13N., R.18E., M.D.B. & M., more particularly described as follows:

Commencing at the southeast corner of that certain parcel of land described in deed from Glen E. Myers to Tahoe Village Properties, Inc., dated April 19, 1955, recorded July 30, 1959 in Book E-1 of Deeds, under File No. 14708, Douglas County, Nevada Records; thence, from said point of commencement, north 40.00 feet to a point on the northerly right-of-way line of Kingsbury Grade; thence, along the said northerly right-of-way line, North 88 degrees, 53 minutes, 34 seconds West, a distance of 545.64 feet, to the beginning of tangent curve to the left, having a central angle of 01 degrees, 31 minutes, 51 seconds and a radius of 1040.00 feet for a distance of 27.79 feet to the TRUE POINT OF BEGINNING; thence, continuing along said curve, being the northerly right-of-way of Kingsbury Grade (U.S. Highway 207), through a central angle 09 degrees, 48 minutes, 27 seconds, with a radius of 1040.00 feet, for a distance of 178.02 feet to a point, said point being the southwest corner of subject parcel; thence, leaving the northerly right-of-way of U.S. Highway 207, on a bearing of North 00 degrees, 48 minutes, 26 seconds East, for a distance of 180.07 feet to a point; thence North 01 degrees, 10 minutes, 20 seconds East, for a distance of 30.23 feet to a point, said point being the northwest corner of the subject parcel; thence South 88 degrees, 53 minutes, 34 seconds East, a distance of 100.00 feet along the north property line of the subject parcel; thence, North 00 degrees, 48 minutes, 26 seconds East a distance of 21.00 feet; thence, South 89 degrees, 11 minutes, 34 seconds East a distance of 141.50 feet to a point; thence, South 00 degrees, 48 minutes, 26 seconds West a distance of 91.40 feet, to a point; thence, South 39 degrees, 51 minutes, 25 seconds West a distance of 68.75 feet; thence on a curve to the left, through a central angle of 38 degrees, 44 minutes, 30 seconds, with a radius of 56.00 feet, for a distance of 37.87 feet to a point; thence, South 01 degree, 06 minutes, 55 seconds West a distance of 13.39 feet to a point, said point being a beginning of a curve to the right; thence, on a curve to the right, with a central angle of 51 degrees, 03 minutes, 19 seconds, with a radius of 24.00 feet, for a distance of 21.39 feet to the TRUE POINT OF BEGINNING,

Excepting there from a parcel within the above described parcel, said parcel within shall be described as followed:

Commencing at the northeast corner of the above described parcel, South 52 degrees, 01 minutes, 04 seconds West, a distance of 68.64 feet to the TRUE POINT OF BEGINNING; thence, South 00 degrees, 48 minutes, 26 seconds West, a distance of 60.00 feet, thence, North 88 degrees, 53 minutes, 34 seconds West, a distance of 100.00 feet, thence, North 00 degrees, 48 minutes, 26 seconds East, a distance of 60.00 feet, thence, South 88 degrees, 53 minutes, 34 seconds East, a distance of 100.00 feet to the TRUE POINT OF BEGINNING.

Said parcel contains an area of 39,522 square feet (0.907 acres), more or less.

Basis of Bearing for this description is Record of Survey, Book 1082, Page 629, Douglas County, Nevada Records.

PIN APN 07-130-040

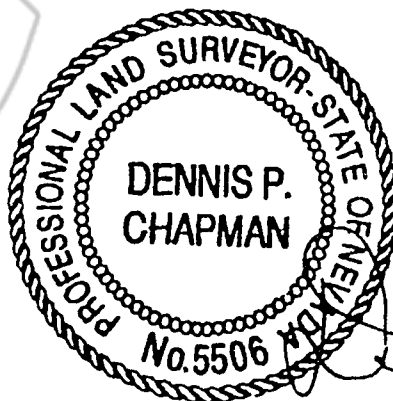

A handwritten signature in black ink, appearing to read "Dennis P. Chapman", written over the bottom right portion of the surveyor's seal.

COPY

REQUESTED BY
STEWART TITLE OF DOUGLAS COUNTY

IN OFFICIAL RECORDS OF
DOUGLAS CO., NEVADA

1999 SEP 24 PM 3: 08

LINDA SLATER
RECORDER

\$^{9.00} PAID *KJ* DEPUTY

0477457
BK0999PG4955