

EXHIBIT "A"

LEGAL DESCRIPTION

ESCROW NO.: 99021952

Unit 2 of Lot 23 Condominiums, as set forth on Sheet 7 of the Third Amended Map of Tahoe Village, Unit No. 2, filed for record August 14, 1979, as Document No. 35555, Official Records of Douglas County, State of Nevada.

TOGETHER WITH an undivided 1/18th interest in and to those areas designated as Common Areas as set forth on the map of Lot 23 Condominiums as set forth on Sheet 7 of the Third Amended Map of Tahoe Village Unit No. 2, filed for record August 14, 1979, as Document No. 35555, Official Records of Douglas County, State of Nevada.

Assessors Parcel No. 41-210-020

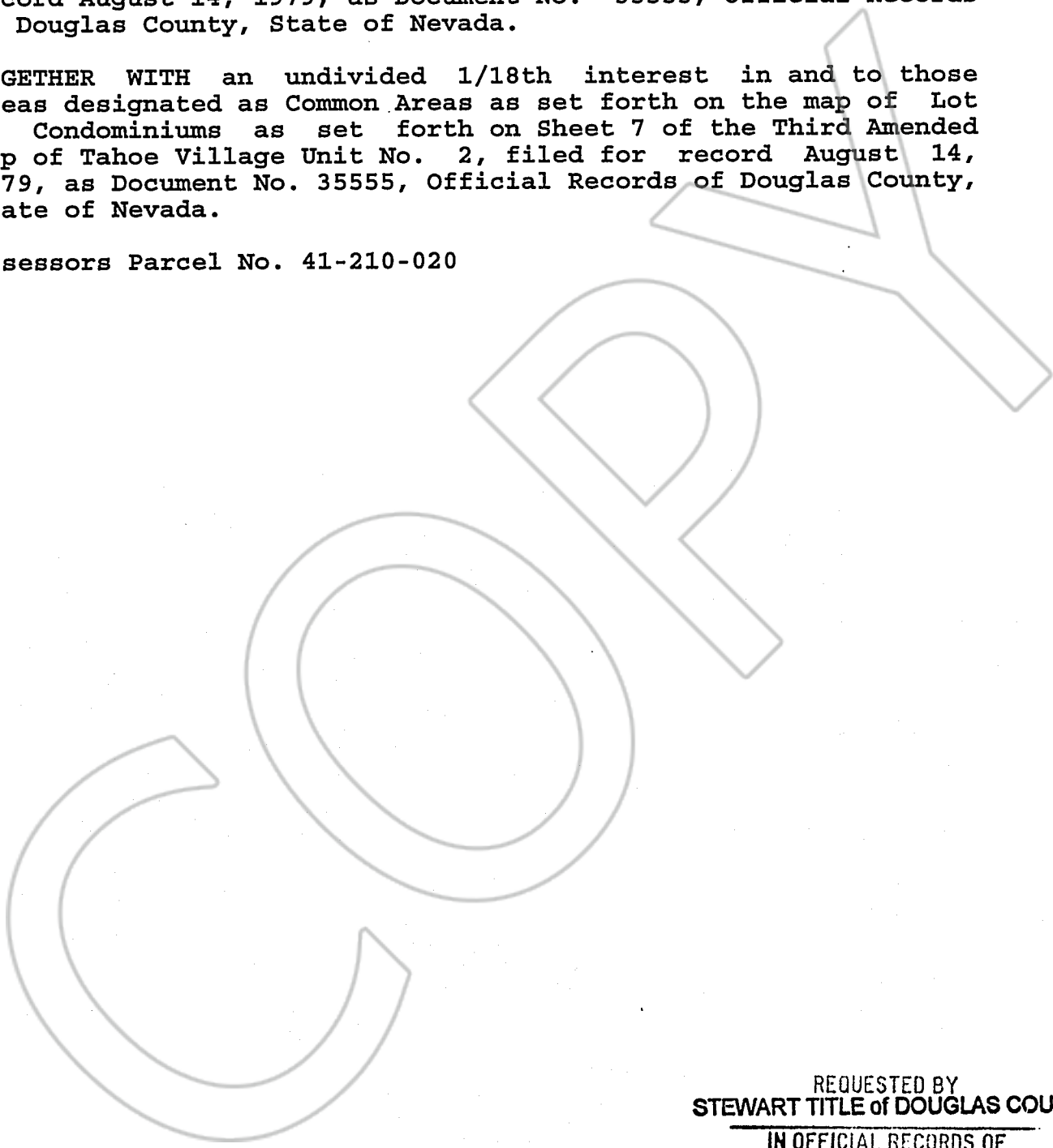

REQUESTED BY
STEWART TITLE OF DOUGLAS COUNTY

**IN OFFICIAL RECORDS OF
DOUGLAS CO., NEVADA**

1999 OCT -8 PM 4: 31

LINDA SLATER
RECORDER

\$^{8.00} PAID KA DEPUTY

0478409
BK1099PG1632